

NOTE:
 THE DIMENSIONS REPRESENT THE CONCRETE LAYOUTS AND MATERIALS AS APPROVED BY THE HOMEOWNER. THE DRAWINGS HAVE BEEN DONE TO THE BEST OF THE SURVEYOR'S KNOWLEDGE AND BELIEF. THE SURVEYOR'S RESPONSIBILITY IS TO VERIFY THE DIMENSIONS AND MATERIALS AS APPROVED BY THE HOMEOWNER. THE SURVEYOR'S RESPONSIBILITY IS NOT TO VERIFY THE DIMENSIONS AND MATERIALS AS APPROVED BY THE HOMEOWNER. THE SURVEYOR'S RESPONSIBILITY IS NOT TO VERIFY THE DIMENSIONS AND MATERIALS AS APPROVED BY THE HOMEOWNER. THE SURVEYOR'S RESPONSIBILITY IS NOT TO VERIFY THE DIMENSIONS AND MATERIALS AS APPROVED BY THE HOMEOWNER.

NOTE: AS ALLOWED BY FIC
 ELEMENTAL ZONING SECTION
 12-10.1, THE LOT COVERAGE IS
 PERMITTED TO BE EXCEEDED BY A
 PLATFORM ELEVATION OF ABOVE
 GRADE, PROVIDED THAT THE
 PLATFORM IS NOT USED FOR
 STORAGE OF VEHICLES OR
 STORAGE OF FLAMMABLE LIQUIDS
 OR GASES, AND THAT THE
 PLATFORM IS NOT USED FOR
 STORAGE OF HAZARDOUS
 MATERIALS OR WASTE.

LINE	BEARING	DISTANCE
L1	N. 41° 26' 39" W.	99.25'
L2	N. 48° 37' 13" W.	2.06'

Plan no.
 2021-36 A1.0

BLUWATER CONSTRUCTION LLC
 12345 Main Road
 Houston, TX 77001
 LICENSE # 0001500454
 941-332-2500

GC SIGNATURE

CUSTOM RESIDENCE FOR:
DILLON
 5850 GULF OF MEXICO DR,
 LONGBOAT KEY FL 34228
 PID: 7897600008

DRAFTING DESIGN
 8505 PONDERS AVE, SUITE C
 Springtown, TX 75781
 (817) 378-2007
 www.draftingdesign.com
 Dan E. Coulter, President

REVISIONS:

NO.	DESCRIPTION	BY	DATE
1	BLDG. / CON. / CLIENT CHANGES	JXC	12/23/22
2	BLDG. LOCATION	JXC	1/13/22

DATE: 12-23-2021
SCALE: AS SHOWN
SHEET TITLE:
 PARTIAL SITE PLAN AND
 LOT BUILDING, LOT
 COVERAGE,
 CALCULATIONS, GENERAL
 PLAN NOTES AND PLAN
 INDEX.
SHEET NO.
A1.1

RECEIVED
 AUG 05 2022
 TOWN OF LONGBOAT KEY
 Planning, Zoning & Building

PERMIT COPY OF RECORD

NOTE:
 THE CLIENT AND DRAWING APPROVER REPRESENT THE CONCEPT, LAYOUT AND MATERIALS AS APPROVED BY THE HOMEOWNER. THE DRAWINGS HAVE BEEN DONE TO THE BEST OF THE DRAFTER'S KNOWLEDGE. THE CLIENT AND DRAWING APPROVER SHALL BE RESPONSIBLE FOR THE APPLICABLE FLORIDA BUILDING CODES AND FIRE SAFETY STANDARDS AND ANY CONDITIONS WHICH APPEAR TO BE INCONGRUOUS SHALL BE BROUGHT TO THE LICENSED ARCHITECT, ENGINEER AND THE DESIGN CONSULTANT'S ATTENTION AND CORRECTED. THE GENERAL CONTRACTOR SHALL EXAMINE THE PLANS COMPLETELY AND ADVISE THE JOB SITE BEFORE BEGINNING CONSTRUCTION ON THIS PROJECT. THE GENERAL CONTRACTOR SHALL VERIFY ALL DIMENSIONS AND SPACING HEIGHTS. IT WILL ALSO BE THE GENERAL CONTRACTOR'S RESPONSIBILITY TO OBTAIN ALL NECESSARY PERMITS AND MEET ALL STATE AND LOCAL BUILDING CODES. ALL DIMENSIONS ARE TO BE BROUGHT TO THE ATTENTION OF THE ARCHITECT AND CHECKED BY THE ARCHITECT PRIOR TO CONSTRUCTION. THE GENERAL CONTRACTOR SHALL CHECK AND CORRECT ALL DIMENSIONS AND DETAILS PRIOR TO CONSTRUCTION. HOBBY DESIGNER OF ALL DISCREPANCIES CONTAINED HEREIN. THE GENERAL CONTRACTOR SHALL VERIFY ALL DIMENSIONS AND DETAILS PRIOR TO CONSTRUCTION. HOBBY DESIGNER OF ALL DISCREPANCIES CONTAINED HEREIN.

Plan no.
2021-36 A1.0

BLUEWATER CONSTRUCTION LLC
 126 19 RIVER ROAD
 WINDYBROOK CITY, FLORIDA 34231
 LICENSE # CC01806434
 941-322-2200
 GC SIGNATURE

CUSTOM RESIDENCE FOR:
DILLON
 5850 GULF OF MEXICO DR,
 LONGBOAT KEY FL 34228
 PID: 7897600008

JCD DRAFTING & DESIGN INC.
 9045 POWDER AVE. SUITE C
 SCARSDALE, FLORIDA 34222
 (813) 937-1111
 www.jcdraftinganddesign.com

REVISIONS:

NO.	DESCRIP.	BY	DATE
1	BLDG. CODE / CLIENT CHANGES	JIC	8/22/22
2	BLDG. LOCATION	JIC	8/13/22

DATE: 12-23-2021
SCALE: AS SHOWN

SHEET TITLE:
 PARTIAL SITE PLAN AND LOT BUILDING LOT COVERAGE CALCULATIONS, GENERAL PLAN, NOTES AND PLAN INDEX
SHEET NO.
A1.1

RECEIVED
 AUG 05 2022
 TOWN OF LONGBOAT KEY
 Planning, Zoning & Building Dept

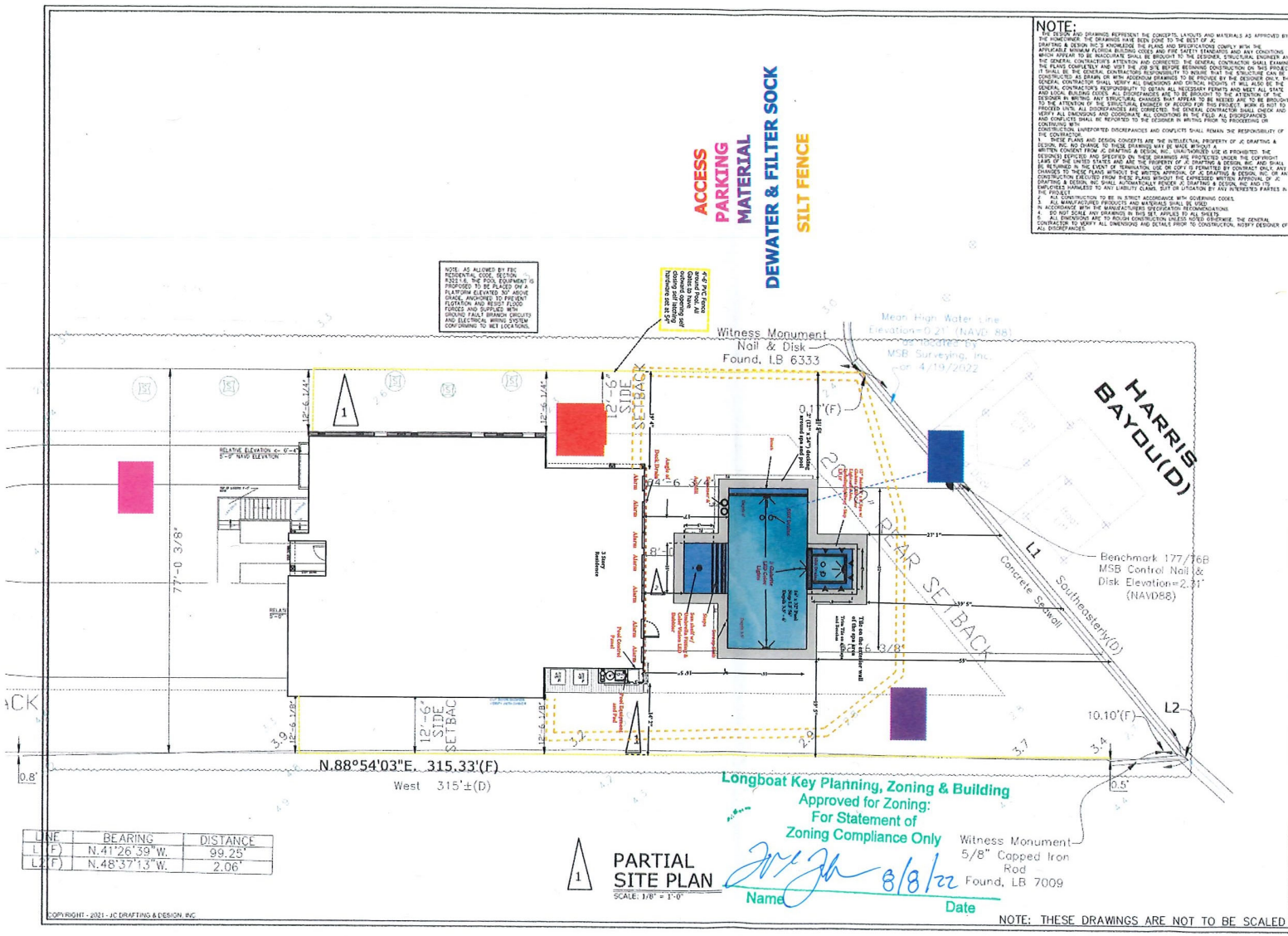

PARTIAL SITE PLAN
 SCALE: 1/8" = 1'-0"

Witness Monument
 5/8" Capped Iron Rod
 Found, LB 7009

Name: *[Signature]*
 Date: 8/8/22

Longboat Key Planning, Zoning & Building
 Approved for Zoning:
 For Statement of
 Zoning Compliance Only

LINE	BEARING	DISTANCE
L1 (E)	N.41°26'39" W.	99.25'
L2 (F)	N.48°37'13" W.	2.06'

NOTE: THESE DRAWINGS ARE NOT TO BE SCALED

COPYRIGHT - 2021 - JCD DRAFTING & DESIGN, INC.

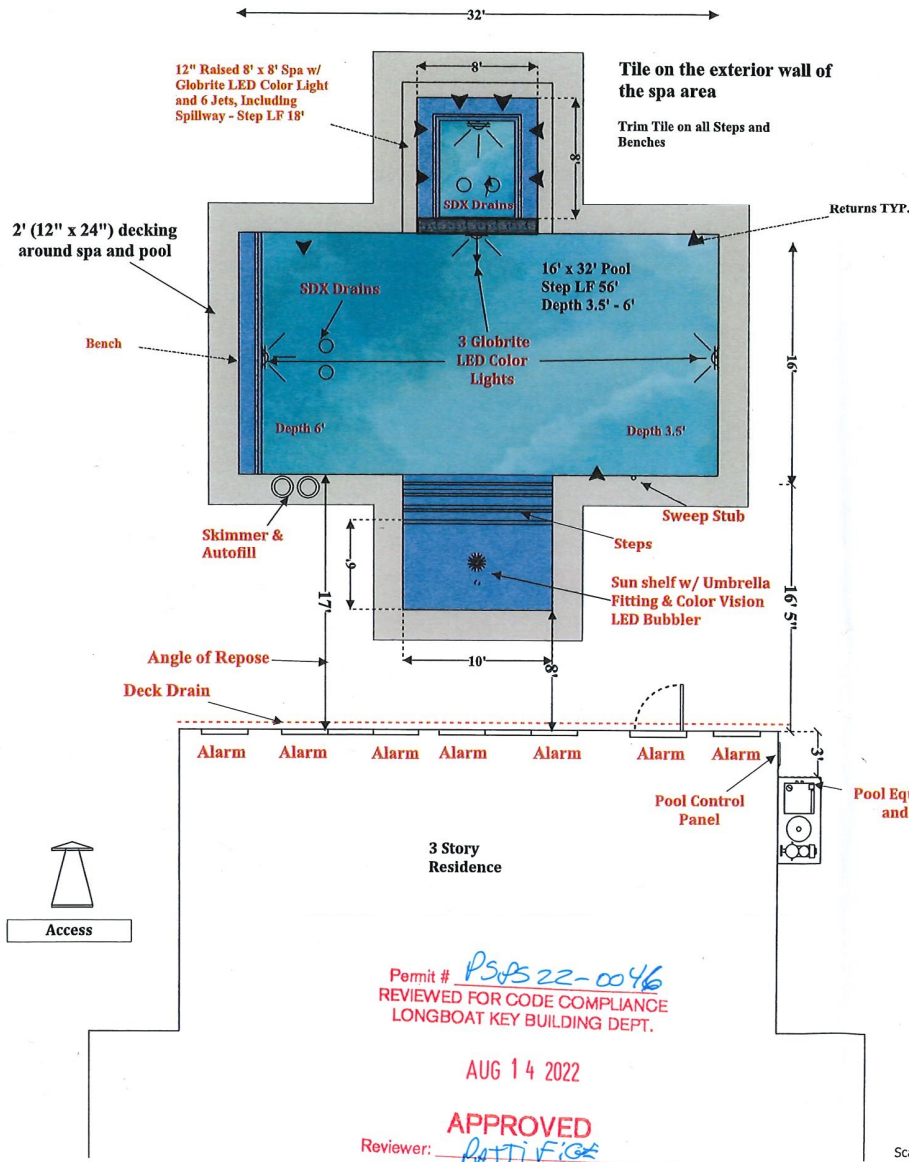

Permit # PS22-0046
 REVIEWED FOR CODE COMPLIANCE
 LONGBOAT KEY BUILDING DEPT.

AUG 14 2022

APPROVED
 Reviewer: PATTI FIGE

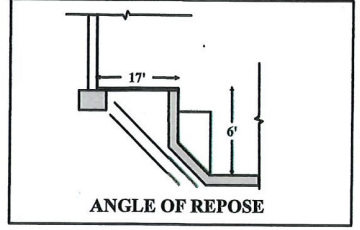
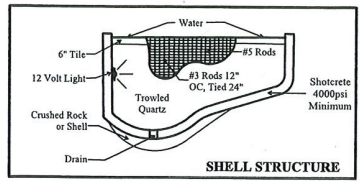

CHILD SAFETY ALARMS SHALL BE SYSTEM PREVIOUSLY APPROVED BY THE BLDG. DEPT., INSTALLED AND ACTIVE ON ALL DOORS AND WINDOWS AT TIME OF FINAL INSPECTION PURSUANT TO 424.2.17.1.9F.B.C.

SEWER SOURCE: CENTRAL
WATER SOURCE: CENTRAL

Trees that are existing and will remain will be protected with silt fence at drip line in pool construction area.

Paver Deck 12"x12" concrete footer with 2 #5 Rebar Treat soil with Cyper TC soil treatment

Sunshelf depth not to exceed 12" from the level of the deck

The Pentair GloBrite L.E.D. lights are nicheless lights

Scale: 1/8" = 1 ft



6010 Cortez Rd. W.
 Bradenton, FL 34210
 941-932-1414
 CPC-1458020

Designed by
 Suzie Payne

Date: 7/27/2022
 Revised

NAME: Johnson/Dillon Residence
 ADDRESS: 5950 Gulf of Mexico Dr
 CITY: Longboat Key STATE: FL
 PHONE: 610-457-6160 ZIP: 34228
 EMAIL: reneedillon66@aol.com
 CELL: 610-457-6160

POOL SPECS
 SIZE: 32' x 16' SQFT: 601
 DEPTH: 3'6" - 6' PERIMETER: 114'
 EST TOTAL GALLONS: 16,900 SKIMMERS: Yes 1
 RETURNS: 3 INTERIOR MATERIAL: Mini Pebble
 LIGHTS: 3 LED Globrite Color TILE LF: 114'
 SPECIAL: 1 Bubbler, 6' x 10' Sun Shelf
 NOTES:

SPA SPECS
 SIZE: 8' x 8' SQFT: 64
 DEPTH: 3' PERIMETER: 32'
 RAISED HEIGHT: 12' SPILLWAY: Open
 THERAPY JETS: 6 TILE LF: 112'
 SPECIAL: 1 LED Globrite Color
 NOTES:

DECK
 DECK TYPE: 12 x 24 Coping Only ELEVATION: Grade
 TOTAL DECK SQFT: 284' PERIMETER: 150'
 RAISED BEAM: No LIP STYLE:
 SPECIAL:
 NOTES: Homeowner will order and ship the material to the job site. Tom Sanger Pools to install only.

EQUIPMENT
 POOL PUMP: Pentair Intelliflo 2ND PUMP:
 FILTRATION: IC 40 FILTER SIZE: CC 200
 HEATER: MasterTemp 400K Gas INLINE: Sweep Stub
 TIMER: Easy Touch 4 Controller GAS: Yes
 SPECIAL: Screen Logic Gas:
 NOTES: Autofill
 Safety Feature: 7 battery powered alarms

Customer Signature _____ Date _____

RECEIVED
 AUG 05 2022
 TOWN OF LONGBOAT KEY
 Planning, Zoning & Building
 BLDG PERMIT PLANS
 FILE
 Copy of Record

PERMIT COPY OF RECORD

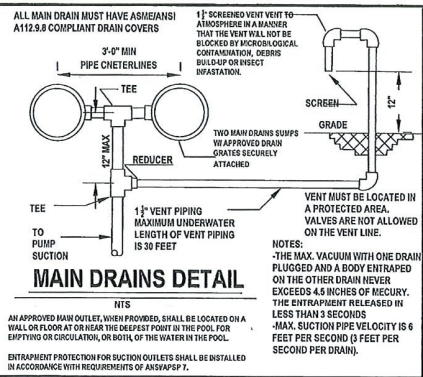

MAIN DRAINS DETAIL

ALL MAIN DRAIN MUST HAVE ASME/ANSI A112.9.8 COMPLIANT DRAIN COVERS

1 1/2" SCREENED VENT VENT TO ATMOSPHERE IN A MANNER THAT THE VENT SHALL NOT BE BLOCKED BY MICROBIOLOGICAL CONTAMINATION, DEBRIS, BUILD-UP OR INSECT INFESTATION.

3/4" MIN PIPE CENTERLINES

TEE

REDUCER

1 1/2" VENT PIPING MAXIMUM UNDERWATER LENGTH OF VENT PIPING IS 30 FEET

TO PUMP SUCTION

TWO MAIN DRAINS SUPPLY APPROVED DRAIN STRAINERS SECURELY ATTACHED

SCREEN

GRADE

VENT MUST BE LOCATED IN A PROTECTED AREA. VALVES ARE NOT ALLOWED ON THE VENT LINE.

NOTES:

- THE MAX. VACUUM ON ONE DRAIN PLUGGED AND A BODY ENTRAPPED ON THE OTHER DRAIN NEVER EXCEEDS 4.5 INCHES OF MERCURY. THE ENTRAPMENT IS RELEASED IN LESS THAN 3 SECONDS
- MAX. SUCTION PIPE VELOCITY IS 6 FEET PER SECOND (6 FEET PER SECOND PER DRAIN).

ENTRAPMENT PROTECTION FOR SUCTION OUTLETS SHALL BE INSTALLED IN ACCORDANCE WITH REQUIREMENTS OF ANSI/APSP 7.

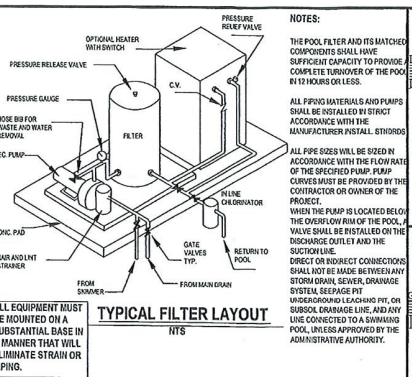

TYPICAL FILTER LAYOUT

NOTES:

- THE POOL FILTER AND ITS MATCHED COMPONENTS SHALL HAVE SUFFICIENT CAPACITY TO PROVIDE COMPLETE TURNOVER OF THE POOL IN 12 HOURS OR LESS.
- ALL PIPING MATERIALS AND PUMPS SHALL BE INSTALLED BY STRICT ACCORDANCE WITH THE MANUFACTURER'S INSTRUCTIONS.
- ALL PIPE SIZES WILL BE SIZED IN ACCORDANCE WITH THE FLOW RATE OF THE SPECIFIED PUMP. PUMP CAPACITY MUST BE PROVIDED BY THE CONTRACTOR OR LOCATED ON THE PROJECT.
- WHEN THE PUMP IS LOCATED BELOW THE OVERFLOW RIM OF THE POOL, A VALVE SHALL BE INSTALLED ON THE DISCHARGE OUTLET AND THE SUCTION LINE.
- DIRECT OR INDIRECT CONNECTIONS SHALL NOT BE MADE BETWEEN ANY STORAGE TANK, SCHEER, DRAINAGE SYSTEM, SEWAGE PIT, UNDERGROUND LEACHING PIT, OR SUBSOIL DRAINAGE LINE AND ANY LINE CONNECTED TO A SWIMMING POOL, UNLESS APPROVED BY THE ADMINISTRATIVE AUTHORITY.

ALL EQUIPMENT MUST BE MOUNTED ON A SUBSTANTIAL BASE IN A MANNER THAT WILL ELIMINATE STRAIN OR PIPING.

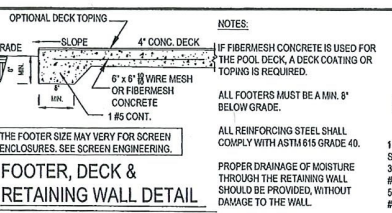

FOOTER, DECK & RETAINING WALL DETAIL

NOTES:

- IF FIBERGLASS CONCRETE IS USED FOR THE POOL DECK, A DECK COATING OR TOPPING IS REQUIRED.
- ALL FOOTERS MUST BE A MIN. 6" BELOW GRADE.
- ALL REINFORCING STEEL SHALL COMPLY WITH ASTM 615 GRADE 40.
- PROPER DRAINAGE OF MOISTURE THROUGH THE RETAINING WALL SHOULD BE PROVIDED, WITHOUT DAMAGE TO THE WALL.

OPTIONAL DECK TOPPING

GRADE

SLOPE

4" CONC. DECK

6" x 6" WIRE MESH OR FIBERGLASS CONCRETE

1.5" CONT.

THE FOOTER SIZE MAY VARY FOR SCREEN ENCLOSURES. SEE SCREEN ENGINEERING.

FOOTER, DECK & RETAINING WALL DETAIL

NTS

ALL CONCRETE SHALL HAVE A MIN. COMPRESSIVE STRENGTH OF 3,000 P.S.I.

4" CONC. DECK

COPING

6" x 6" TILE

6" MIN WALLS

WATER LEVEL

4" x 6"

8" x 8" WIRE MESH OR FIBERGLASS CONCRETE

BONDING WIRE

MAX. FLOOR SLOPE 1" IN 8"

HYDROSTATIC RELIEF VALVE

2 MAIN DRAINS WITH APPROVED ASME/ANSI COVERS SECURELY ATTACHED

POOL WALL & STEER MAY BE EXTENDED TO 2" BELOW GRADE

8" x 8" FOOTER WITH ONE #5 BAR CONT.

2-85 CONT.

EXTEND STEEL 8" INTO DECK

1 FROM ANY BEARING (RAPE CORAL)

GRADE

1.4 SLOPE

1 TO 2 COURSES HIGH, NO VERT. STEEL REQUIRED.

3 TO 4 COURSES HIGH ONE #5 VERT. BAR 48" O.C. IN FILLED CELL

5 TO 7 COURSES HIGH ONE #5 VERT. BAR 24" O.C. IN FILLED CELL

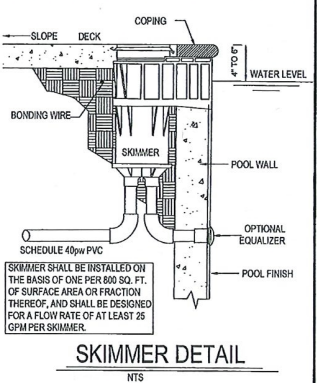

SKIMMER DETAIL

SKIMMER SHALL BE INSTALLED ON THE BASIS OF ONE PER 800 SQ. FT. OF SURFACE AREA OR FRACTION THEREOF, AND SHALL BE DESIGNED FOR A FLOW RATE OF AT LEAST 25 GPM PER SKIMMER.

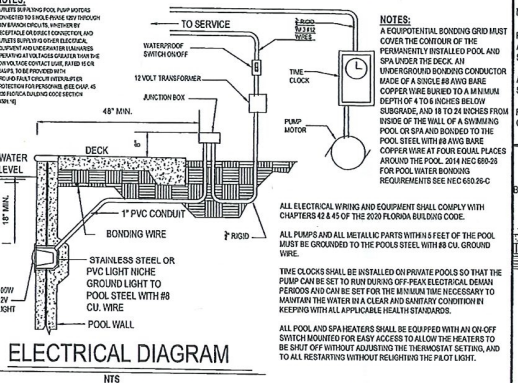

ELECTRICAL DIAGRAM

NOTES:

- A EQUIPMENTAL BONDING GRID MUST COVER THE CORNER OF THE PERMANENTLY INSTALLED POOL AND SPAN UNDER THE DECK.
- UNDERGROUND UNDERGROUND CONDUCTOR MADE OF A SINGLE #8 AWG BARE COPPER WIRE BURIED TO A MINIMUM DEPTH OF 4" OR NEARER BELOW SUBGRADE, AND 18 TO 24 INCHES FROM EDGE OF THE TRAIL, TO BE INSTALLED AROUND THE PERIMETER OF THE POOL, OR SPA AND BONDED TO THE POOL. WATER BONDING REQUIREMENTS SEE NEC 680.26-C
- ALL ELECTRICAL WIRING AND EQUIPMENT SHALL COMPLY WITH CHAPTERS 41 & 45 OF THE 2020 FLORIDA BUILDING CODE.
- ALL PUMPS AND ALL METALLIC PARTS WITHIN 5 FEET OF THE POOL MUST BE BONDED TO THE POOL STEEL WITH #4 COPPER WIRE.
- TIME CLOCKS SHALL BE INSTALLED ON PRIVATE POOLS SO THAT THE PUMP CAN BE SET TO RUN DURING OFF-PEAK ELECTRICAL DEMAND PERIODS AND CAN BE SET FOR THE MINIMUM TIME NECESSARY TO MAINTAIN THE WATER IN A CLEAR AND SANITARY CONDITION IN KEEPING WITH ALL APPLICABLE HEALTH STANDARDS.
- ALL POOL AND SPAN HEATERS SHALL BE EQUIPPED WITH AN ON/OFF SWITCH MOUNTED FOR EASY ACCESS TO ALLOW THE HEATERS TO BE SHUT OFF WITHOUT ADJUSTING THE THERMOSTAT SETTING, AND TO ALL RESISTING WITHOUT REQUIRING THE PLUMBING.

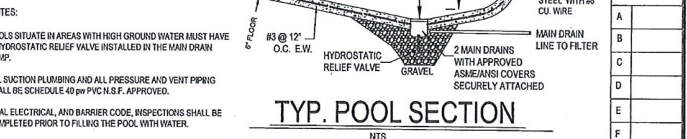

TYP. POOL SECTION

NOTES:

- POOLS SITUATE IN AREAS WITH HIGH GROUND WATER MUST HAVE A HYDROSTATIC RELIEF VALVE INSTALLED IN THE MAIN DRAIN SUMPS.
- ALL SUCTION PLUMBING AND ALL PRESSURE AND VENT PIPING SHALL BE SCHEDULE 40 PIPE PVC U.S.F. APPROVED.
- FINAL ELECTRICAL AND BARRIER CODE, INSPECTIONS SHALL BE COMPLETED PRIOR TO FILLING THE POOL WITH WATER.

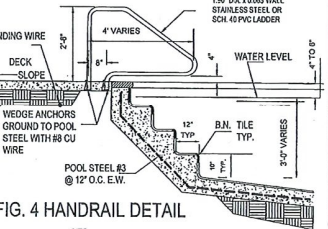
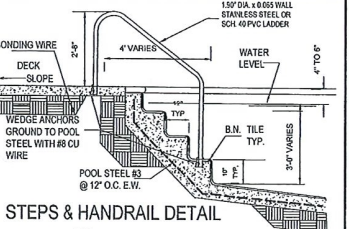
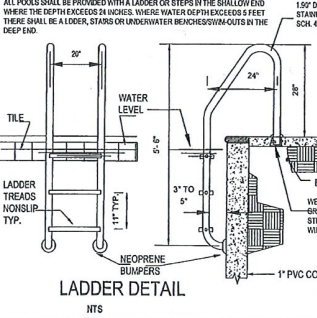

FIG. 4 HANDRAIL DETAIL



STEPS & HANDRAIL DETAIL



LADDER DETAIL

ALL POOLS SHALL BE PROVIDED WITH A LADDER OR STEPS IN THE SHALLOW END WHERE THE DEPTH EXCEEDS 9 INCHES, WITH A WATER DEPTH OF 5 FEET OR MORE THERE SHALL BE A LADDER, STAIRS OR UNDERWATER BENCHES/SWIM-OUTS IN THE DEEP END.

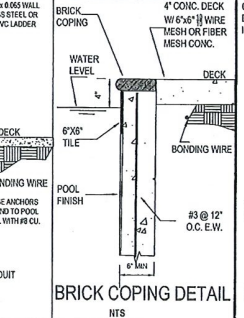

BRICK COPING DETAIL

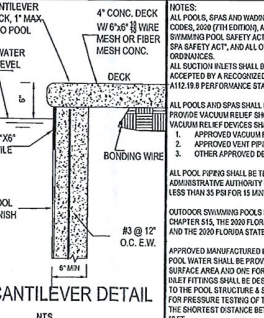

CANTILEVER DETAIL

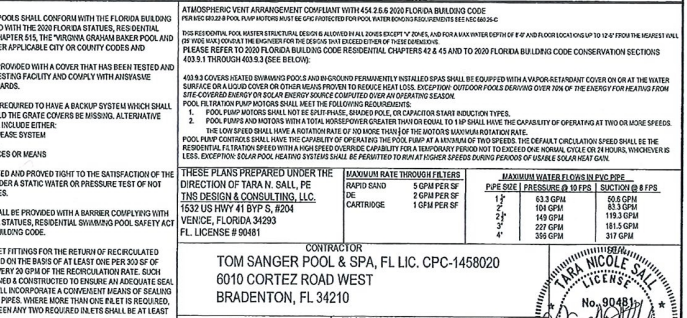

NOTES:

- ALL POOL, SPA, AND WADING POOLS SHALL COMPLY WITH THE FLORIDA BUILDING CODES, 2020 (IF APPLICABLE), ALSO WITH THE 2020 FLORIDA STATUTES, RESIDENTIAL SWIMMING POOL SAFETY ACT CHAPTER 515, THE "VIRGINIA GRAMM BAKER POOL AND SPA SAFETY ACT," AND ALL OTHER APPLICABLE CITY OR COUNTY CODES AND ORDINANCES.
- ALL SUCTION INLETS SHALL BE PROVIDED WITH A COVER THAT HAS BEEN TESTED AND ACCEPTED BY A RECOGNIZED TESTING FACILITY AND COVERS WITH AREA TESTED: A112.9.8 PERFORMANCE STANDARDS.
- ALL POOLS AND SPAS SHALL BE REQUIRED TO HAVE A BACKUP SYSTEM WHICH SHALL PROVIDE VACUUM RELIEF SHOULD THE GRATE COVERS BE MISSING. ALTERNATIVE VACUUM RELIEF DEVICES SHALL INCLUDE EITHER:
 - APPROVED VACUUM RELEASE SYSTEM
 - APPROVED VENT PIPING
 - OTHER APPROVED DEVICES OR MEANS
- ALL POOL PIPING SHALL BE TESTED AND PROVED TIGHT TO THE SATISFACTION OF THE ADMINISTRATIVE AUTHORITY UNDER A STATIC WATER OR PRESSURE TEST OF NOT LESS THAN 35 PSF FOR 15 MINUTES.
- OUTDOOR SWIMMING POOLS SHALL BE PROVIDED WITH A BARRIER COMPLYING WITH CHAPTER 515, THE 2020 FLORIDA STATUTES, RESIDENTIAL SWIMMING POOL SAFETY ACT AND THE 2020 FLORIDA STATE BUILDING CODE.
- APPROVED MANUFACTURED PALET FITTINGS FOR THE RETURN OF RECIRCULATED POOL WATER SHALL BE PROVIDED ON THE BASIS OF AT LEAST ONE PER 300 SF OF SURFACE AREA AND ONE FOR EVERY 20 GPM OF THE RECIRCULATION RATE. SUCH PALET FITTINGS SHALL BE DESIGNED & CONSTRUCTED TO ENSURE AN ADEQUATE SEAL TO THE POOL STRUCTURE & SHALL INCORPORATE A CONVEYANT MEANS OF SEALING FOR PRESSURE TESTING OF THE PIPES, WHERE MORE THAN ONE PALET IS REQUIRED, THE ENHANCED DISTANCE BETWEEN ANY TWO REQUIRED INLETS SHALL BE AT LEAST 10 FT.
- PERSON, CONSTRUCTION AND WORKMANSHIP SHALL BE IN CONFORMANCE WITH THE REQUIREMENTS OF SWIMMING POOL SAFETY FOR RESIDENTIAL SWIMMING POOLS PUBLISHED BY THE NATIONAL SPA & POOL INSTITUTE (NSPI) OR OTHER ACCEPTED ENGINEERING PRACTICES.
- ALL MATERIALS, PIPING, VALVES, EQUIPMENT OR APPLIANCES ENTERING INTO THE CONSTRUCTION OF SWIMMING POOLS OR PORTIONS THEREOF SHALL BE A TYPE THAT COMPLES WITH BUILDING CODE OR OF A TYPE RECOMMENDED AND APPROVED BY A NATIONAL RECOGNIZED TESTING AGENCY OR CONFORMS TO OTHER ACCEPTED STANDARDS ACCEPTABLE TO THE ADMINISTRATIVE AUTHORITY.

THE ENGINEER SHALL NOT BE HELD LIABLE FOR 1.) FAULTY MATERIALS AND CONSTRUCTION, 2.) INADEQUATE OR IMPROPER SUPERVISION OF CONSTRUCTION, 3.) IMPROPER POOL MAINTENANCE AFTER CONSTRUCTION, 4.) HYDROSTATIC UPLIFT OF THE POOL.

THESE PLANS ARE FOR RESIDENTIAL POOLS ONLY AND THEY MAY NOT BE USED FOR ANY COMMERCIAL POOL OR COMMERCIAL EXEMPT POOL. NO OTHER BUILDER MAY USE THESE PLANS WITHOUT THE WRITTEN CONSENT FROM THE BUILDER AND TNS DESIGN & CONSULTING, LLC.

TNS
Design & Consulting
BEYOND THE EXPECTED

TNS DESIGN & CONSULTING, LLC
1532 US HWY 41 BYP S #204
VENICE, FL 34293
PHONE 941.586.0142
TARA@TNSDESIGNANDCONSULTING.COM
TARA N. SALL,
FLORIDA PE LICENSE NO. 90481

CONTRACTOR
TOM SANGER POOL & SPA, FL, LIC. CPC-1458020
6010 CORTEZ ROAD WEST
BORTON, FL 34210

MUNICIPALITY
Longboat
Key

THESE PLANS MAY NOT BE REPRODUCED OR COPIED WITHOUT WRITTEN PERMISSION FROM TNS DESIGN & CONSULTING

DRAWING NAME:
RESIDENTIAL POOL MASTER

SCALE: NTS
DRAWN BY: TNS
CHECKED BY: TNS
DATE: 1.21.2022

FILE NAME:
MASTERRP2022

SHEET 1 OF 1

PROFESSIONAL ENGINEER
No. 90481
TARA N. SALL
FLORIDA PE LICENSE NO. 90481

RECEIVED
AUG 05 2022
TNS DESIGN & CONSULTING, LLC
PERMIT COPY OF RECORD

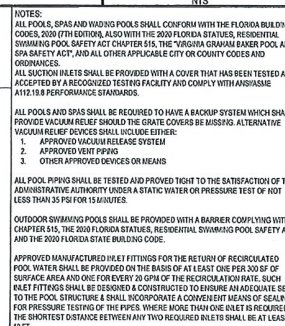
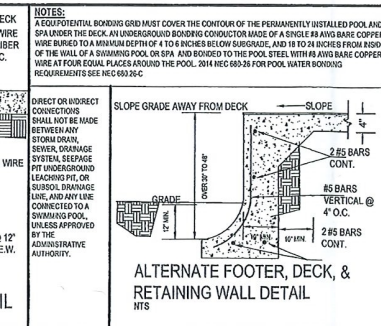
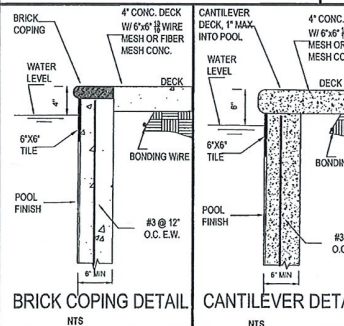
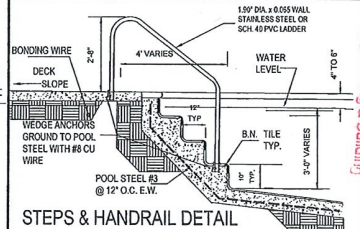
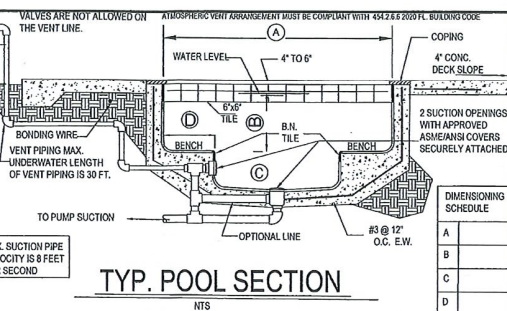
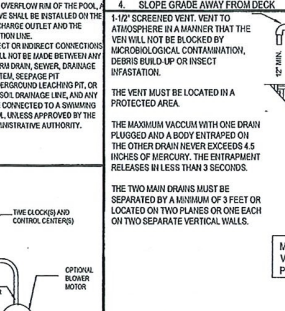
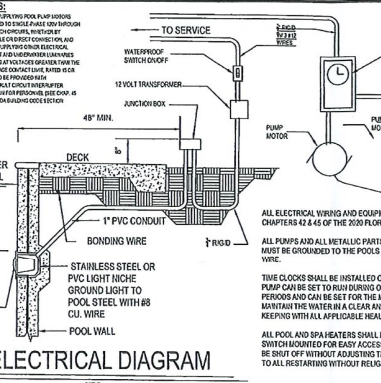
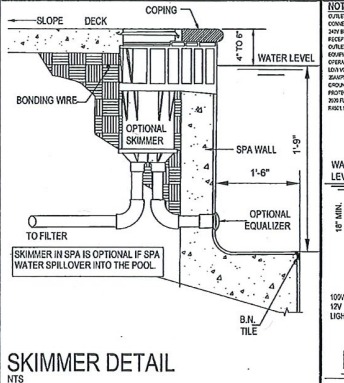
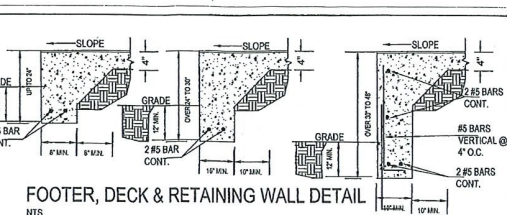
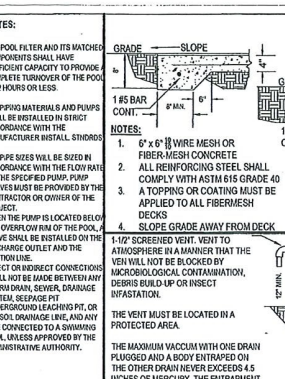
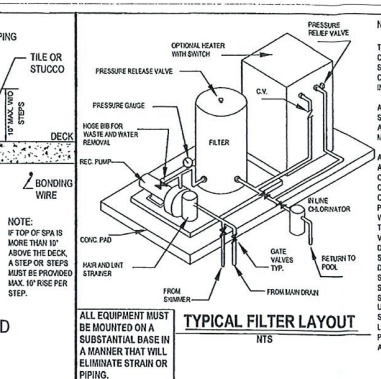
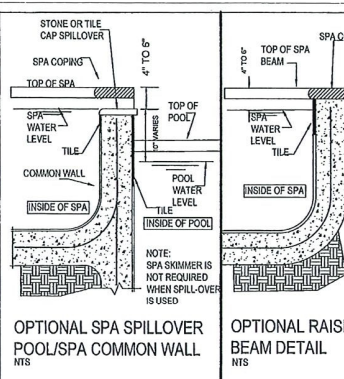

ATMOSPHERIC VENT ARRANGEMENT COMPLIANT WITH 452.2 & 2020 FLORIDA BUILDING CODE
1.5" DIA. x 0.055 WALL STAINLESS STEEL OR SCH. 40 PVC LADDER
BONDING WIRE
DECK SLOPE
WATER LEVEL
4" VARIES
WEDGE ANCHORS GROUND TO POOL STEEL WITH #8 CU WIRE
POOL STEEL #3 @ 12" O.C. E.W.

FIG. 4 HANDRAIL DETAIL
NTS

ROD/GRID	MAXIMUM RATE THROUGH FILTERS	MAXIMUM WATER FLOWS IN PVC PIPE	SLUGFLOW @ 8" PPS
2" GPM PER SF	TYPE SIZE	PRESSURE @ 10 FPS	SLUGFLOW @ 8" PPS
1"	1"	3.3 GPM	511 GPM
2"	2"	104 GPM	833 GPM
3"	3"	140 GPM	1151 GPM
4"	4"	227 GPM	1815 GPM
	4"	359 GPM	517 GPM

THE ENGINEER SHALL NOT BE HELD LIABLE FOR 1) FAULTY MATERIALS AND CONSTRUCTION, 2) INADEQUATE OR IMPROPER SUPERVISION OF CONSTRUCTION, 3) IMPROPER POOL MAINTENANCE AFTER CONSTRUCTION, 4) HYDROSTATIC UPLIFT OF THE POOL.
THESE PLANS ARE FOR RESIDENTIAL POOLS ONLY AND THEY MAY NOT BE USED FOR ANY COMMERCIAL POOL OR COMMERCIAL EXEMPT POOL.
THESE PLANS ARE FOR THE EXPLICIT USE FOR THE BUILDER NAMED. NO OTHER BUILDER MAY USE THESE PLANS WITHOUT THE WRITTEN CONSENT FROM THE BUILDER AND TNS DESIGN & CONSULTING, LLC.

TNS Design & Consulting
BEYOND THE EXPECTED

TNS DESIGN & CONSULTING, LLC
1532 US HWY 41 BYP S #204
VENICE, FL 34293
PHONE 941.586.0142
TNS@TNSDESIGNANDCONSULTING.COM
TARA N. SALL
FLORIDA PE LICENSE NO. 90481

APPROVED MANUFACTURED INLET FITTINGS FOR THE RETURN OF RECIRCULATED POOL WATER SHALL BE PROVIDED ON THE BASIS OF AT LEAST ONE PER 300 SF OF SURFACE AREA AND ONE FOR EVERY 20 GPM OF THE RECIRCULATION RATE. SUCH FITTING FITTINGS SHALL BE DESIGNED OR CONSTRUCTED TO ENSURE AN ADEQUATE SEAL TO THE POOL STRUCTURE & SHALL INCORPORATE A CONVENIENT MEANS OF SEALING FOR PRESSURE TESTING OF THE FITTINGS WHERE MORE THAN ONE IS SET IN THE CLOSEST DISTANCE BETWEEN ANY TWO REQUIRED FITTINGS SHALL BE AT LEAST 10 FT.
DESIGN, CONSTRUCTION AND WORKMANSHIP SHALL BE IN ACCORDANCE WITH THE REQUIREMENTS OF ANSHPSP STANDARD FOR RESIDENTIAL SWIMMING POOLS* PUBLISHED BY THE NATIONAL SPA & POOL INSTITUTE (NSPI) OR OTHER ACCEPTED ENGINEERING PRACTICES.
ALL MATERIALS, PIPING, VALVES, EQUIPMENT OR APPLIANCES ENTERING INTO THE CONSTRUCTION OF SWIMMING POOLS OR PORTIONS THEREOF SHALL BE A TYPE THAT COMPLIES WITH THE NATIONAL SPA & POOL INSTITUTE (NSPI) OR OTHER ACCEPTED ENGINEERING PRACTICES OR CONFORMS TO OTHER RECOGNIZED STANDARDS ACCEPTABLE TO THE ADMINISTRATIVE AUTHORITY.

CONTRACTOR
TOM SANGER POOL & SPA, FL LIC. CPC-1458020
6010 CORTEZ ROAD WEST
BRADENTON, FL 34210

MUNICIPALITY
Longboat
Key

THESE PLANS MAY NOT BE REPRODUCED OR COPIED WITHOUT WRITTEN PERMISSION FROM TNS DESIGN & CONSULTING

DRAWING NAME:
RESIDENTIAL SPA MASTER

SCALE: NTS
DRAWN BY: TNS
CHECKED BY: TNS
DATE: 1.21.2022

DRAWING NAME:
MASTERSpa2021-01
SHEET 1 OF 1

TARA N. SALL
FLORIDA PE LICENSE # 90481
PROFESSIONAL ENGINEER

RECEIVED
AUG 05 2022
TOWN OF LONGBOAT KEY
Permit Copy of Record

THIS SPACE INTENTIONALLY LEFT BLANK

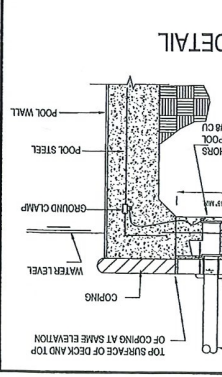
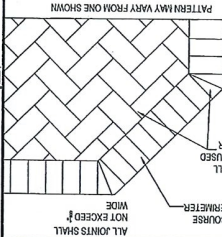
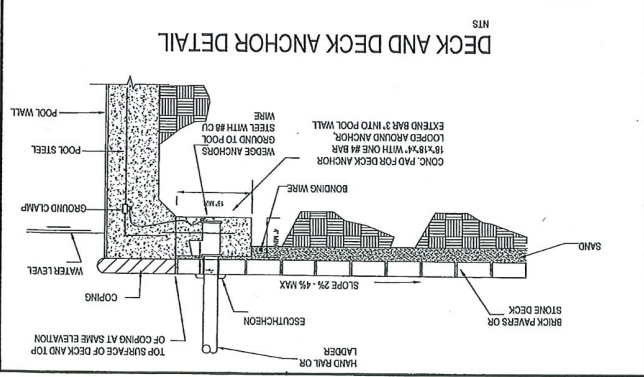
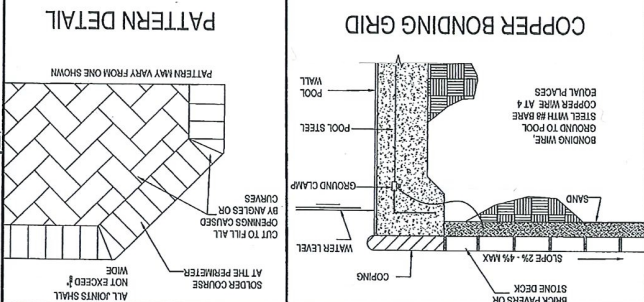
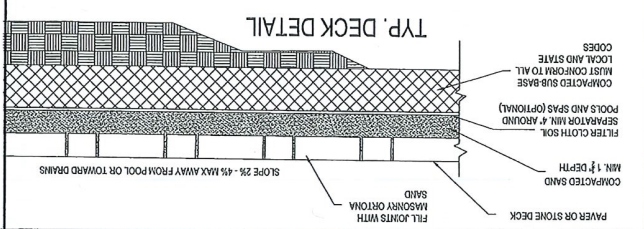

TNS DESIGN & CONSULTING, LLC
 1532 US HWY 41 BYP S #204
 VENICE, FL 34293
 PHONE 941.586.0142
 TNS@TNSDESIGNANDCONSULTING.COM
 TNSA N. SALL
 FLORIDA PE LICENSE NO. 90481
Beyond the Expected

THESE PLANS ARE FOR THE RESIDENTIAL POOL'S ONLY AND THEY MAY NOT BE USED FOR ANY COMMERCIAL POOL OR COMMERCIALLY RELATED POOL. NO OTHER BUILDERS MAY USE THESE PLANS WITHOUT THE WRITTEN CONSENT FROM THE ARCHITECT AND TNS DESIGN & CONSULTING, LLC.

THE ENGINEER SHALL NOT BE HELD LIABLE FOR 1) FAULTY MATERIALS AND CONSTRUCTION, 2) INADEQUATE OR IMPROPER SUPERVISION OF CONSTRUCTION, 3) IMPROPER POOL MAINTENANCE AFTER CONSTRUCTION, 4) HYDROSTATIC UPRIFT OF THE POOL.

THESE PLANS ARE FOR THE RESIDENTIAL POOL'S ONLY AND THEY MAY NOT BE USED FOR ANY COMMERCIAL POOL OR COMMERCIALLY RELATED POOL. NO OTHER BUILDERS MAY USE THESE PLANS WITHOUT THE WRITTEN CONSENT FROM THE ARCHITECT AND TNS DESIGN & CONSULTING, LLC.

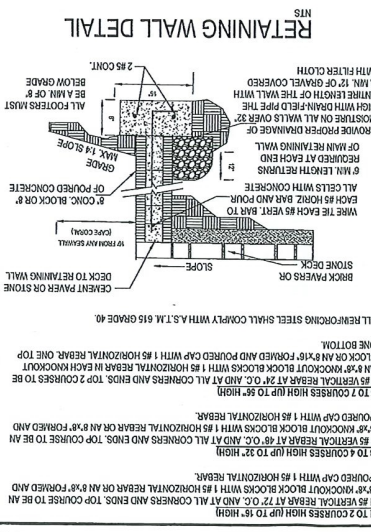

MASTER PAVES OR STONE DECK
 DRAWING NAME: MASTER PAVES OR STONE DECK
 DRAWING NO: 2022-01
 DATE: 1.21.2022
 SHEET 1 OF 1

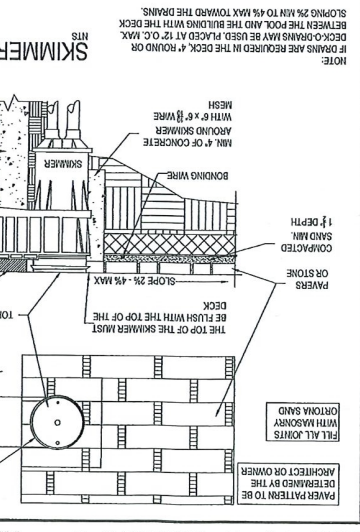
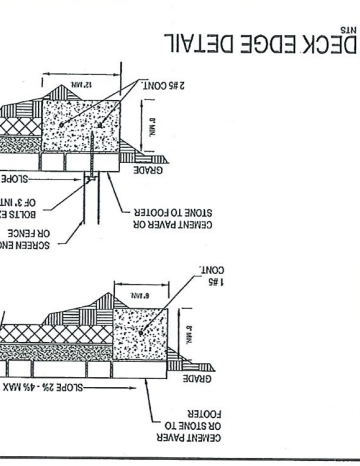

DECK EDGE DETAIL
 NOTE: SCREEN ENCLOSURE OR FENCE, BOULTS EXTERNA MIN OF 3\"/>

SKIMMER DETAIL
 NOTE: REPAIRS ARE REQUIRED IN THE DECK 4\"/>

RECEIVED
 AUG 05 2022
 TOWN OF LONGBOAT KEY
 Planning, Zoning & Building

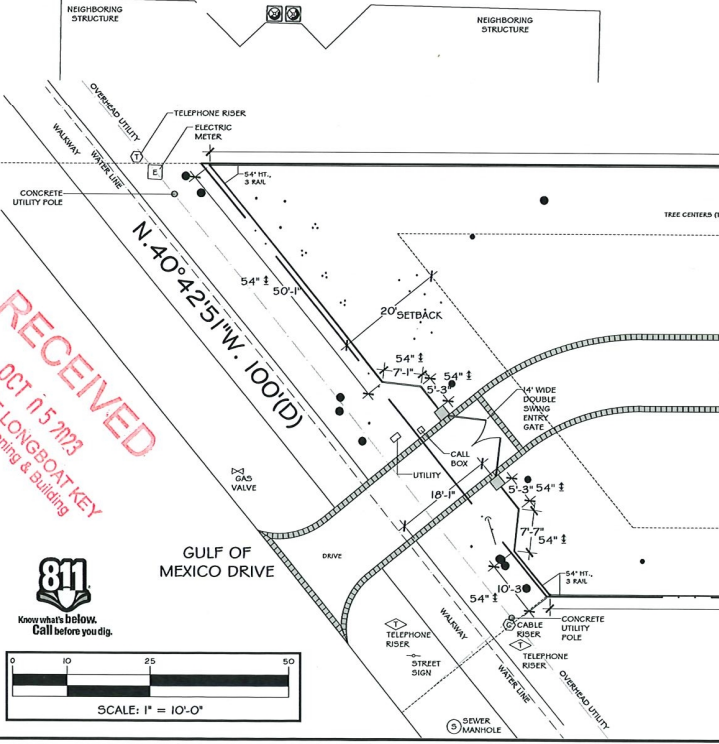
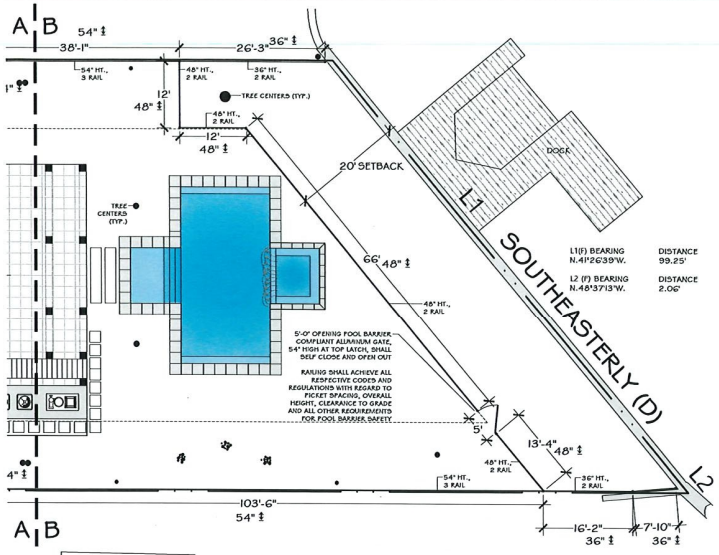

MASTER HALCO 2-RAIL PANEL

STYLE: INDEPENDENCE
COLOR: BLACK
HEIGHT: 36" AND 48"
1" X 1" RAILS
5/8" X 5/8" SQUARE PICKETS
12" X 2" SQUARE PICKETS
6" WIDE PANELS — RACKABILITY UP TO 36"
SIMPLE AND SLEEK, PROVIDING PROTECTION FOR ANY OUTDOOR SPACE

MASTER HALCO 2-RAIL GATE

QUANTITY: 1
STYLE: INDEPENDENCE
COLOR: BLACK
TOP STAYBOLTS
HEIGHT: 48" WITH MAGNALATCH EXTENSION (SEE DETAIL)
1" X 1" RAILS
5/8" X 5/8" SQUARE PICKETS
12" X 2" SQUARE PICKETS
6" WIDE PANELS — RACKABILITY UP TO 36"
SIMPLE AND SLEEK, PROVIDING PROTECTION FOR ANY OUTDOOR SPACE

MASTER HALCO 3-RAIL PANEL

STYLE: INDEPENDENCE
COLOR: BLACK
HEIGHT: 54"
1" X 1" RAILS
5/8" X 5/8" SQUARE PICKETS
12" X 2" SQUARE PICKETS
6" WIDE PANELS — RACKABILITY UP TO 36"
SIMPLE AND SLEEK, PROVIDING PROTECTION FOR ANY OUTDOOR SPACE

MASTER HALCO 3-RAIL GATE

QUANTITY: 2
STYLE: INDEPENDENCE
COLOR: BLACK
TOP ARCHED
HEIGHT: 54" WITH MAGNALATCH EXTENSION (SEE DETAIL)
1" X 1" RAILS
5/8" X 5/8" SQUARE PICKETS
12" X 2" SQUARE PICKETS
6" WIDE PANELS — RACKABILITY UP TO 36"
SIMPLE AND SLEEK, PROVIDING PROTECTION FOR ANY OUTDOOR SPACE

MASTER HALCO POOL FENCING NOTES:

SELECT STYLES AND HEIGHTS OF ALUMINUM OR COMPATIBLE ALUMINUM GATE, 54" HIGH AT TOP LATCH, SHALL SELF CLOSE AND OPEN OUT

RAILS SHALL ACHIEVE ALL RESPECTIVE CODES AND REGULATIONS WITH REGARD TO PICKET SPACING, OVERALL HEIGHT, CLEARANCE TO GRADE AND ALL OTHER REQUIREMENTS FOR POOL BARRIER SAFETY

POOL PANEL SPECIFICATIONS:

FENCE PANEL MUST BE AT LEAST 48" TALL

DISTANCE FROM THE TOP OF THE BOTTOM RAIL TO THE TOP OF THE NEXT HIGHEST RAIL MUST BE AT LEAST 45"

SPACING BETWEEN PICKETS MUST BE LESS THAN 4"

SPACE FROM THE BOTTOM OF THE BOTTOM RAIL OR PICKET SHOULD BE 2" OFF THE GROUND

POOL GATE SPECIFICATIONS:

MUST HAVE SELF-CLOSING HINGES AND SELF-CLOSING LATCHES

MUST NOT OPEN OUT TOWARD POOL AREA

OPENING MECHANISM OF THE LATCH MUST BE AT LEAST 54" ABOVE THE GROUND

MUST NOT USE A CROSS BRACE ON GATES

GATE LATCHING NOTE:

STYLE: MAGNALATCH SERIES 3 OR MAGNALATCH ALERT (TO BE DETERMINED)

MASTER HALCO FENCE AND GATE QUANTITIES:

FENCE:		
54" TALL 3 RAIL	674 LINEAR FEET	
48" TALL 2 RAIL	304 LINEAR FEET	
36" TALL 2 RAIL	51 LINEAR FEET	
GATE:		
60" TALL 3 RAIL	2 PIECES	
48" TALL 2 RAIL	1 PIECE	
UP TO 12" TALL 3 RAIL	OR 14" WIDE DOUBLE (TWO 7' WIDE)	
LATCH:		
MAGNALATCH SERIES 3 OR MAGNALATCH ALERT	3 PIECES	

MASTER HALCO WALK GATE AND DRIVE GATE NOTES:

STYLE: INDEPENDENCE
COLOR: BLACK

SINGLE SWING WALK GATES

- FULLY WELDED AND REINFORCED CORNERS FOR UNPARALLELED STRENGTH AND DURABILITY
- ARCHED WALK GATES
- DOUBLE SWING DRIVE GATES

ARCHED DOUBLE DRIVE GATES THAT MATCH YOUR FENCE, ADD STYLE, AND PROVIDE SECURITY FOR SINGLE-CAR AND TWO-CAR DRIVEWAYS.

4" AIR GAP PICKETS

14" FT OPENING

FULLY WELDED AND REINFORCED CORNERS FOR UNPARALLELED STRENGTH AND DURABILITY
- ARCHED DOUBLE SWING GATES

COMPLETE YOUR RESIDENTIAL ALUMINUM FENCE PROJECT WITH A WALK GATE OR DRIVE GATE IN STYLES THAT MATCH YOUR FENCE. ALL GATES ARE FULLY WELDED FOR CLEAN LINES AND LONG LIFE. ARCHED OR STRAIGHT SWING GATES PROVIDE THE PERFECT STYLE ENTRANCE TO YOUR FRONT YARDS, AND BACKYARDS. IF YOU NEED TO TRANSPORT BULK EQUIPMENT THROUGH DRIVEWAY BACKYARDS, CONSIDER A 5' OR 6' WIDE WALK GATE.

NOTE:

VERIFY EVERY SWING GATE FACTOR OPERATOR, CALL BOX AND INSTALLATION SHALL BE DONE BY THE GENERAL CONTRACTOR

sheet number

ST-FNC

scale: 1" = 10'-0"

design: d. barth

drawn: S. M. 12/23

checked: S. M. 12/23

revised:

Site information taken from boundary and location map provided by: MCB Engineering & Surveying & Planning, Inc. (10000 N. Dale Mabry Blvd., Suite C, Tampa, FL 33610)

Project Name: THE DILLON RESIDENCE

Address: 5950 Gulf of Mexico Drive, Longboat Key, Florida 34228

Client: M. S. Pitt - LS 5598

Phone: 727-222-1222

A Proposed Site/Fence Plan for:

THE DILLON RESIDENCE

5950 Gulf of Mexico Drive
Longboat Key, Florida 34228

BLDG PERMIT PLANS
FILE
Copy of Record

DENNIS A. BARTH
LANDSCAPE ARCHITECT
LICENSED PROFESSIONAL ARCHITECT
10000 N. DALE MABRY BLVD., SUITE C
TAMPA, FL 33610
PH: 727-222-1222

RECEIVED
 OCT 11 5 2023
 TOWN OF LONGBOAT KEY
 Planning, Zoning & Building

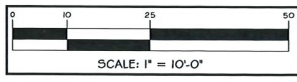

copyright © 2022 Dennis Barth, Landscape Architect. All Rights Reserved.