

D

Permit # PS 22-0036
REVIEWED FOR CODE COMPLIANCE
LONGBOAT KEY BUILDING DEPT.



6010 Cortez Rd.
Bradenton, FL 34217
941-932-1414
CPC-1458020

Designed by Josh M.. Johnson

JUL 11 2022

APPROVED
Reviewer: PATTI FIGE

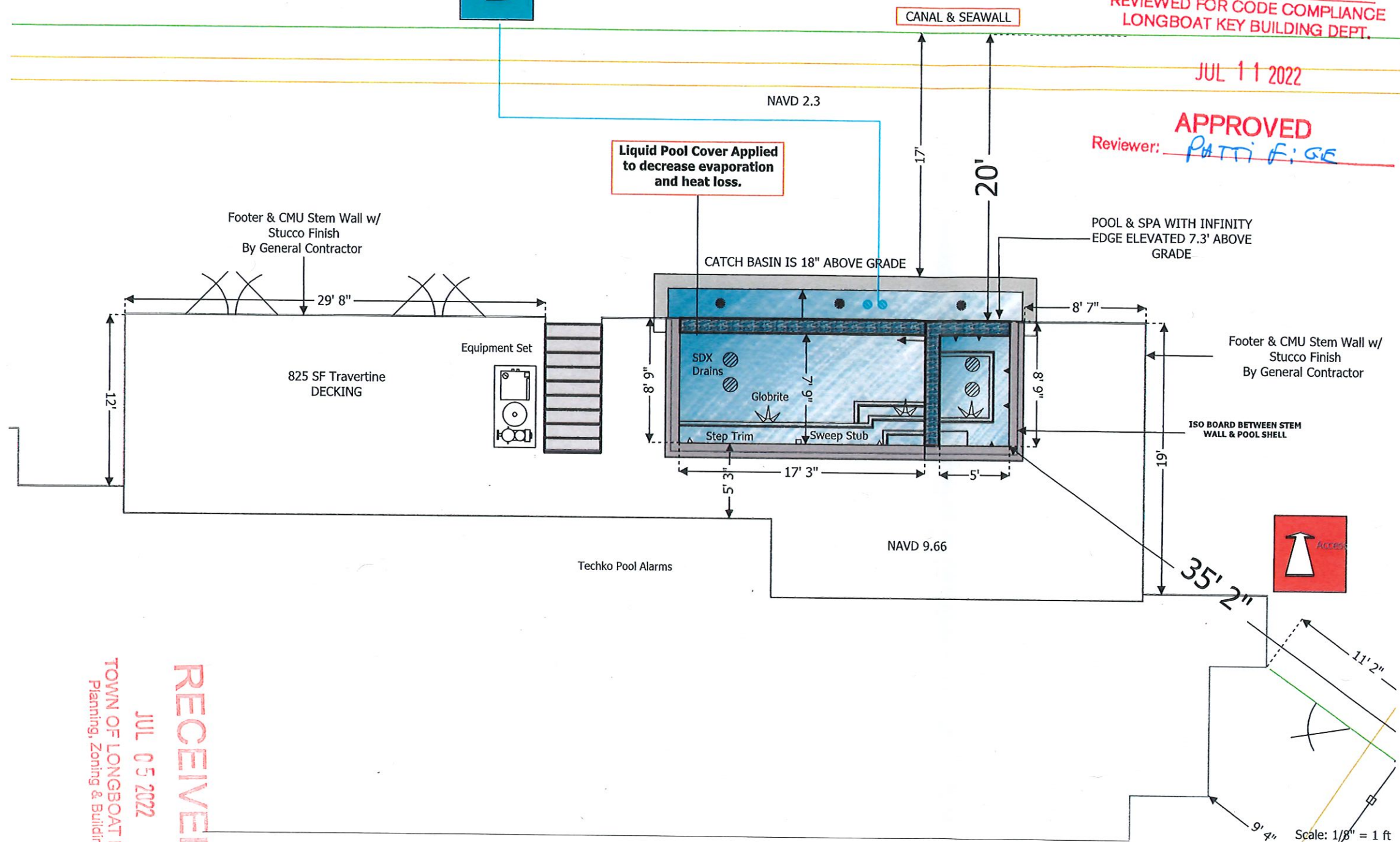

RECEIVED
JUL 05 2022
TOWN OF LONGBOAT KEY
Planning, Zoning & Building

NAME: BURKE RESIDENCE 6/30/2022
ADDRESS: 639 BAYVIEW DR.
CITY: LONGBOAT KEY STATE: FL
PHONE: _____ ZIP: 34228
EMAIL: _____
CELL: _____

POOL SPECS
SIZE: 7'9" x 17'3" RAISED 7.3' SQFT: 134
DEPTH: 3'6" - 5' PERIMETER: 56
EST TOTAL GALLONS: 5,000 SKIMMERS: Yes 1
RETURNS: 3 INTERIOR MATERIAL: Mini Pebble
LIGHTS: 2 LED Globrite Color TILE: Glass
SPECIAL: Umbrella Hole, Color Vision Bubbler
NOTES: _____

SPA SPECS
SIZE: 5' X 7'9" RAISED 7'3" SQFT: 38
DEPTH: 3'6" PERIMETER: 28
RAISED HEIGHT: FLUSH SPILLWAY: Open
THERAPY JETS: 5 TILE: Glass
SPECIAL: 1 LED Globrite Color
NOTES: _____

DECK
DECK TYPE: Travertine ELEVATION: Grade
TOTAL DECK SQFT: 825 PERIMETER: _____
RAISED BEAM: _____ LIP STYLE: Travertine Coping
SPECIAL: _____
NOTES: ELEVATED 7.3

EQUIPMENT
POOL PUMP: Pentair Intelliflo 2ND PUMP: _____
FILTRATION: IC 40 FILTER SIZE: CC 200
HEATER: T140 INLINE: Sweep Stub
TIMER: Easy Touch 4 Controller GAS: RAYPAC 400,000 BTU

SPECIAL: Screen Logic
NOTES: _____
Customer Signature _____ Date _____

BLDG PERMIT PLANS
FILE
Copy of Record

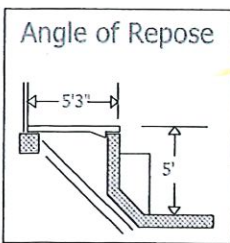

CHILD SAFETY ALARMS SHALL BE SYSTEM PREVIOUSLY APPROVED BY THE BLDG. DEPT., INSTALLED AND ACTIVE ON ALL DOORS AND WINDOWS AT TIME OF FINAL INSPECTION PURSUANT TO 424.2.17.1.9F.B.C.

#8 AWG BOND WIRE 4"-6" BELOW SUBGRADE 18"-24" FROM POOL BONDED @ 4 POINTS TO POOL SHELL NEC 680.26 (B)(2)(B)

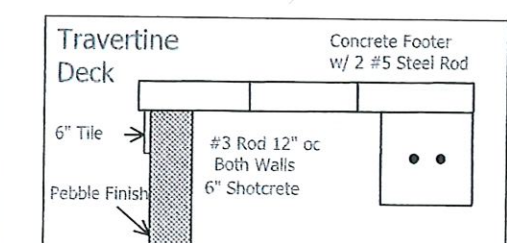
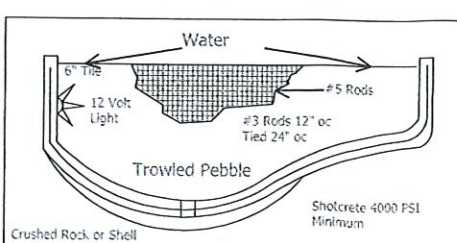

TOP OF SPA WALL ELEV. 7.33

TOP OF CATCH BASIN ELEV. 3.80

GROUND ELEV. 2.30

#3 BAR CONT. @ 12" O.C. EACH WAY

2 MAIN DRAINS WITH APPROVED ASME/ANSI COVERS SECURELY ATTACHED

TO POOL FILTER

WATER OVERFLOW

POOL/SPA

GENERAL NOTES:

1. EXCAVATE UNSUITABLE, UNSTABLE, ORGANIC, OR UNCONSOLIDATED SUB-GRADE MATERIAL AND COMPACT THE AREA WHICH HAS BEEN CLEARED. THEN BACKFILL AND LEVEL WITH DENSE GRADE AGGREGATE SUITABLE FOR SUBBASE MATERIAL.
2. THE CONTRACTOR SHALL FIELD VERIFY ALL OMISSIONS AND NOTIFY THE ENGINEER OF ANY DEVIATIONS FROM THE PLANS OR CONFLICT WITH ONSITE CONDITIONS.
3. THE FINISHED DECK SHALL NOT HAVE VOIDS THAT EXCEED $\frac{1}{8}$ " AND HAVE NO SHARP EDGES.
4. ALL JOINTS SHALL BE FILLED WITH MASONRY ORTONA SAND.
5. THE DECK SHALL SLOPE AT A MIN. 2% TO A MAX. 4% AWAY FROM THE POOL OR TOWARD THE DECK DRAINS.
6. ALL CONSTRUCTION SHALL BE IN ACCORDANCE WITH STATE AND LOCAL CODES.
7. THE DECK MAY BE SEALED WITH A RECOMMENDED DEEP-PENETRATION PAVER SEALANT. (CHECK WITH MANUFACTURER AND HEALTH DEPARTMENT.)
8. THE ENGINEER SHALL NOT BE HELD LIABLE FOR FAULTY MATERIALS AND INSTALLATION, IMPROPER SUBBASE, AND IMPROPER MAINTENANCE OF THE DECK.
9. THE DECK SHALL CONFORM WITH THE FLORIDA BUILDING CODES, 2020 (7TH EDITION) AND WITH ALL APPLICABLE CITY AND/OR COUNTY ORDINANCES AND CODES.
10. A EQUIPOTENTIAL BONDING GRID MUST COVER THE CONTOUR OF THE PERMANENTLY INSTALLED POOL AND SPA UNDER THE DECK. AN UNDERGROUND BONDING CONDUCTOR MADE A SINGLE #8 AWG BARE COPPER WIRE BURIED TO A MINIMUM DEPTH OF 4 TO 6 INCHES BELOW SUBGRADE, AND 18 TO 24 INCHES FROM INSIDE OF THE WALL OF A RESIDENTIAL SWIMMING POOL OR SPA AND BONDED TO THE POOL STEEL WITH #8 AWG BARE COPPER WIRE AT FOUR EQUAL PLACES AROUND THE POOL. FOR POOL WATER BONDING SEE NEC 680.26-C
11. ALL REINFORCING STEEL SHALL COMPLY WITH A.S.T.M 615 GRADE 40

**ELEVATED CATCH BASIN DETAIL
NTS**



TNS DESIGN & CONSULTING, LLC
 1532 US HWY 41 BYP S
 PMB 204
 Venice, FL 34293
 Email: tara@tnsdesignandconsulting.com
 Phone: 941.586.0142

DRAWN BY: TNS

DATE: 6/13/2022

REVISION

SCALE: AS NOTED

**ADDITIONAL SITE-SPECIFIC
DETAIL**

BURKE RESIDENCE
 639 BAYVIEW DRIVE
 LONGBOAT KEY, FLORIDA 34228

SHEET 1

THESE PLANS PREPARED UNDER THE DIRECTION OF TARA N. SALL, PE OF TNS DESIGN & CONSULTING, LLC. FLORIDA LICENSE NO. 90481. THESE PLANS MAY NOT BE REPRODUCED OR COPIED WITHOUT WRITTEN PERMISSION FROM TNS DESIGN & CONSULTING.

SEAL

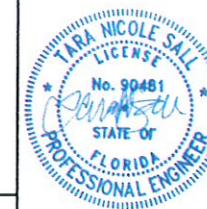

Digitally signed by
 Tara N Sall
 Date:
 2022.06.13
 16:25:25
 -04'00'

PREPARED FOR:

TOM SANGER POOLS & SPA

TOWN OF LONGBOAT KEY
Planning, Zoning & Building

JUL 05 2022

RECEIVED

BLDG PERMIT PLANS
FILE
Copy of Record

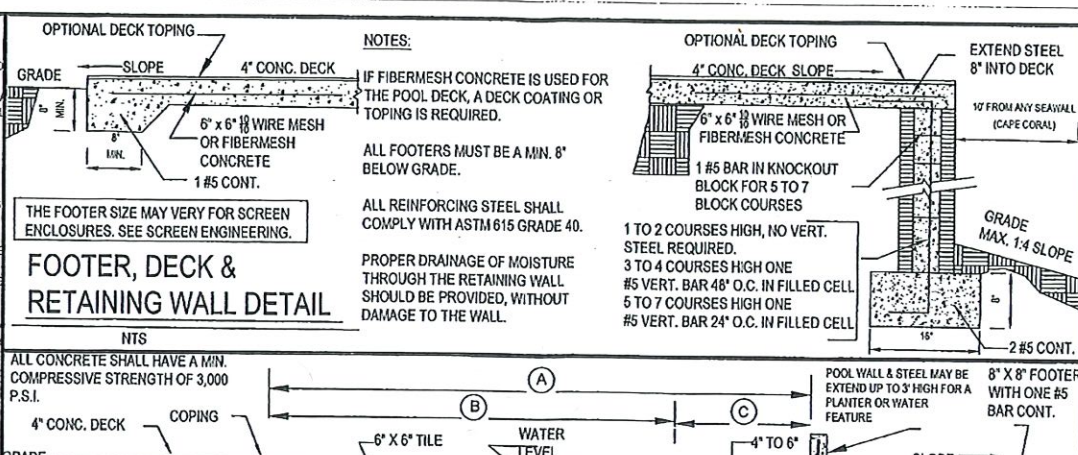
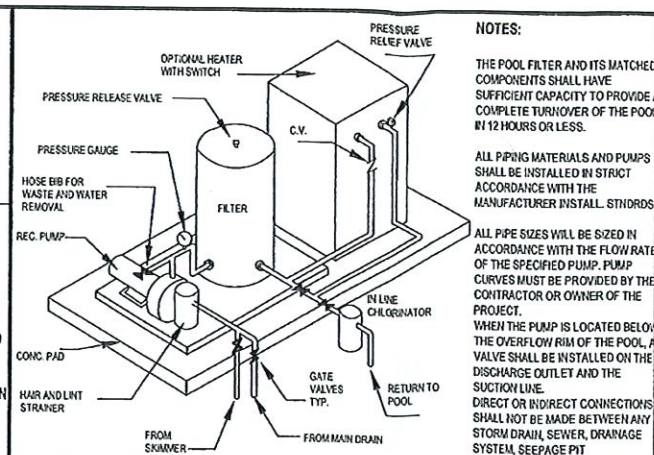
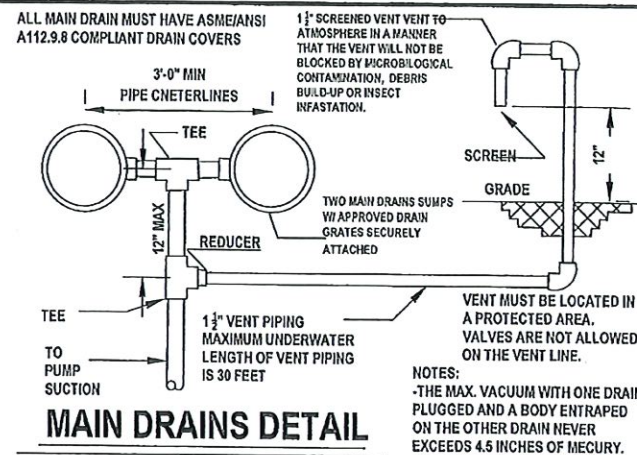

NTS

AN APPROVED MAIN OUTLET, WHEN PROVIDED, SHALL BE LOCATED ON A WALL OR FLOOR AT OR NEAR THE DEEPEST POINT IN THE POOL FOR EMPTYING OR CIRCULATION, OR BOTH, OF THE WATER IN THE POOL.

ENTRAPMENT PROTECTION FOR SUCTION OUTLETS SHALL BE INSTALLED IN ACCORDANCE WITH REQUIREMENTS OF ANS/APSP 7.

NTS

ALL CONCRETE SHALL HAVE A MIN. COMPRESSIVE STRENGTH OF 3,000 P.S.I.

4" CONC. DECK COPING

6" x 6" TILE

WATER LEVEL

4" TO 6"

6" MIN. WALLS

6" x 6" WIRE MESH OR FIBERMESH CONCRETE

BONDING WIRE

MAX. FLOOR SLOPE 1" IN 8"

100W 12V LIGHT GROUND TO POOL STEEL WITH #8 CU. WIRE

2 MAIN DRAINS WITH APPROVED ASME/ANSI COVERS SECURELY ATTACHED

HYDROSTATIC RELIEF VALVE

GRAVEL

8" x 8" FOOTER WITH ONE #5 BAR CONT.

DIMENSIONING SCHEDULE

A
B
C
D
E
F

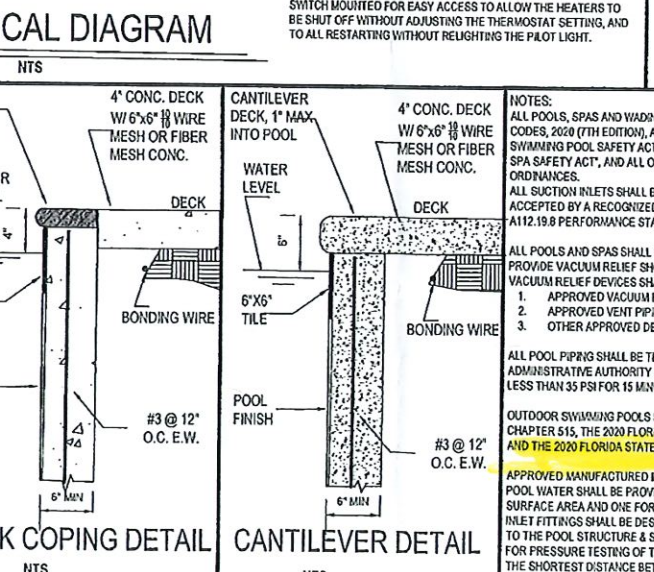
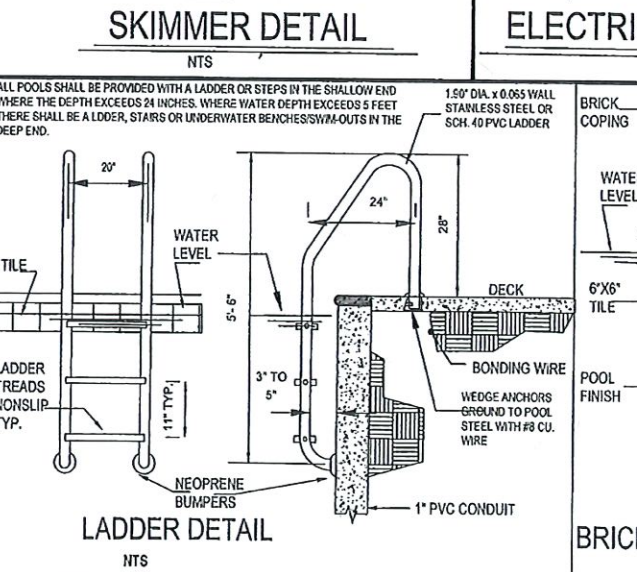
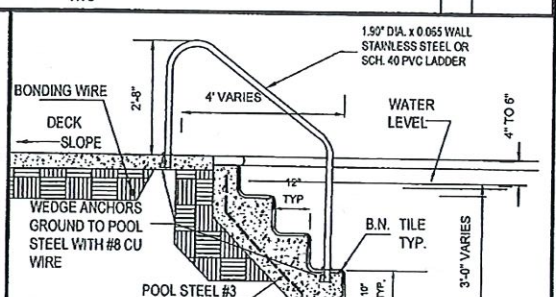
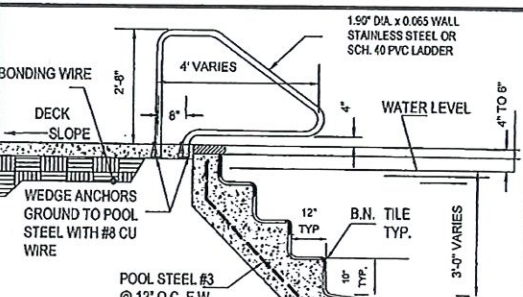
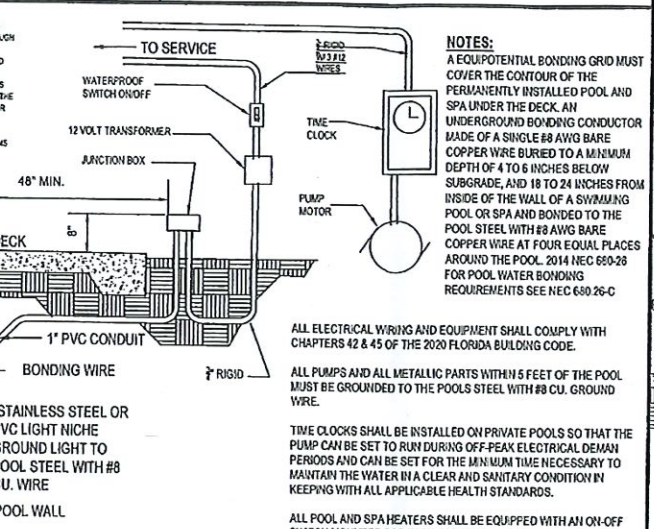
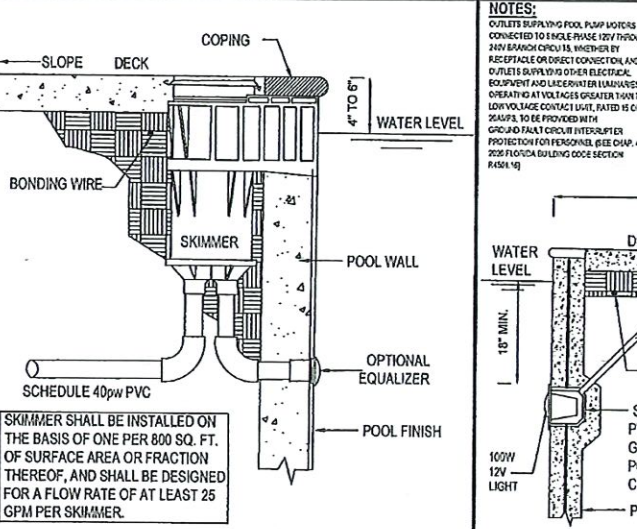
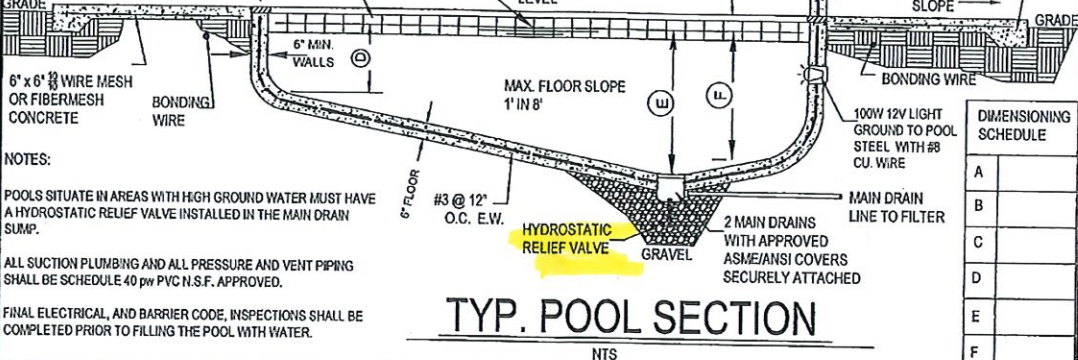

FIG. 4 HANDRAIL DETAIL

NTS

STEPS & HANDRAIL DETAIL

NTS

ATMOSPHERIC VENT ARRANGEMENT COMPLIANT WITH 454.2.6.6 2020 FLORIDA BUILDING CODE PER NEC 403.22 & POOL PUMP MOTORS MUST BE GFCI PROTECTED FOR POOL WATER BONDING REQUIREMENTS SEE NEC 680-26-C

THIS RESIDENTIAL POOL MASTER STRUCTURAL DESIGN IS ALLOWED IN ALL ZONES EXCEPT Y ZONES, AND FOR A MAX WATER DEPTH OF 8'0" AND FLOOR LOCATIONS UP TO 12'4" FROM THE NEAREST WALL (35' HIGHER) CONSULT THE ENGINEER FOR THE DESIGN FOR THE DEPTHS THAT EXCEED EITHER OF THESE DIMENSIONS PLEASE REFER TO 2020 FLORIDA BUILDING CODE RESIDENTIAL CHAPTERS 42 & 45 AND TO 2020 FLORIDA BUILDING CODE CONSERVATION SECTIONS 403.9.1 THROUGH 403.9.3 (SEE BELOW).

403.9.3 COVERS HEATED SWIMMING POOLS AND IN-GROUND PERMANENTLY INSTALLED SPAS SHALL BE EQUIPPED WITH A VAPOR RETARDANT COVER ON OR AT THE WATER SURFACE OR A LIQUID COVER OR OTHER MEANS PROVEN TO REDUCE HEAT LOSS. EXCEPTION: OUTDOOR POOLS DERIVING OVER 10% OF THE ENERGY FOR HEATING FROM POOL FILTRATION PUMP MOTORS SHALL MEET THE FOLLOWING REQUIREMENTS:

1. POOL PUMP MOTORS SHALL NOT BE SPLIT-PHASE, SHADED POLE, OR CAPACITOR START INDUCTION TYPES.
2. POOL PUMPS AND MOTORS WITH A TOTAL HORSEPOWER GREATER THAN OR EQUAL TO 1HP SHALL HAVE THE CAPABILITY OF OPERATING AT TWO OR MORE SPEEDS.

THE LOW SPEED SHALL HAVE A ROTATION RATE OF NO MORE THAN 1/2 OF THE MOTOR'S MAXIMUM ROTATION RATE. POOL PUMP CONTROLS SHALL HAVE THE CAPABILITY OF OPERATING THE POOL PUMP AT A MINIMUM OF TWO SPEEDS. THE DEFAULT CIRCULATION SPEED SHALL BE THE RESIDENTIAL FILTRATION SPEED WITH A HIGH SPEED OVERDRIVE CAPABILITY FOR A TEMPORARY PERIOD NOT TO EXCEED ONE NORMAL CYCLE OR 24 HOURS, WHICHEVER IS LESS. EXCEPTION: SOLAR POOL HEATING SYSTEMS SHALL BE PERMITTED TO RUN AT HIGHER SPEEDS DURING PERIODS OF USABLE SOLAR HEAT GAIN.

THESE PLANS PREPARED UNDER THE DIRECTION OF TARA N. SALL, PE TNS DESIGN & CONSULTING, LLC. 1532 US HWY 41 BYP S, #204 VENICE, FLORIDA 34293 FL LICENSE # 90481

MAXIMUM RATE THROUGH FILTERS	MAXIMUM WATER FLOWS IN PVC PIPE		
	PIPE SIZE	PRESSURE @ 10 FPS	SUCTION @ 8 FPS
RAPID SAND	5 GPM PER SF	63.3 GPM	60.6 GPM
DE	2 GPM PER SF	101 GPM	83.3 GPM
CARTRIDGE	1 GPM PER SF	149 GPM	119.3 GPM
		227 GPM	181.5 GPM
		356 GPM	317 GPM

THE ENGINEER SHALL NOT BE HELD LIABLE FOR 1.) FAULTY MATERIALS AND CONSTRUCTION. 2.) INADEQUATE OR IMPROPER SUPERVISION OF CONSTRUCTION. 3.) IMPROPER POOL MAINTENANCE AFTER CONSTRUCTION. 4.) HYDROSTATIC UPLIFT OF THE POOL.

THESE PLANS ARE FOR RESIDENTIAL POOLS ONLY AND THEY MAY NOT BE USED FOR ANY COMMERCIAL POOL OR COMMERCIAL EXEMPT POOL. THESE PLANS ARE FOR THE EXPLICIT USE FOR THE BUILDER NAMED. NO OTHER BUILDER MAY USE THESE PLANS WITHOUT THE WRITTEN CONSENT FROM THE BUILDER AND TNS DESIGN & CONSULTING, LLC.

TNS DESIGN & CONSULTING, LLC
1532 US HWY 41 BYP S #204
VENICE, FL 34293
PHONE 941.586.0142
TARA@TNSDESIGNANDCONSULTING.COM
TARA N. SALL,
FLORIDA PE LICENSE NO. 90481

DESIGN, CONSTRUCTION AND WORKMANSHIP SHALL BE IN CONFORMANCE WITH THE REQUIREMENTS OF ANS/APSP 7 STANDARD FOR RESIDENTIAL SWIMMING POOLS. PUBLISHED BY THE NATIONAL SPA & POOL INSTITUTE (NSPI) OR OTHER ACCEPTED ENGINEERING PRACTICES.

ALL MATERIALS, PIPING, VALVES, EQUIPMENT OR APPLIANCES ENTERING INTO THE CONSTRUCTION OF SWIMMING POOLS OR PORTIONS THEREOF SHALL BE A TYPE THAT COMPLIES WITH BUILDING CODE OR OF A TYPE RECOMMENDED AND APPROVED BY A NATIONALLY RECOGNIZED TESTING AGENCY OR CONFORMS TO OTHER RECOGNIZED STANDARDS ACCEPTABLE TO THE ADMINISTRATIVE AUTHORITY.

CONTRACTOR
TOM SANGER POOL & SPA, FL LIC. CPC-1458020
6010 CORTEZ ROAD WEST
BRADENTON, FL 34210

MUNICIPALITY
Longboat
Key

THESE PLANS MAY NOT BE REPRODUCED OR COPIED WITHOUT WRITTEN PERMISSION FROM TNS DESIGN & CONSULTING

DRAWING NAME:
RESIDENTIAL POOL MASTER

SCALE: NTS
DRAWN BY: TNS
CHECKED BY: TNS
DATE: 1.21.2022

FILE NAME:
MASTRP2022

SHEET 1 OF 1

TARA NICOLE SALL
LICENSE
No. 90481
STATE OF FLORIDA
PROFESSIONAL ENGINEER

RECEIVED
 JUL 05 2022
 TOWN OF LONGBOAT KEY
 Planning, Zoning & Building

BLDG PERMIT PLANS
 FILE
 Copy of Record

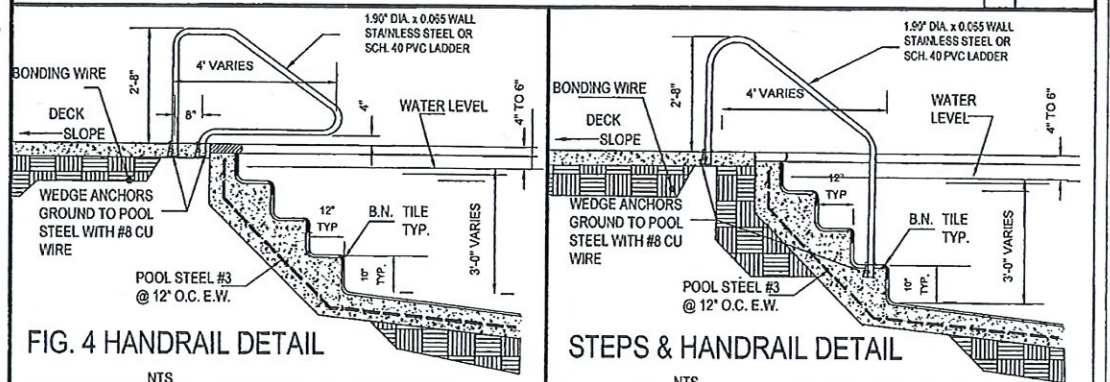
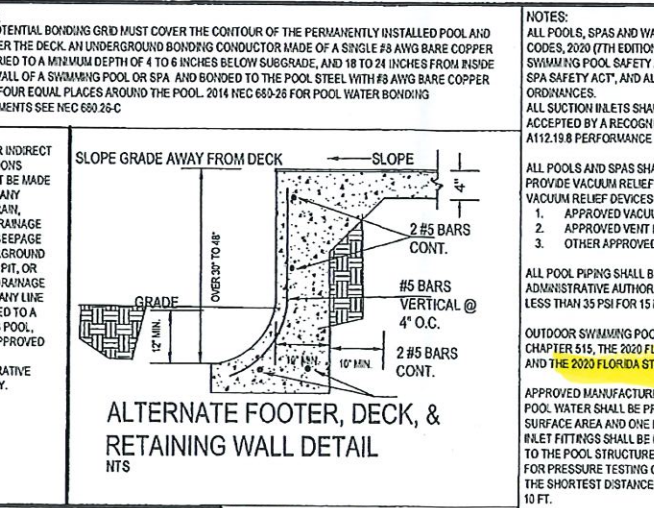
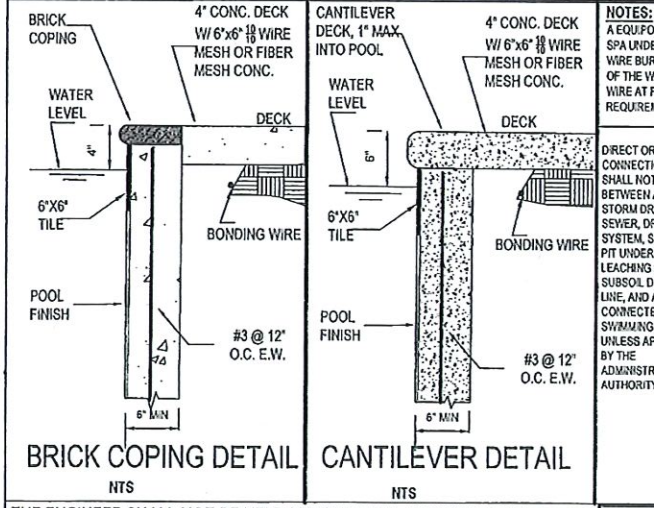
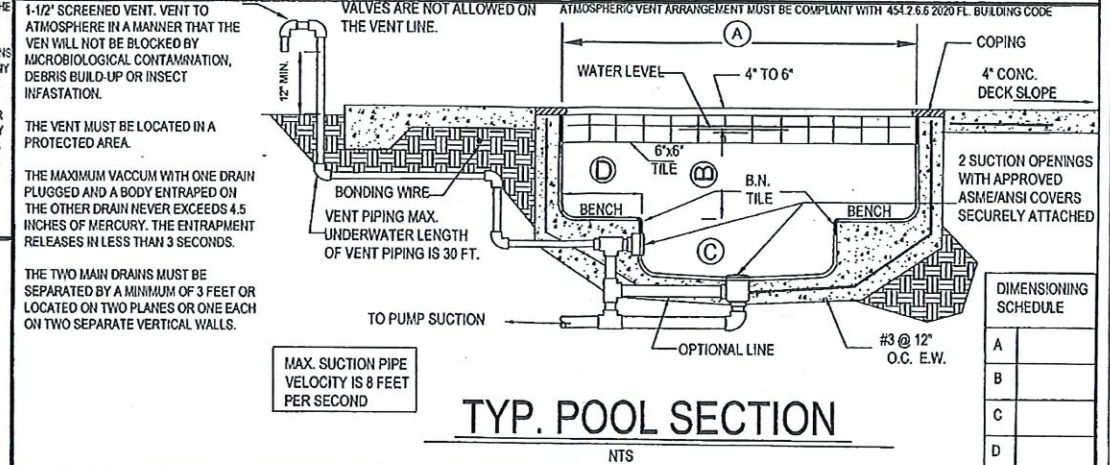
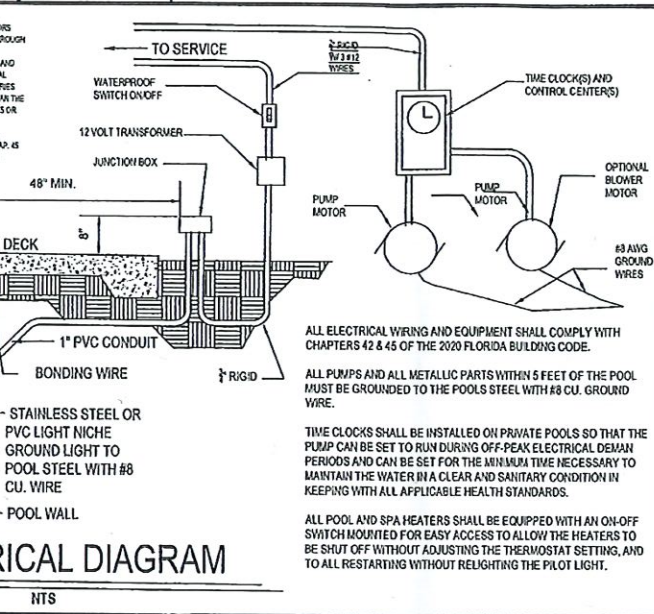
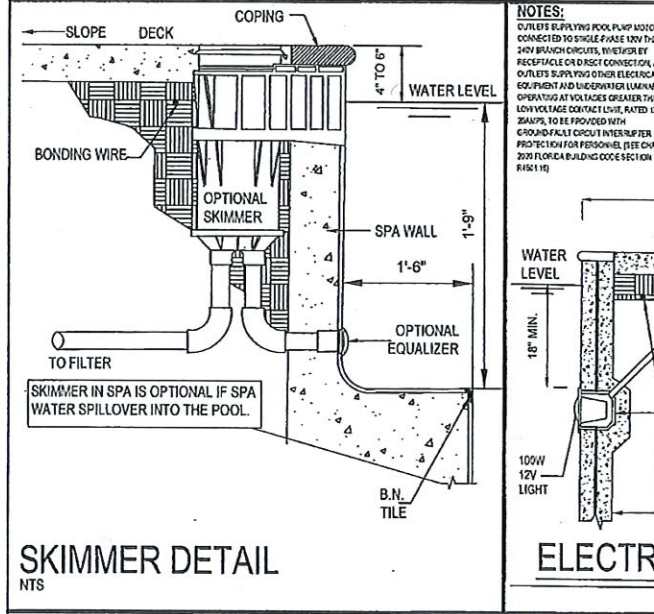
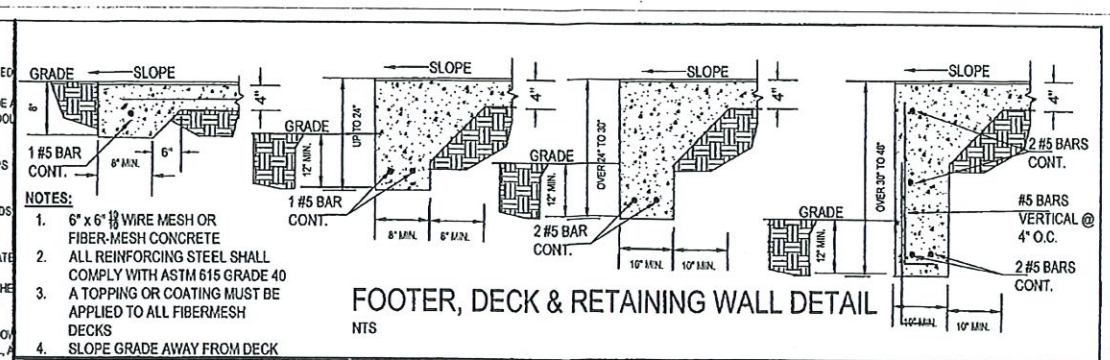
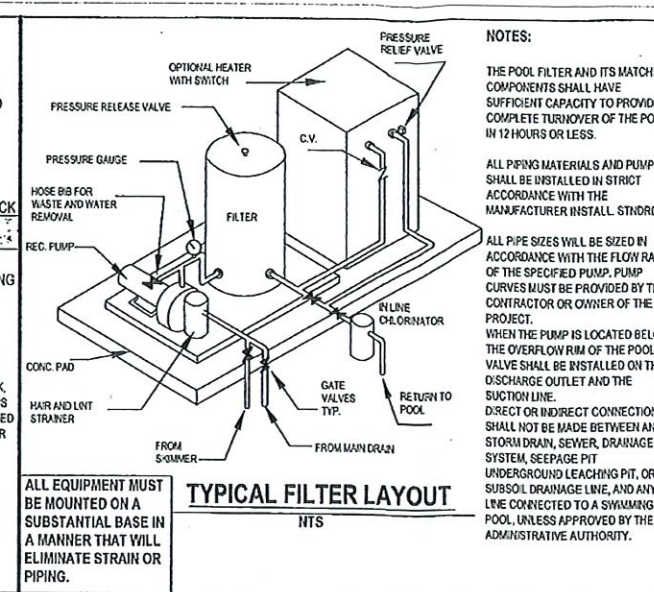
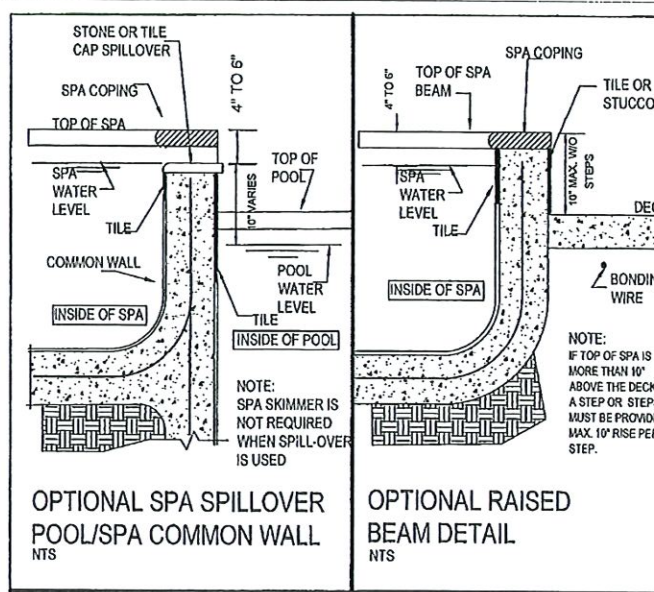

THE ENGINEER SHALL NOT BE HELD LIABLE FOR 1.) FAULTY MATERIALS AND CONSTRUCTION. 2.) INADEQUATE OR IMPROPER SUPERVISION OF CONSTRUCTION. 3.) IMPROPER POOL MAINTENANCE AFTER CONSTRUCTION. 4.) HYDROSTATIC UPLIFT OF THE POOL.

THESE PLANS ARE FOR RESIDENTIAL POOLS ONLY AND THEY MAY NOT BE USED FOR ANY COMMERCIAL POOL OR COMMERCIAL EXEMPT POOL. THESE PLANS ARE FOR THE EXPLICIT USE FOR THE BUILDER NAMED. NO OTHER BUILDER MAY USE THESE PLANS WITHOUT THE WRITTEN CONSENT FROM THE BUILDER AND TNS DESIGN & CONSULTING, LLC.

TNS DESIGN & CONSULTING, LLC
 1532 US HWY 41 BYP S #204
 VENICE, FL 34293
 PHONE 941.586.0142
 TARA@TNSDESIGNANDCONSULTING.COM
 TARA N. SALL,
 FLORIDA PE LICENSE NO. 90481

NOTES:
 ALL POOLS, SPAS AND WADING POOLS SHALL CONFORM WITH THE FLORIDA BUILDING CODE, 2020 (7TH EDITION), ALSO WITH THE 2020 FLORIDA STATUTES, RESIDENTIAL SWIMMING POOL SAFETY ACT CHAPTER 515, THE "VIRGINIA GRAMM BAKER POOL AND SPA SAFETY ACT", AND ALL OTHER APPLICABLE CITY OR COUNTY CODES AND ORDINANCES.
 ALL SUCTION INLETS SHALL BE PROVIDED WITH A COVER THAT HAS BEEN TESTED AND ACCEPTED BY A RECOGNIZED TESTING FACILITY AND COMPLY WITH ANSI/ASME A112.19.8 PERFORMANCE STANDARDS.
 ALL POOLS AND SPAS SHALL BE REQUIRED TO HAVE A BACKUP SYSTEM WHICH SHALL PROVIDE VACUUM RELIEF SHOULD THE GRATE COVERS BE MISSING. ALTERNATIVE VACUUM RELIEF DEVICES SHALL INCLUDE EITHER:
 1. APPROVED VACUUM RELEASE SYSTEM
 2. APPROVED VENT PIPING
 3. OTHER APPROVED DEVICES OR MEANS
 ALL POOL PIPING SHALL BE TESTED AND PROVED TIGHT TO THE SATISFACTION OF THE ADMINISTRATIVE AUTHORITY UNDER A STATIC WATER OR PRESSURE TEST OF NOT LESS THAN 35 PSI FOR 15 MINUTES.
 OUTDOOR SWIMMING POOLS SHALL BE PROVIDED WITH A BARRIER COMPLYING WITH CHAPTER 515, THE 2020 FLORIDA STATUTES, RESIDENTIAL SWIMMING POOL SAFETY ACT AND THE 2020 FLORIDA STATE BUILDING CODE.
 APPROVED MANUFACTURED INLET FITTINGS FOR THE RETURN OF RECIRCULATED POOL WATER SHALL BE PROVIDED ON THE BASIS OF AT LEAST ONE PER 300 SF OF SURFACE AREA AND ONE FOR EVERY 20 GPM OF THE RECIRCULATION RATE. SUCH INLET FITTINGS SHALL BE DESIGNED & CONSTRUCTED TO ENSURE AN ADEQUATE SEAL TO THE POOL STRUCTURE & SHALL INCORPORATE A CONVENIENT MEANS OF SEALING FOR PRESSURE TESTING OF THE PIPES. WHERE MORE THAN ONE INLET IS REQUIRED, THE SHORTEST DISTANCE BETWEEN ANY TWO REQUIRED INLETS SHALL BE AT LEAST 10 FT.

ATMOSPHERIC VENT ARRANGEMENT COMPLIANT WITH 454.2.6.5 2020 FLORIDA BUILDING CODE PER NEC 680.28 B POOL PUMP MOTORS MUST BE GFCI PROTECTED FOR POOL WATER BONDING REQUIREMENTS SEE NEC 680.25-C

THIS RESIDENTIAL POOL MASTER STRUCTURAL DESIGN IS ALLOWED IN ALL ZONES EXCEPT V ZONES, AND FOR A MAX WATER DEPTH OF 8'0" AND FLOOR LOCATIONS UP TO 12'4" FROM THE NEAREST WALL OR WISE AS LONG AS THE EXISTING FOUNDATION DESIGN DOES NOT EXCEED EITHER OF THESE DIMENSIONS. PLEASE REFER TO 2020 FLORIDA BUILDING CODE RESIDENTIAL CHAPTERS 42 & 45 AND TO 2020 FLORIDA BUILDING CODE CONSERVATION SECTIONS 403.9.1 THROUGH 403.9.3 (SEE BELOW):

403.9.3 COVERS HEATED SWIMMING POOLS AND IN-GROUND PERMANENTLY INSTALLED SPAS SHALL BE EQUIPPED WITH A VAPOR-RETARDANT COVER ON OR AT THE WATER SURFACE OR A LIQUID COVER OR OTHER MEANS PROVEN TO REDUCE HEAT LOSS. EXCEPTION: OUTDOOR POOLS DERIVING OVER 10% OF THE ENERGY FOR HEATING FROM SITE COVERED ENERGY OR SOLAR ENERGY SOURCE COMPUTED OVER AN OPERATING SEASON.

POOL FILTRATION PUMP MOTORS SHALL MEET THE FOLLOWING REQUIREMENTS:

- POOL PUMP MOTORS SHALL NOT BE SPLIT-PHASE, SHADED-POLE, OR CAPACITOR START INDUCTION TYPES.
- POOL PUMPS AND MOTORS WITH A TOTAL HORSEPOWER GREATER THAN OR EQUAL TO 1 HP SHALL HAVE THE CAPABILITY OF OPERATING AT TWO OR MORE SPEEDS. THE LOW SPEED SHALL HAVE A ROTATION RATE OF NO MORE THAN 1/2 OF THE MOTORS MAXIMUM ROTATION RATE.
- POOL PUMP CONTROLS SHALL HAVE THE CAPABILITY OF OPERATING THE POOL PUMP AT A MAXIMUM OF TWO SPEEDS. THE DEFAULT CIRCULATION SPEED SHALL BE THE RESIDENTIAL FILTRATION SPEED WITH A HIGH SPEED OVERRIDE CAPABILITY FOR A TEMPORARY PERIOD NOT TO EXCEED ONE NORMAL CYCLE OR 24 HOURS, WHICH NEVER LESS. EXCEPTION: SOLAR POOL HEATING SYSTEMS SHALL BE PERMITTED TO RUN AT HIGHER SPEEDS DURING PERIODS OF USABLE SOLAR HEAT GAIN.

	MAXIMUM RATE THROUGH FILTERS		MAXIMUM WATER FLOWS IN PVC PIPE	
	RAPID SAND	DE CARTRIDGE	PIPE SIZE	SUCTION @ 10 FPS SUCTION @ 8 FPS
1 1/2"	5 GPM PER SF	2 GPM PER SF	11"	63.3 GPM 80.3 GPM
2"	2 GPM PER SF	1 GPM PER SF	12"	104 GPM 119.3 GPM
3"			14"	227 GPM 181.5 GPM
4"			16"	395 GPM 317 GPM

CONTRACTOR
TOM SANGER POOL & SPA, FL LIC. CPC-1458020
 6010 CORTEZ ROAD WEST
 BRADENTON, FL 34210

MUNICIPALITY
 Longboat Key

THESE PLANS MAY NOT BE REPRODUCED OR COPIED WITHOUT WRITTEN PERMISSION FROM TNS DESIGN & CONSULTING

DESIGN, CONSTRUCTION AND WORKMANSHIP SHALL BE IN CONFORMANCE WITH THE REQUIREMENTS OF ANSIS/SP1 STANDARD FOR RESIDENTIAL SWIMMING POOLS PUBLISHED BY THE NATIONAL SPA & POOL INSTITUTE (NSPI) OR OTHER ACCEPTED ENGINEERING PRACTICES.

ALL MATERIALS, PIPING, VALVES, EQUIPMENT OR APPLIANCES ENTITLED INTO THE CONSTRUCTION OF SWIMMING POOLS OR PORTIONS THEREOF SHALL BE A TYPE THAT COMPLES WITH BUILDING CODE OR OF A TYPE RECOMMENDED AND APPROVED BY A NATIONALLY RECOGNIZED TESTING AGENCY OR CONFORMS TO OTHER RECOGNIZED STANDARDS ACCEPTABLE TO THE ADMINISTRATIVE AUTHORITY.

DRAWING NAME:
RESIDENTIAL SPA MASTER

SCALE: NTS
 DRAWN BY: TNS
 CHECKED BY: TNS
 DATE: 1.21.2022

DRAWING NAME:
MASTERspa2021-01

SHEET 1 OF 1

RECEIVED
 JUL 05 2022
 TOWN OF LONGBOAT KEY
 Planning, Zoning & Building

BLDG PERMIT PLANS
 FILE
 Copy of Record

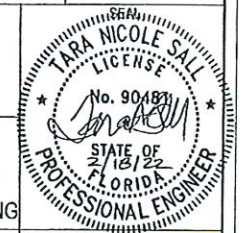

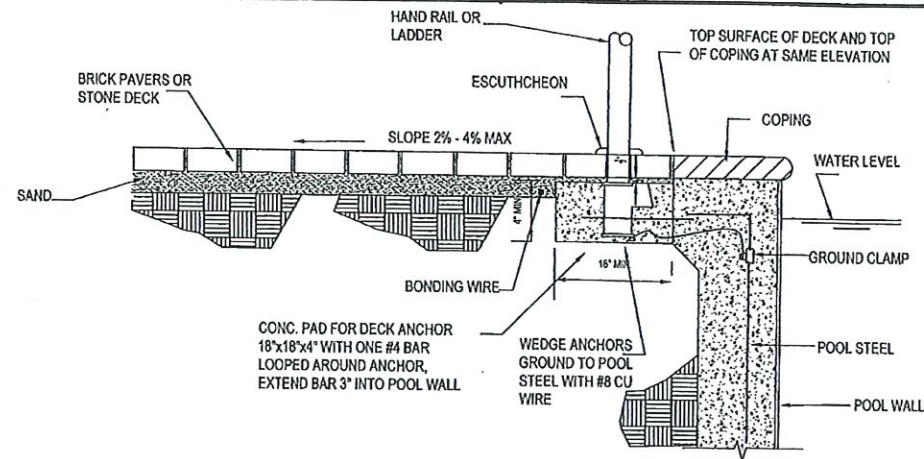

DECK AND DECK ANCHOR DETAIL
NTS

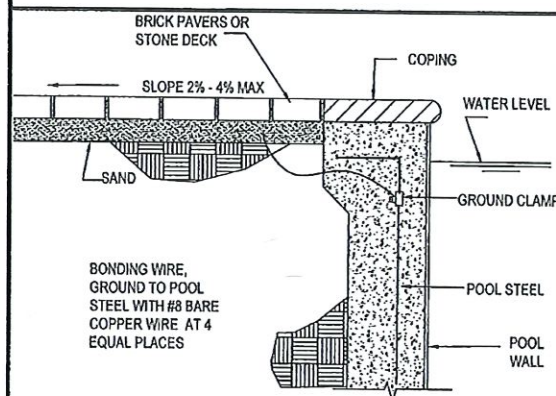

COPPER BONDING GRID

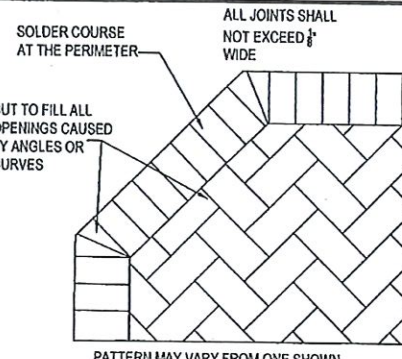

PATTERN DETAIL

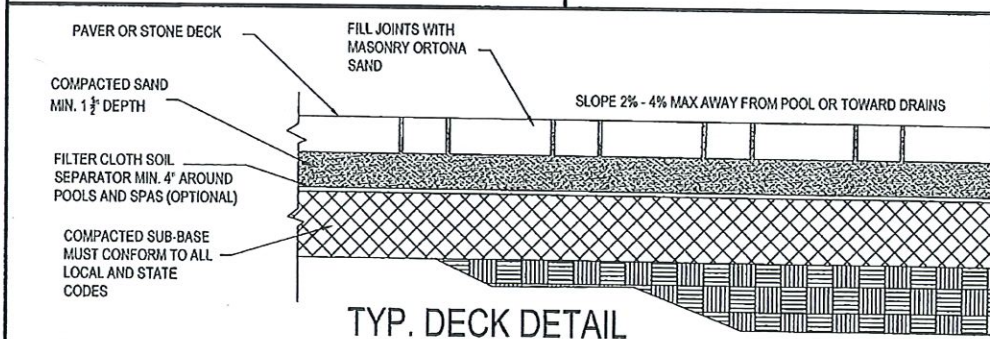

TYP. DECK DETAIL

THIS SPACE INTENTIONALLY LEFT BLANK

1 TO 2 COURSES HIGH (UP TO 16\"/>

3 TO 4 COURSES HIGH (UP TO 32\"/>

5 TO 7 COURSES HIGH (UP TO 56\"/>

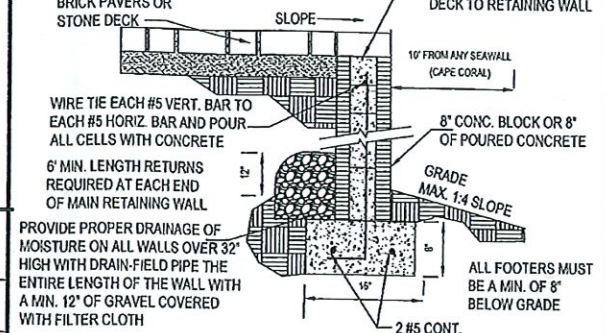

RETAINING WALL DETAIL
NTS

- NOTES:**
- EXCAVATE UNSUITABLE, UNSTABLE, ORGANIC, OR UNCONSOLIDATED SUB-GRADE MATERIAL AND COMPACT THE AREA WHICH HAS BEEN CLEARED. THEN BACKFILL AND LEVEL WITH DENSE GRADE AGGREGATE SUITABLE FOR SUBBASE MATERIAL.
 - THE CONTRACTOR SHALL FIELD VERIFY ALL OMISSIONS AND NOTIFY THE ENGINEER OF ANY DEVIATIONS FROM THE PLANS OR CONFLICT WITH ONSITE CONDITIONS.
 - THE FINISHED DECK SHALL NOT HAVE VOIDS THAT EXCEED 1/8\"/>

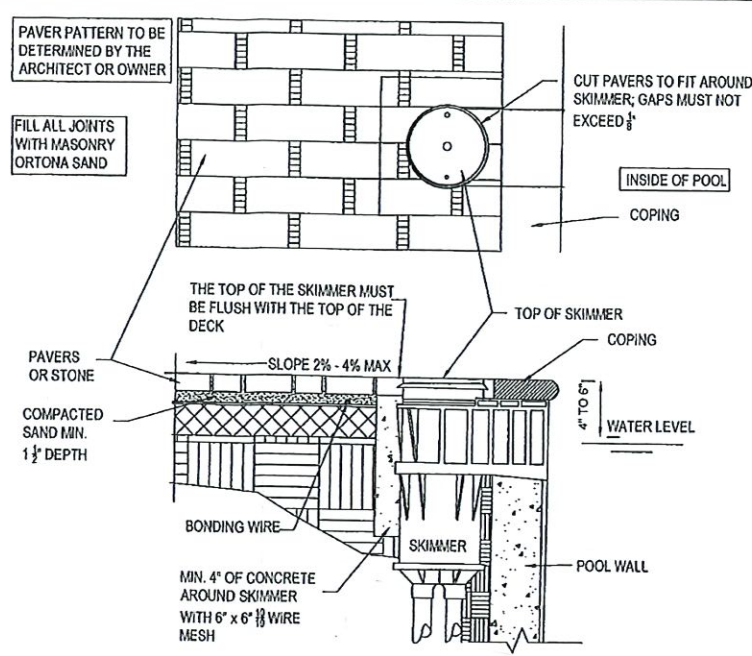

SKIMMER DETAIL
NTS

NOTE:
IF DRAINS ARE REQUIRED IN THE DECK, 4\"/>

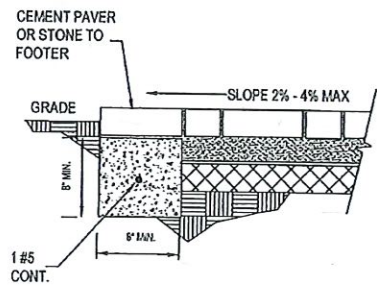

DECK EDGE DETAIL
NTS

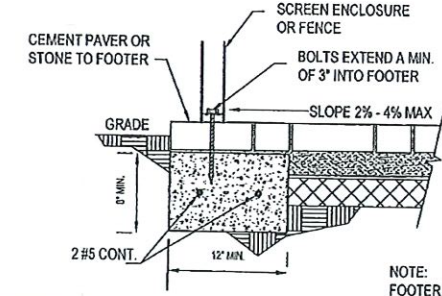

NOTE:
FOOTER DIMENSION FOR SCREEN ENCLOSURES MAY BE DIFFERENT THAN THE ONE SHOWN. SEE SCREEN ENCLOSURE DRAWINGS.

THE ENGINEER SHALL NOT BE HELD LIABLE FOR 1) FAULTY MATERIALS AND CONSTRUCTION. 2) INADEQUATE OR IMPROPER SUPERVISION OF CONSTRUCTION. 3) IMPROPER POOL MAINTENANCE AFTER CONSTRUCTION. 4) HYDROSTATIC UPLIFT OF THE POOL.

THESE PLANS ARE FOR RESIDENTIAL POOLS ONLY AND THEY MAY NOT BE USED FOR ANY COMMERCIAL POOL OR COMMERCIAL EXEMPT POOL. THESE PLANS ARE FOR THE EXPLICIT USE FOR THE BUILDER NAMED. NO OTHER BUILDER MAY USE THESE PLANS WITHOUT THE WRITTEN CONSENT FROM THE BUILDER AND TNS DESIGN & CONSULTING, LLC.



TNS DESIGN & CONSULTING, LLC
1532 US HWY 41 BYP S #204
VENICE, FL 34293
PHONE 941.586.0142
TARA@TNSDESIGNANDCONSULTING.COM
TARA N. SALL,
FLORIDA PE LICENSE NO. 90481

CONTRACTOR
TOM SANGER POOL & SPA, FL LIC. CPC-1458020
6010 CORTEZ ROAD WEST
BRADENTON, FL 34210

MUNICIPALITY
Longboat Key

THESE PLANS MAY NOT BE REPRODUCED OR COPIED WITHOUT WRITTEN PERMISSION FROM TNS DESIGN & CONSULTING

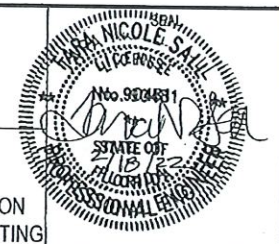

DRAWING NAME: MASTER PAVER OR STONE DECK		SCALE: NTS	DRAWING NAME: MASTERRpsd2022-01
DATE: 1.21.2022	CHECKED BY: TNS	DRAWN BY: TNS	SHEET 1 OF 1

RECEIVED
 JUL 05 2022
 TOWN OF LONGBOAT KEY
 Planning, Zoning & Building

BLDG PERMIT PLANS
 FILE
 Copy of Record

BLDG PERMIT PLANS
 FILE
 Copy of Record