

BLDG PERMIT PLANS FILE Copy of Record

Permit # PS PS22-0033 REVIEWED FOR CODE COMPLIANCE LONGBOAT KEY BUILDING DEPT.

NOV 18 2022

APPROVED

Reviewer: PATTI FIGE FOR AMIR ANIS

NOV 09 2022

RECEIVED

TOWN OF LONGBOAT KEY Planning, Zoning & Building

4' Alum surrounds pool.

Liquid Pool Cover Applied to decrease evaporation and heat loss.

Angle of Repose

#8 AWG BOND WIRE 4"-6" BELOW SUBGRADE 18"-24" FROM POOL BONDED @ 4 POINTS TO POOL SHELL NEC 680.26 (B)(2)(B)

CHILD SAFETY ALARMS SHALL BE SYSTEM PREVIOUSLY APPROVED BY THE BLDG. DEPT., INSTALLED AND ACTIVE ON ALL DOORS AND WINDOWS AT TIME OF FINAL INSPECTION PURSUANT TO 424.2.17.1.9F.B.C.

Water

#5 Rods

#3 Rods 12" oc Tied 24" oc

Trowled Pebble

Shotcrete 4000 PSI Minimum

Crushed Rock or Shell

Travertine Deck

Concrete Curb

6" Tile

#3 Rod 12" oc Both

Pebble Finish

6" Shotcrete

self closing gate

6010 Cortez Rd. WEST
Bradenton, FL 34210
941-932-1414
CPC-1458020

TOM SANGER
 POOL & SPA

Designed by Josh M.. Johnson

NAME: HORTON RESIDENCE / DEP STATE PROJECT 7/12/2022

ADDRESS: 6401 GULD OF MEXICO DR.

CITY: LONGBOAT KEY STATE: FL

PHONE: _____ ZIP: 34228

EMAIL: johnandvalariehorton@gmail.com

CELL: 813-241-5689

POOL SPECS

SIZE: 18' x 40' SQFT: 700

DEPTH: 3'6" - 6' PERIMETER: 120

EST TOTAL GALLONS: 21,500 SKIMMERS: Yes 1

RETURNS: 5 INTERIOR MATERIAL: Mini Pebble

LIGHTS: 4 TURTLE SAFE LIGHTS TILE: Glass

SPECIAL: SUNSHELF WITH 2 UMBRELLA FITTINGS

NOTES: COLOR VISION BUBBLER

SPA SPECS

SIZE: 6' x 8' SQFT: 48

DEPTH: 3'6" PERIMETER: 28

RAISED HEIGHT: 18" SPILLWAY: Open

THERAPY JETS: 6 TILE: Glass

SPECIAL: 1 TURTLE SAFE LIGHT

NOTES: _____

DECK

DECK TYPE: Travertine ELEVATION: At Grade

TOTAL DECK SQFT: 1,484 PERIMETER: _____

RAISED BEAM: _____ LIP STYLE: Travertine Coping

SPECIAL: _____

NOTES: _____

EQUIPMENT

POOL PUMP: Pentair Intelliflo 2ND PUMP: Pentair Intelliflo

FILTRATION: IC 40 FILTER SIZE: CC RP 200

HEATER: T140 INLINE: Sweep Stub

TIMER: Easy Touch 4 Controller GAS: RAYPACK 400,000 BTU

SPECIAL: Screen Logic

NOTES: _____

Customer Signature _____ Date _____

BLDG PERMIT PLANS FILE COPY OF RECORD

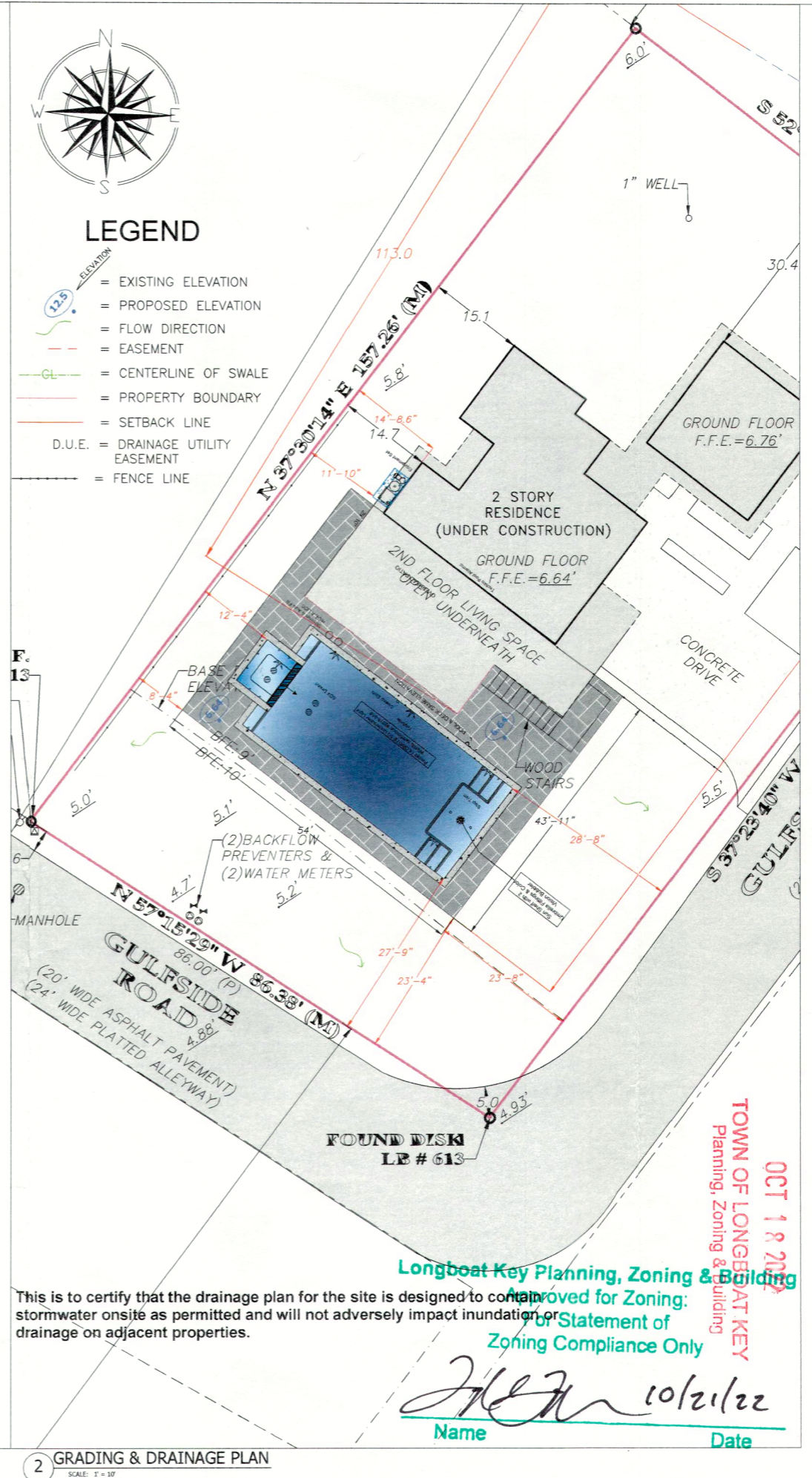
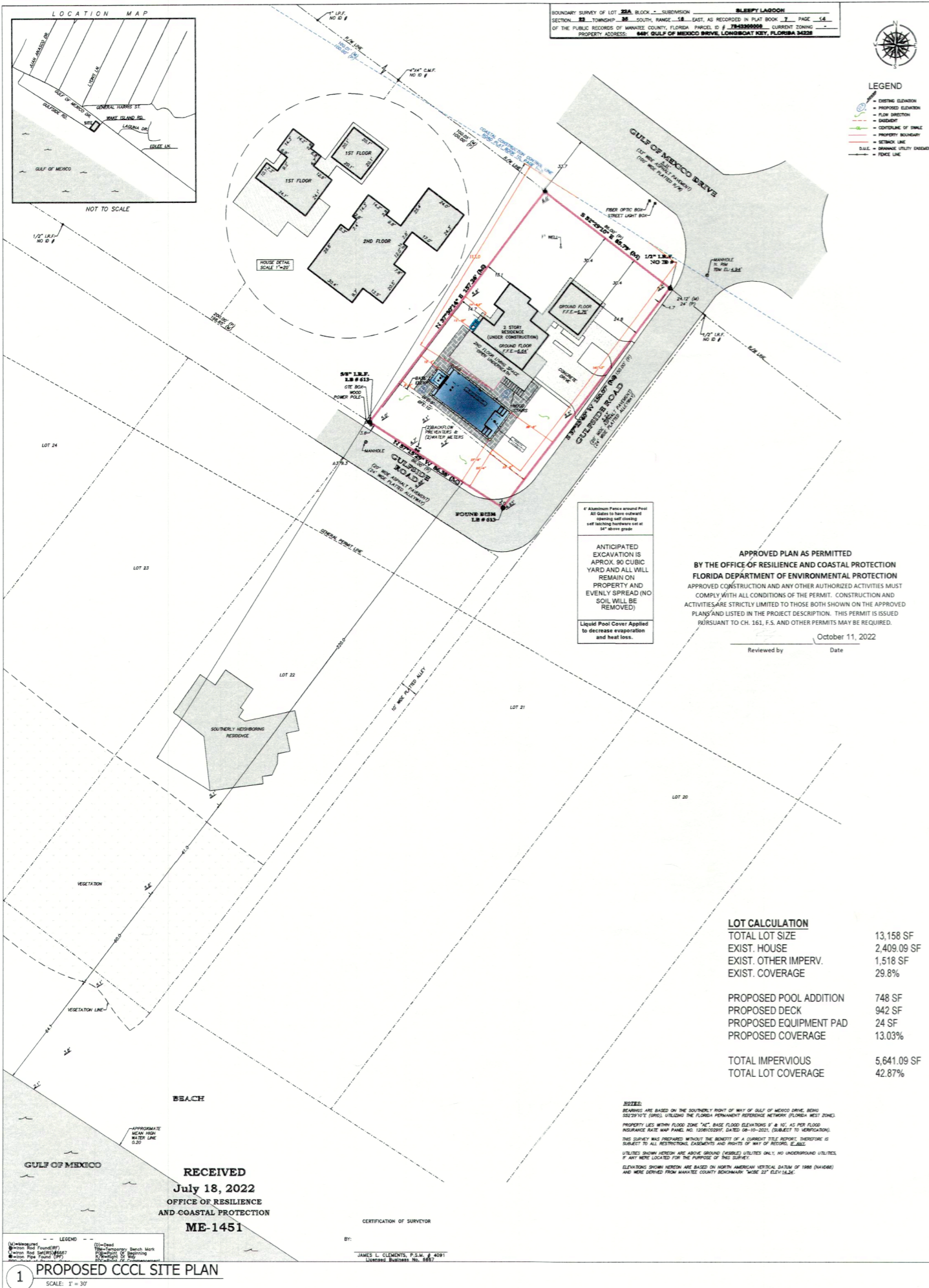

General Notes

- THE SURVEY AS SHOWN ON THIS SHEET WAS DOCUMENTED BY: CLEMENTS SURVEYING, INC. 509 8TH AVENUE W PALMETTO, FL 34221 PHONE: 941.729.6690 FAX: 941.729.7580 DATED: 04.18.2022 SURVEY NO.: 2022-113 TITLED: BOUNDARY AND TOPOGRAPHIC SURVEY
- PREPARED FOR JOHN D. HORTON AND VALARIE K. HORTON
- ALL LOCATIONS, ELEVATIONS, UTILITIES OR OTHER MARKED DATA POINTS SHOULD REFERENCE AN ORIGINAL SIGNED & SEALED SURVEY FOR CLARIFICATIONS AND ACCURACY. THIS DESIGN & CONSULTING, LLC DOES NOT TAKE ANY RESPONSIBILITY AS FOR THE ACCURACY OF EXISTING INFORMATION AND IS USING THE REFERENCED SURVEY PURPOSES AND DRAINAGE OF NEW WORK ONLY.
- THE ENTIRETY OF THIS PROPERTY IS WITHIN THE COOL
- ALL ELEVATIONS ARE SHOWN IN NAVD83 DATUM 6. PER WWW.FEMA.GOV THE PROPERTY APPEARS TO BE LOCATED IN FLOOD ZONE "AE" WITH BFE OF 9.0 AND 10.0

SEAL
 Digitally signed by Tara N Sall
 Date: 2022.07.18 10:17:19 -04'00'

TARA N. SALL
 FLORIDA LICENSE NO. PE 90481

No.	Revision/Issue	Date

Firm Name and Address
 TNS DESIGN & CONSULTING, LLC
 1532 US HWY 41 BVP S. PMB 204 VENICE, FLORIDA 34293 941.586.0142 tara@tnsdesignandconsulting.com

Project Name and Address
 HORTON RESIDENTIAL POOL
 6401 GULF OF MEXICO DRIVE LONGBOAT KEY, FLORIDA 34228
 FOR TOM SANGER POOL & SPA

Project	HORTON RESIDENTIAL POOL	Sheet	01
Date	7/14/2022		
Scale	AS NOTED		

BLDG PERMIT PLANS
FILE COPY OF RECORD

#1

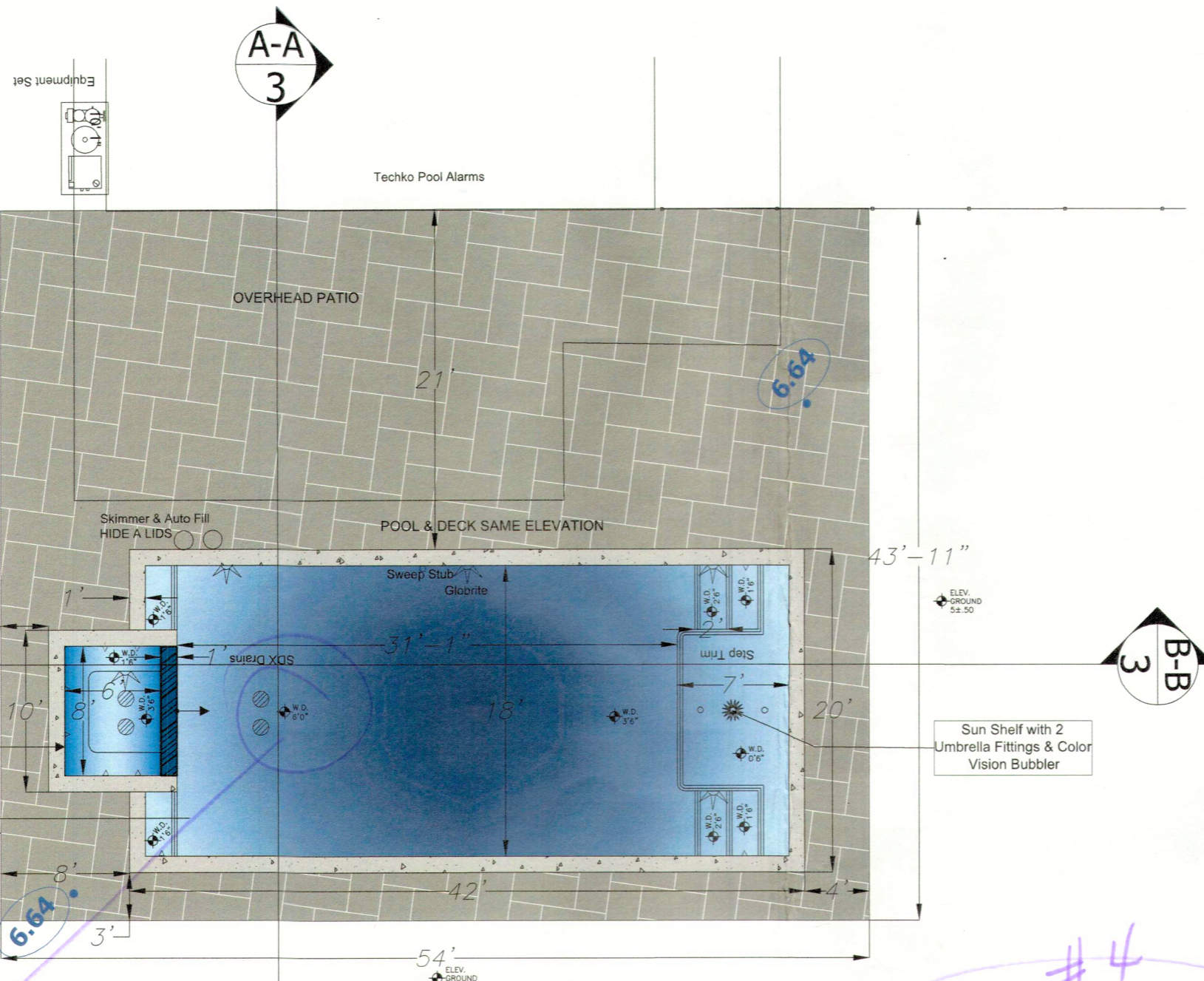

Liquid Pool Cover Applied to decrease evaporation and heat loss.

4' ALUMINUM Fence around Pool
 All Gates to have outward opening self closing self latching hardware set at 54" above grade

#8 AWG BOND WIRE 4"-6" BELOW SUBGRADE 18"-24" FROM POOL BONDED @ 4 POINTS TO POOL SHELL NEC 680.26 (B)(2)(B)

CHILD SAFETY ALARMS SHALL BE SYSTEM PREVIOUSLY APPROVED BY THE BLDG. DEPT., INSTALLED AND ACTIVE ON ALL DOORS AND WINDOWS AT TIME OF FINAL INSPECTION PURSUANT TO 424.2.17.1.9F.B.C.

GloBrite® Color Changing LED Pool Light Overview
 This manual describes how to install and replace the GloBrite Color LED light for pool and spa. GloBrite Color LED lights provide brilliant vivid multi-colors with spectacular effects for your pool. Choose one of the seven pre-programmed color light shows or select one of the five fixed colors to create virtually endless range of dramatic underwater lighting effects for a spectacular effect in your pool and spa.

Accessory: The optional GloBrite Glass Shield (PIN 820314 - sold separately) is for use on GloBrite Color and White LED lights to reduce light glare.

Operating GloBrite Color LED Lights Using a Wall Switch
 The GloBrite color light can be manually controlled using a standard wall-mount light switch. Multiple GloBrite color lights can be connected via a junction box and a 12 VAC isolation transformer to a single switch so that all lights can be switched on and off together. For wiring diagram, see page 15.

Operating GloBrite Color LED Lights Using Automation Control System
 GloBrite color lights can also be automatically controlled using the Pentair IntelliTouch® Control System and the EasyTouch® Control System. For more information refer to the IntelliTouch Control System User's Guide (PIN 521075), and EasyTouch Control System User's Guide (PIN 521044).

Using an External Safety Isolation Transformer for Multiple 12 VAC GloBrite Color Lights
 When using multiple GloBrite 12 VAC color lights on a 100 Watt safety isolation transformer, it is recommended that no more than three (3) GloBrite color lights be used. For long cable lengths with a single light, it is recommended not to exceed 45.72 m (150 ft.) of total cable run between the 12 VAC isolation transformer and the GloBrite color light.

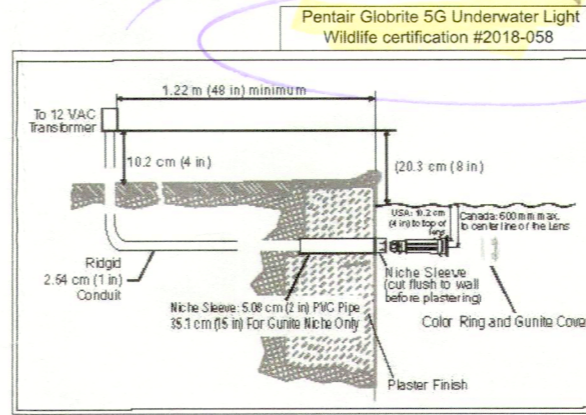

DEPARTMENT OF ENVIRONMENTAL PROTECTION
 APPROVED LIGHTING PLAN
 This approval is limited to the exterior lights depicted on the stamped plans. This approval does not relieve the applicant of the responsibility to obtain any other approvals or permits which may be required by Federal, State, County or Municipal law.
 Reviewed by: [Signature] Date: October 11, 2022

APPROVED PLAN AS PERMITTED
 BY THE OFFICE OF RESILIENCE AND COASTAL PROTECTION
 FLORIDA DEPARTMENT OF ENVIRONMENTAL PROTECTION
 APPROVED CONSTRUCTION AND ANY OTHER AUTHORIZED ACTIVITIES MUST COMPLY WITH ALL CONDITIONS OF THE PERMIT. CONSTRUCTION AND ACTIVITIES ARE STRICTLY LIMITED TO THOSE BOTH SHOWN ON THE APPROVED PLANS AND LISTED IN THE PROJECT DESCRIPTION. THIS PERMIT IS ISSUED PURSUANT TO CH. 161, F.S. AND OTHER PERMITS MAY BE REQUIRED.
 Reviewed by: [Signature] Date: October 11, 2022

RECEIVED
 July 18, 2022
 OFFICE OF RESILIENCE
 AND COASTAL PROTECTION
 ME-1451

General Notes

TOWN OF LONGBOAT KEY
 NOV 09 2022

SEAL
 Digitally signed by Tara N Sall
 Date: 2022.07.18 10:17:38 -04'00'

TARA N. SALL
 FLORIDA LICENSE NO. PE 90481

No.	Revision/Issue	Date

Firm Name and Address
 TNS DESIGN & CONSULTING, LLC
 1532 US HWY 41 BYP S.
 PMB 204
 VENICE, FLORIDA 34293
 941.586.0142
 tara@tnsdesignandconsulting.com

Project Name and Address
 HORTON RESIDENTIAL POOL
 6401 GULF OF MEXICO DRIVE
 LONGBOAT KEY, FLORIDA 34228
 FOR TOM SANGER POOL & SPA

Project	HORTON RESIDENTIAL POOL	Sheet	02
Date	7/14/2022	Scale	AS NOTED

BLDG PERMIT PLANS
 FILE COPY OF RECORD

#1 Engrg DEP

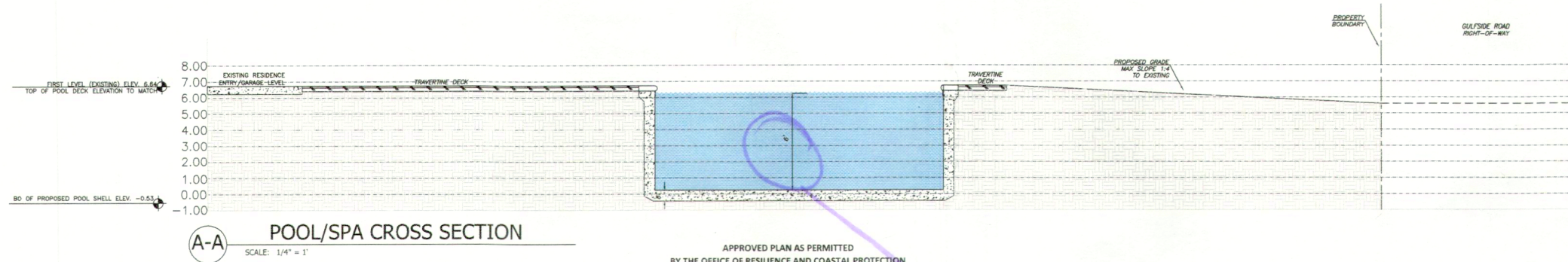

A-A POOL/SPA CROSS SECTION
SCALE: 1/4" = 1'

APPROVED PLAN AS PERMITTED
BY THE OFFICE OF RESILIENCE AND COASTAL PROTECTION
FLORIDA DEPARTMENT OF ENVIRONMENTAL PROTECTION
APPROVED CONSTRUCTION AND ANY OTHER AUTHORIZED ACTIVITIES MUST
COMPLY WITH ALL CONDITIONS OF THE PERMIT. CONSTRUCTION AND
ACTIVITIES ARE STRICTLY LIMITED TO THOSE BOTH SHOWN ON THE APPROVED
PLANS AND LISTED IN THE PROJECT DESCRIPTION. THIS PERMIT IS ISSUED
PURSUANT TO CH. 161, F.S. AND OTHER PERMITS MAY BE REQUIRED.

Reviewed by _____ Date October 11, 2022

#3

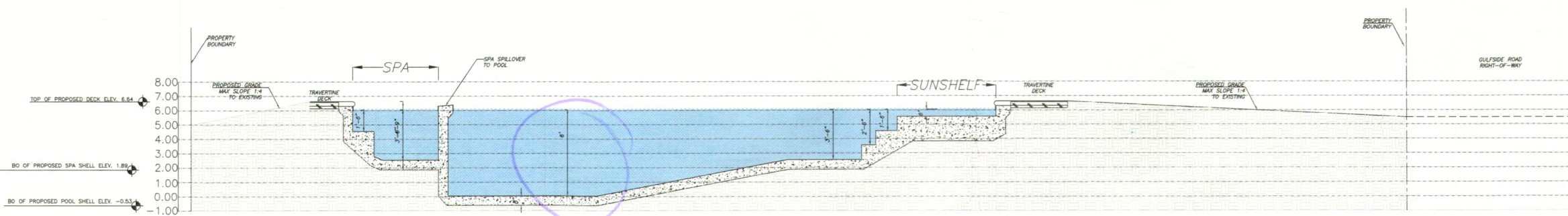

B-B POOL/SPA LONGITUDINAL SECTION
SCALE: 1/4" = 1'

#3

RECEIVED
July 18, 2022
OFFICE OF RESILIENCE
AND COASTAL PROTECTION
ME-1451

General Notes

RECEIVED
NOV 09 2022
TOWN OF LONGBOAT KEY
Planning, Zoning & Building

SEAL

Digitally signed by
Tara N Sall
Date:
2022.07.18
10:17:57
-04'00'

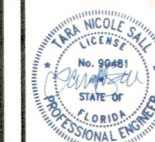

TARA N. SALL
FLORIDA LICENSE NO. PE 90481

No.	Revision/Issue	Date

Firm Name and Address
TNS DESIGN & CONSULTING, LLC
1532 US HWY 41 BYP S.
PMB 204
VENICE, FLORIDA 34293
941.586.0142
tara@tnsdesignandconsulting.com

Project Name and Address
HORTON RESIDENTIAL POOL
6401 GULF OF MEXICO DRIVE
LONGBOAT KEY, FLORIDA 34228
FOR
TOM SANGER POOL & SPA

Project	ORTON RESIDENTIAL POOL	Sheet	03
Date	7/14/2022	Scale	AS NOTED

BLDG. PERMIT PLANS
FILE COPY OF RECORD

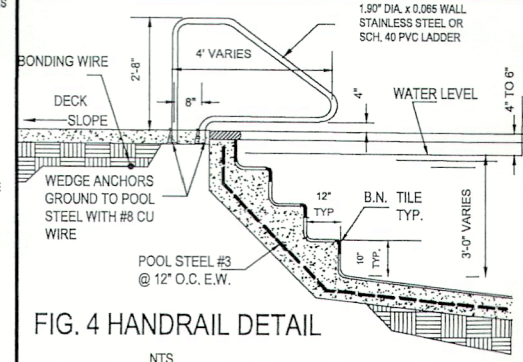
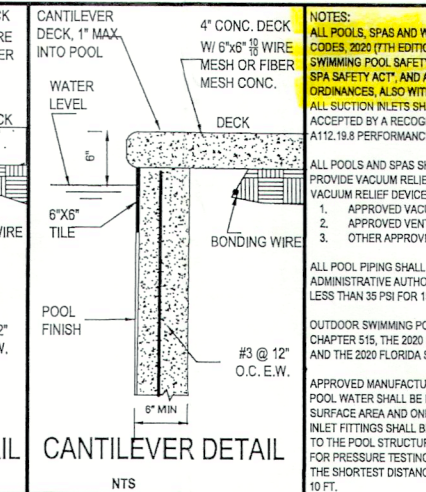
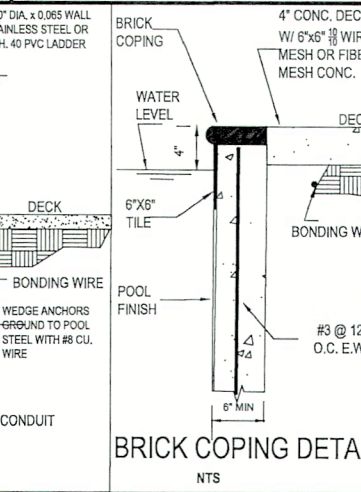
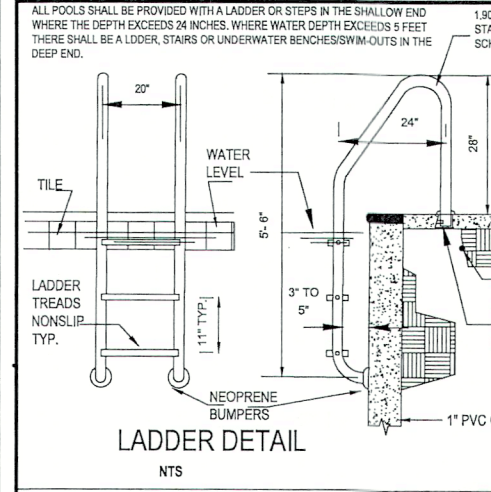
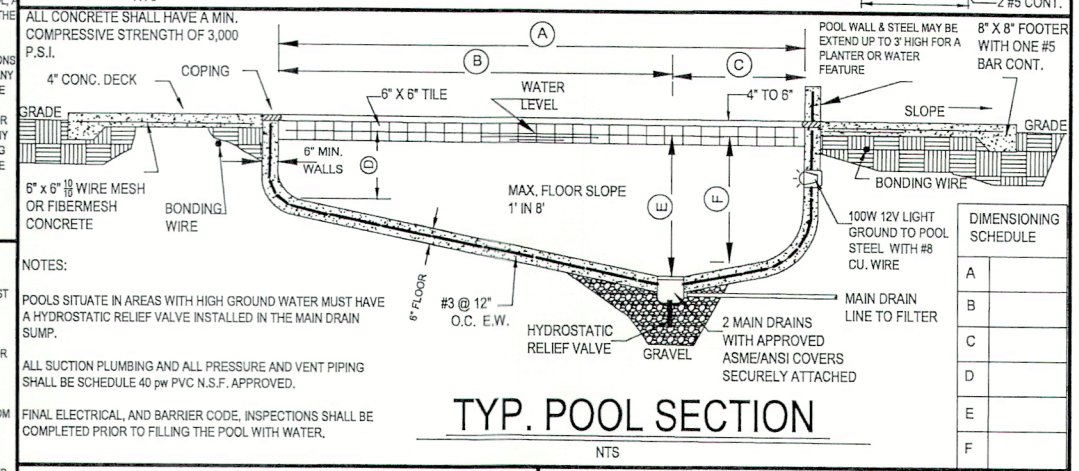
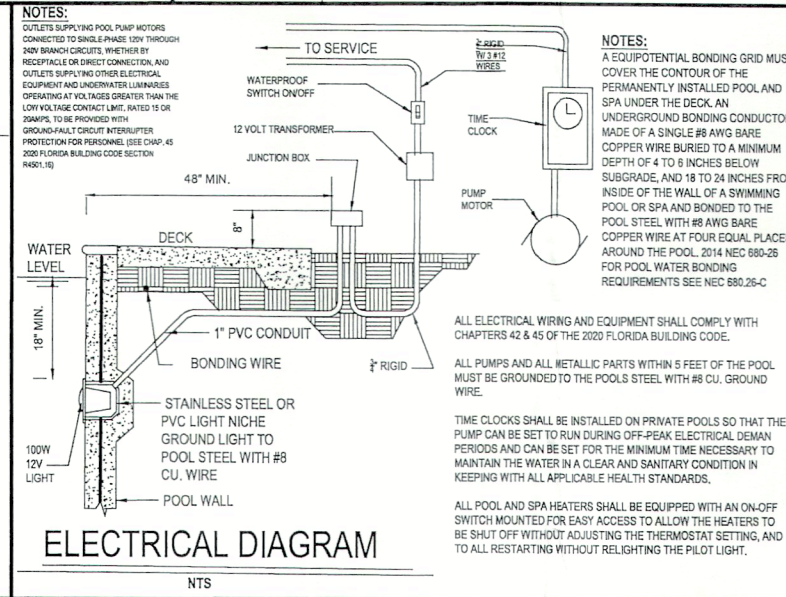
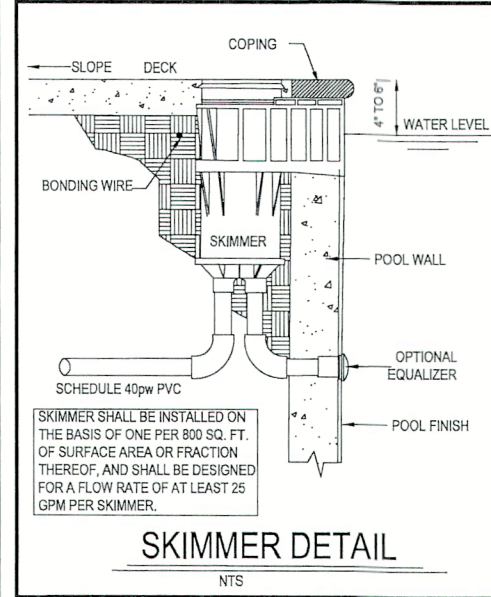
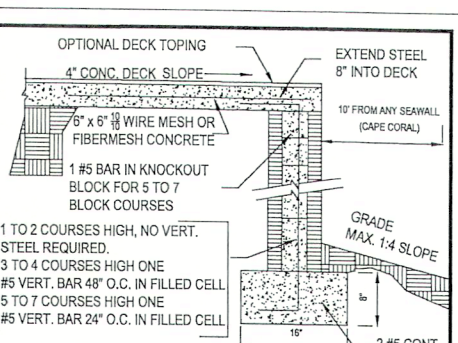
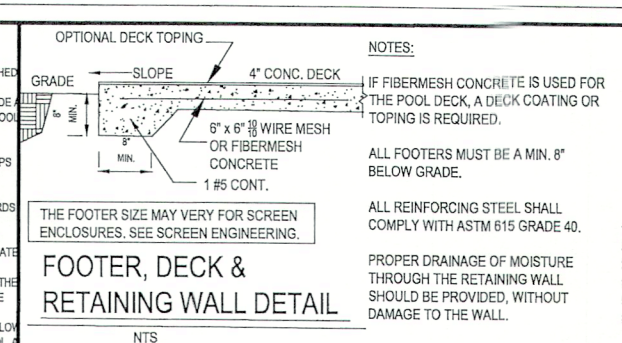
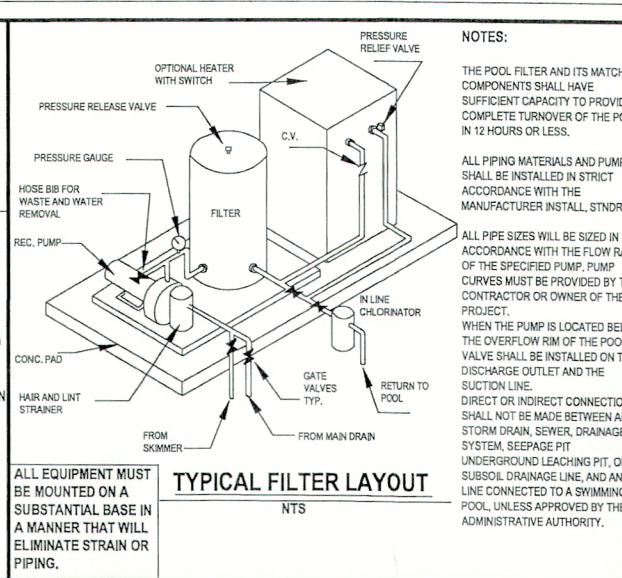
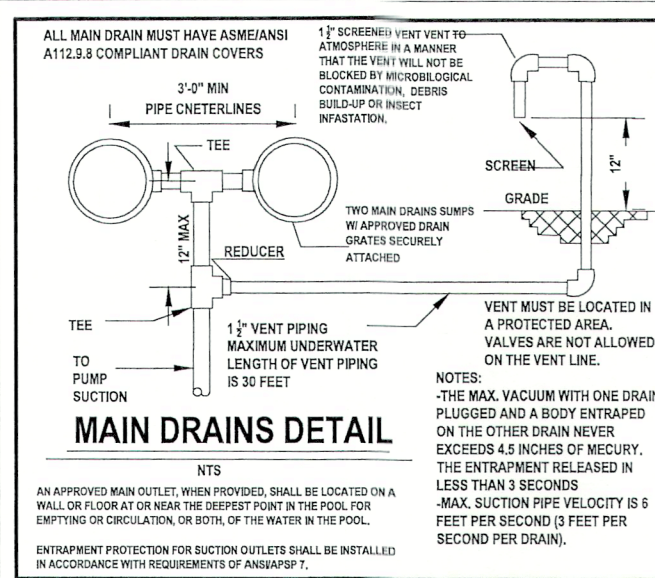

THE ENGINEER SHALL NOT BE HELD LIABLE FOR 1.) FAULTY MATERIALS AND CONSTRUCTION. 2.) INADEQUATE OR IMPROPER SUPERVISION OF CONSTRUCTION. 3.) IMPROPER POOL MAINTENANCE AFTER CONSTRUCTION. 4.) HYDROSTATIC UPLIFT OF THE POOL.

THESE PLANS ARE FOR RESIDENTIAL POOLS ONLY AND THEY MAY NOT BE USED FOR ANY COMMERCIAL POOL OR COMMERCIAL EXEMPT POOL. THESE PLANS ARE FOR THE EXPLICIT USE FOR THE BUILDER NAMED. NO OTHER BUILDER MAY USE THESE PLANS WITHOUT THE WRITTEN CONSENT FROM THE BUILDER AND TNS DESIGN & CONSULTING, LLC.



TNS DESIGN & CONSULTING, LLC
1532 US HWY 41 BYP S #204
VENICE, FL 34293
PHONE 941.586.0142
TARA@TNSDESIGNANDCONSULTING.COM
TARA N. SALL,
FLORIDA PE LICENSE NO. 90481

NOTES:
ALL POOLS, SPAS AND WADING POOLS SHALL CONFORM WITH THE FLORIDA BUILDING CODES, 2020 (7TH EDITION), ALSO WITH THE 2020 FLORIDA STATUTES, RESIDENTIAL SWIMMING POOL SAFETY ACT CHAPTER 515, THE VIRGINIA GRAHAM BAKER POOL AND SPA SAFETY ACT, AND ALL OTHER APPLICABLE CITY OR COUNTY CODES AND ORDINANCES, ALSO WITH FBC 2020 RESIDENTIAL 9022.3
ALL SUCTION INLETS SHALL BE PROVIDED WITH A COVER THAT HAS BEEN TESTED AND ACCEPTED BY A RECOGNIZED TESTING FACILITY AND COMPLY WITH ANS/APSP A112.19.8 PERFORMANCE STANDARDS.
ALL POOLS AND SPAS SHALL BE REQUIRED TO HAVE A BACKUP SYSTEM WHICH SHALL PROVIDE VACUUM RELIEF SHOULD THE GRATE COVERS BE MISSING. ALTERNATIVE VACUUM RELIEF DEVICES SHALL INCLUDE EITHER:
1. APPROVED VACUUM RELEASE SYSTEM
2. APPROVED VENT PIPING
3. OTHER APPROVED DEVICES OR MEANS
ALL POOL PIPING SHALL BE TESTED AND PROVED TIGHT TO THE SATISFACTION OF THE ADMINISTRATIVE AUTHORITY UNDER A STATIC WATER OR PRESSURE TEST OF NOT LESS THAN 35 PSI FOR 15 MINUTES.
OUTDOOR SWIMMING POOLS SHALL BE PROVIDED WITH A BARRIER COMPLYING WITH CHAPTER 515, THE 2020 FLORIDA STATUTES, RESIDENTIAL SWIMMING POOL SAFETY ACT AND THE 2020 FLORIDA STATE BUILDING CODE.
APPROVED MANUFACTURED INLET FITTINGS FOR THE RETURN OF RECIRCULATED POOL WATER SHALL BE PROVIDED ON THE BASIS OF AT LEAST ONE PER 300 SF OF SURFACE AREA AND ONE FOR EVERY 20 GPM OF THE RECIRCULATION RATE. SUCH INLET FITTINGS SHALL BE DESIGNED & CONSTRUCTED TO ENSURE AN ADEQUATE SEAL TO THE POOL STRUCTURE & SHALL INCORPORATE A CONVENIENT MEANS OF SEALING FOR PRESSURE TESTING OF THE PIPES. WHERE MORE THAN ONE INLET IS REQUIRED, THE SHORTEST DISTANCE BETWEEN ANY TWO REQUIRED INLETS SHALL BE AT LEAST 10 FT.
DESIGN, CONSTRUCTION AND WORKMANSHIP SHALL BE IN CONFORMANCE WITH THE REQUIREMENTS OF ANS/APSP "STANDARD FOR RESIDENTIAL SWIMMING POOLS" PUBLISHED BY THE NATIONAL SPA & POOL INSTITUTE (NSPI) OR OTHER ACCEPTED ENGINEERING PRACTICES.
ALL MATERIALS, PIPING, VALVES, EQUIPMENT OR APPLIANCES ENTERING INTO THE CONSTRUCTION OF SWIMMING POOLS OR PORTIONS THEREOF SHALL BE A TYPE THAT COMPLIES WITH BUILDING CODE OR OF A TYPE RECOMMENDED AND APPROVED BY A NATIONALLY RECOGNIZED TESTING AGENCY OR CONFORMS TO OTHER RECOGNIZED STANDARDS ACCEPTABLE TO THE ADMINISTRATIVE AUTHORITY.

ATMOSPHERIC VENT ARRANGEMENT COMPLIANT WITH 454.2.3 & 2020 FLORIDA BUILDING CODE PER NEC 680.26-4 POOL PUMP MOTORS MUST BE GFCI PROTECTED FOR POOL WATER BONDING REQUIREMENTS SEE NEC 880.26-C

THIS RESIDENTIAL POOL MASTER STRUCTURAL DESIGN IS ALLOWED IN ALL ZONES EXCEPT "X" ZONES, AND FOR A MAX WATER DEPTH OF 8'-0" AND FLOOR LOCATIONS UP TO 12'-6" FROM THE NEAREST WALL (20' WIDE WALL) CONSULT THE ENGINEER FOR THE DESIGN THAT EXCEEDS EITHER OF THESE DIMENSIONS PLEASE REFER TO 2020 FLORIDA BUILDING CODE RESIDENTIAL CHAPTERS 42 & 45 AND TO 2020 FLORIDA BUILDING CODE CONSERVATION SECTIONS 403.5.1 THROUGH 403.5.3 (SEE BELOW):

403.5.3 COVERS HEATED SWIMMING POOLS AND IN-GROUND PERMANENTLY INSTALLED SPAS SHALL BE EQUIPPED WITH A VAPOR-RETARDANT COVER OR ON AT THE WATER SURFACE OR A LIQUID COVER OR OTHER MEANS PROVEN TO REDUCE HEAT LOSS. EXCEPTION: OUTDOOR POOLS DERIVING OVER 70% OF THE ENERGY FOR HEATING FROM SITE-COVERED ENERGY OR SOLAR ENERGY SOURCE COMPUTED OVER AN OPERATING SEASON.
POOL FILTRATION PUMP MOTORS SHALL MEET THE FOLLOWING REQUIREMENTS:
1. POOL PUMP MOTORS SHALL NOT BE SPLIT-PHASE, SHADED POLE, OR CAPACITOR START INDUCTION TYPES.
2. POOL PUMPS AND MOTORS WITH A TOTAL HORSEPOWER GREATER THAN OR EQUAL TO 1 HP SHALL HAVE THE CAPABILITY OF OPERATING AT TWO OR MORE SPEEDS. THE LOW SPEED SHALL HAVE A ROTATION RATE OF NO MORE THAN 1/2 OF THE MOTOR'S MAXIMUM ROTATION RATE.
POOL PUMP CONTROLS SHALL HAVE THE CAPABILITY OF OPERATING THE POOL PUMP AT A MINIMUM OF TWO SPEEDS. THE DEFAULT CIRCULATION SPEED SHALL BE THE RESIDENTIAL FILTRATION SPEED WITH A HIGH SPEED OVERRIDE CAPABILITY FOR A TEMPORARY PERIOD NOT TO EXCEED ONE NORMAL CYCLE OR 24 HOURS, WHICHEVER IS LESS. EXCEPTION: SOLAR POOL HEATING SYSTEMS SHALL BE PERMITTED TO RUN AT HIGHER SPEEDS DURING PERIODS OF USABLE SOLAR HEAT GAIN.

MAXIMUM RATE THROUGH FILTERS	MAXIMUM WATER FLOWS IN PVC PIPE	
	PIPE SIZE	PRESSION @ 10 FPS SUCTION @ 8 FPS
RAPID SAND	5 GPM PER SF	50.6 GPM
DE	2 GPM PER SF	83.3 GPM
CARTRIDGE	1 GPM PER SF	119.3 GPM
	1 1/2"	181.5 GPM
	2"	317 GPM
	2 1/2"	
	3"	
	4"	

CONTRACTOR
TOM SANGER POOL & SPA, FL LIC. CPC-1458020
6010 CORTEZ ROAD WEST
BRADENTON, FL 34210

MUNICIPALITY
CITY OF LONG BOAT KEY

THESE PLANS MAY NOT BE REPRODUCED OR COPIED WITHOUT WRITTEN PERMISSION FROM TNS DESIGN & CONSULTING

SEAL
Digitally signed by Tara N Sall
Date: 2022.11.16 10:22:40 -05'00'

DRAWING NAME:
RESIDENTIAL POOL MASTER

SCALE: NTS

FILE NAME:
MASTERRP2022

DATE: 1.21.2022

SHEET 1 OF 1

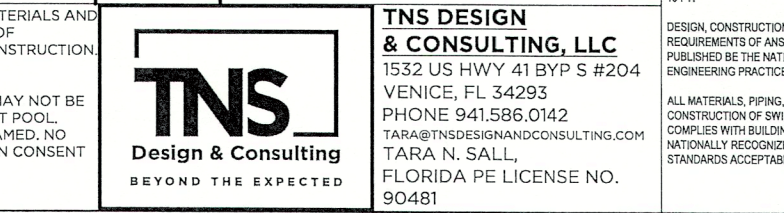
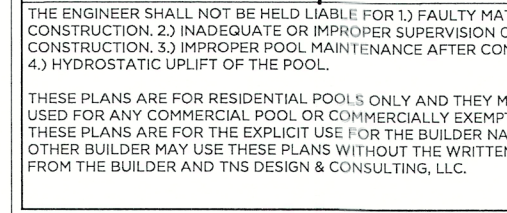
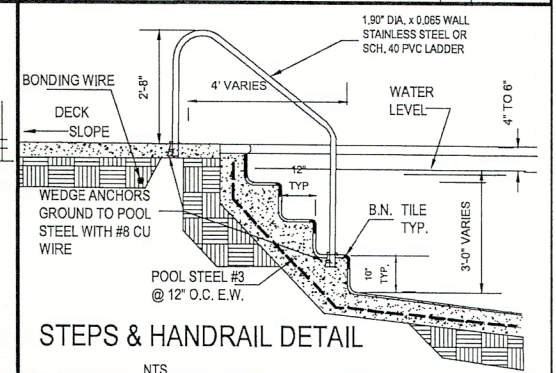
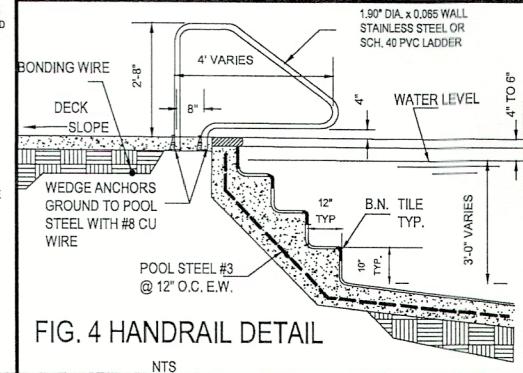
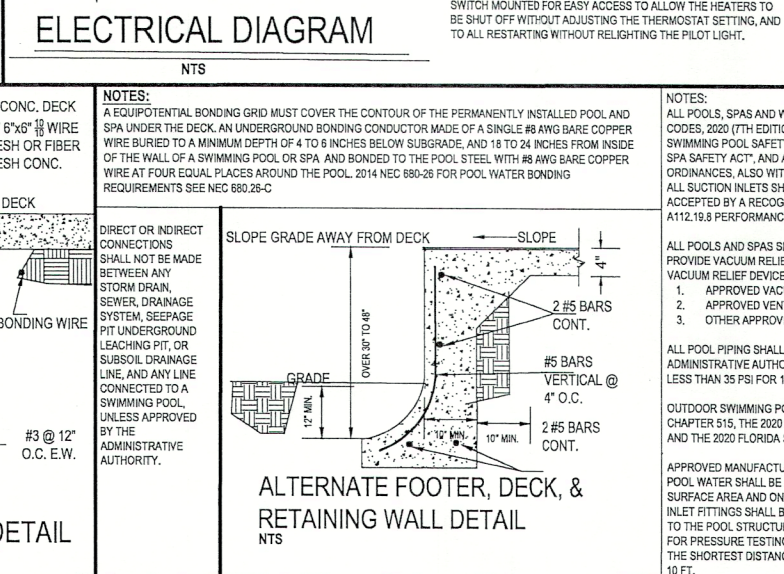
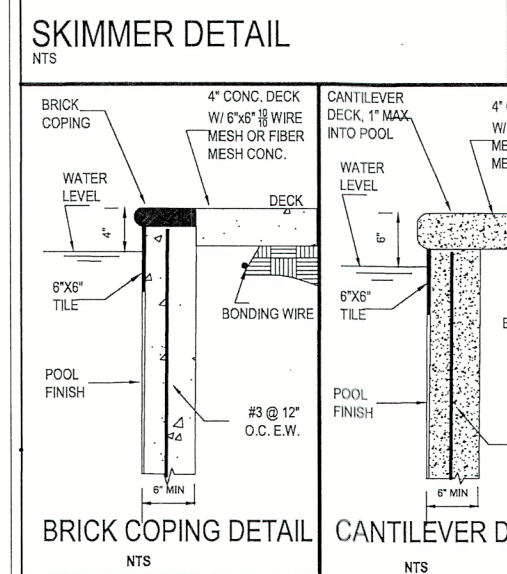
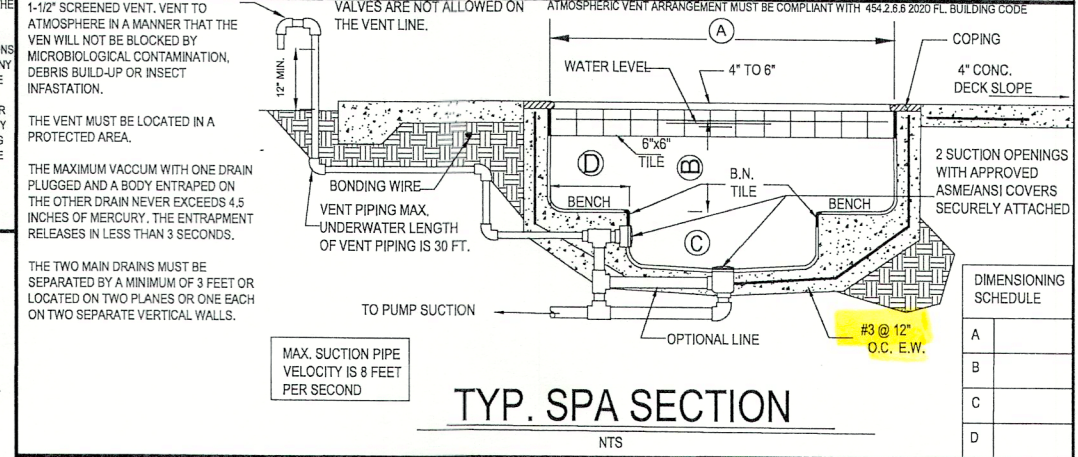
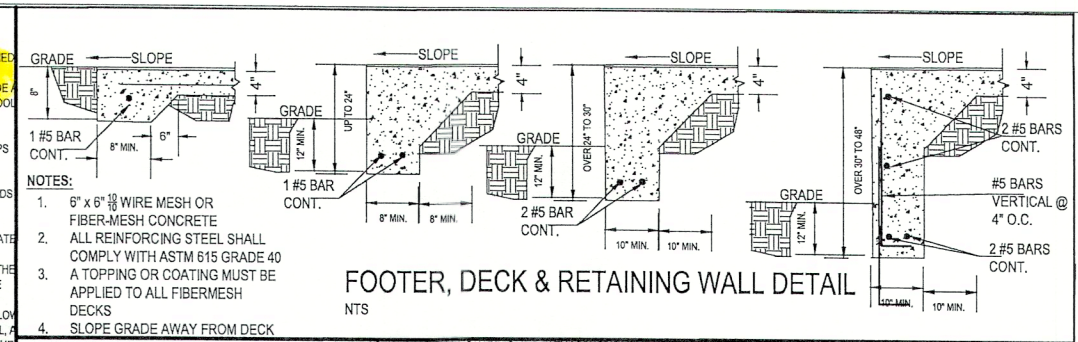
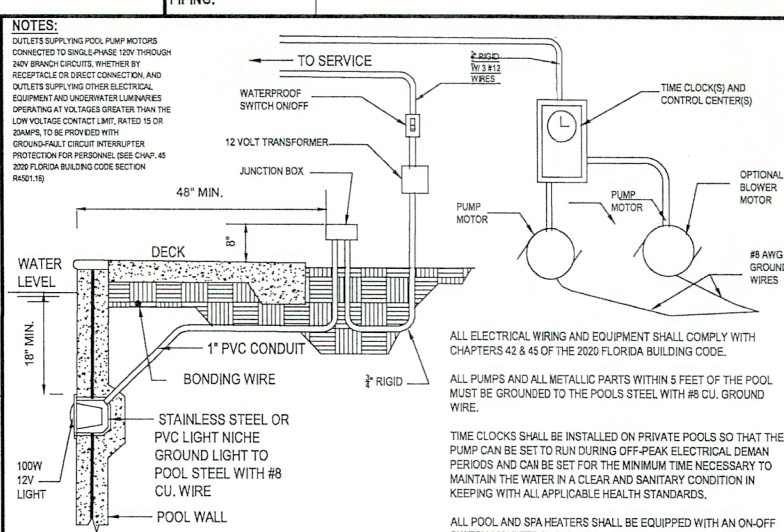
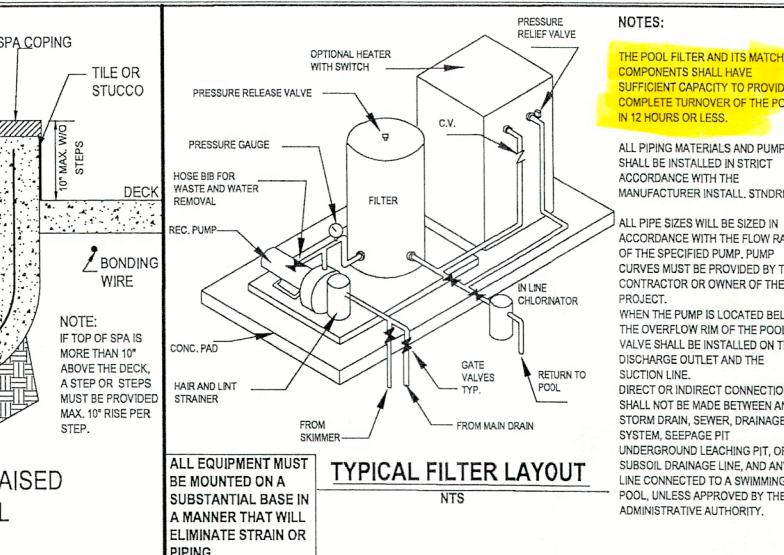
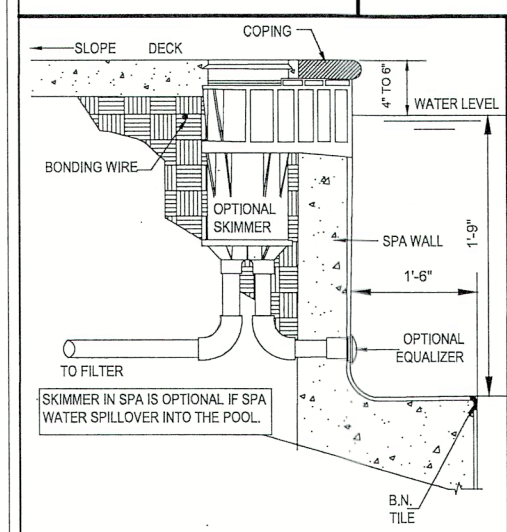
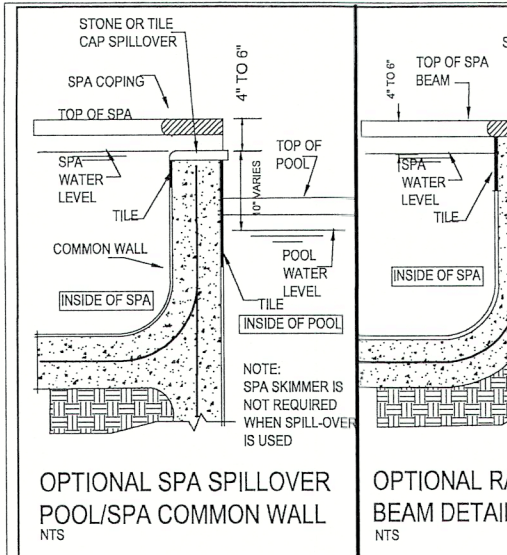

THE ENGINEER SHALL NOT BE HELD LIABLE FOR 1.) FAULTY MATERIALS AND CONSTRUCTION, 2.) INADEQUATE OR IMPROPER SUPERVISION OF CONSTRUCTION, 3.) IMPROPER POOL MAINTENANCE AFTER CONSTRUCTION, 4.) HYDROSTATIC UPLIFT OF THE POOL.

THESE PLANS ARE FOR RESIDENTIAL POOLS ONLY AND THEY MAY NOT BE USED FOR ANY COMMERCIAL POOL OR COMMERCIAL EXEMPT POOL. THESE PLANS ARE FOR THE EXPLICIT USE FOR THE BUILDER NAMED. NO OTHER BUILDER MAY USE THESE PLANS WITHOUT THE WRITTEN CONSENT FROM THE BUILDER AND TNS DESIGN & CONSULTING, LLC.

TNS
Design & Consulting
BEYOND THE EXPECTED

TNS DESIGN & CONSULTING, LLC
1532 US HWY 41 BYP S #204
VENICE, FL 34293
PHONE 941.586.0142
TARA@TNSDESIGNANDCONSULTING.COM
TARA N. SALL,
FLORIDA PE LICENSE NO. 90481

ATMOSPHERIC VENT ARRANGEMENT COMPLIANT WITH 454.2.6 & 2020 FLORIDA BUILDING CODE PER REC 680.26-2. POOL PUMP MOTORS MUST BE GFCI PROTECTED FOR POOL WATER BONDING REQUIREMENTS SEE REC 680.26-2.

THIS RESIDENTIAL POOL MASTER STRUCTURAL DESIGN IS ALLOWED IN ALL ZONES EXCEPT "Y" ZONES, AND FOR A MAX WATER DEPTH OF 8'-0" AND FLOOR LOCATIONS UP TO 12'-4" FROM THE NEAREST WALL OR WIDE MAJ CONSULT THE ENGINEER FOR THE DESIGN OF THESE DIMENSIONS. PLEASE REFER TO 2020 FLORIDA BUILDING CODE RESIDENTIAL CHAPTERS 42 & 45 AND TO 2020 FLORIDA BUILDING CODE CONSERVATION SECTIONS 403.9.1 THROUGH 403.9.3 (SEE BELOW).

403.9.3 COVERS HEATED SWIMMING POOLS AND IN-GROUND PERMANENTLY INSTALLED SPAS SHALL BE EQUIPPED WITH A VAPOR-RETARDANT COVER ON OR AT THE WATER SURFACE OR A LIQUID COVER OR OTHER MEANS PROVEN TO REDUCE HEAT LOSS, EXCEPT FOR OUTDOOR POOLS DERIVING OVER 70% OF THE ENERGY FOR HEATING FROM SITE-COVERED ENERGY OR SOLAR ENERGY SOURCE COMPLETED OVER AN OPERATING SEASON.

POOL FILTRATION PUMP MOTORS SHALL MEET THE FOLLOWING REQUIREMENTS:

- POOL PUMP MOTORS SHALL NOT BE SPLIT-PHASE, SHADED POLE, OR CAPACITOR START INDUCTION TYPES.
- POOL PUMPS AND MOTORS WITH A TOTAL HORSEPOWER GREATER THAN OR EQUAL TO 1 HP SHALL HAVE THE CAPABILITY OF OPERATING AT TWO OR MORE SPEEDS.
- THE LOW SPEED SHALL HAVE A ROTATION RATE OF NO MORE THAN 3 OF THE MOTOR'S MAXIMUM ROTATION RATE.

POOL PUMP CONTROLS SHALL HAVE THE CAPABILITY OF OPERATING THE POOL PUMP AT A MINIMUM OF TWO SPEEDS. THE DEFAULT CIRCULATION SPEED SHALL BE THE RESIDENTIAL FILTRATION SPEED WITH A HIGH SPEED OVERRIDE CAPABILITY FOR A TEMPORARY PERIOD NOT TO EXCEED ONE NORMAL CYCLE OR 24 HOURS, WHICHEVER IS LESS. EXCEPTION: SOLAR POOL HEATING SYSTEMS SHALL BE PERMITTED TO RUN AT HIGHER SPEEDS DURING PERIODS OF USABLE SOLAR HEAT GAIN.

MAXIMUM RATE THROUGH FILTERS	MAXIMUM WATER FLOWS IN PVC PIPE	
	PIPE SIZE	PRESSION @ 10 FPS / SUCTION @ 5 FPS
RAPID SAND	5 GPM PER SF	65.3 GPM / 50.5 GPM
DE	2 GPM PER SF	134 GPM / 83.3 GPM
CARTRIDGE	1 GPM PER SF	149 GPM / 119.3 GPM
		227 GPM / 181.5 GPM
		395 GPM / 317 GPM

THESE PLANS PREPARED UNDER THE DIRECTION OF TARA N. SALL, PE
TNS DESIGN & CONSULTING, LLC,
1532 US HWY 41 BYP S, #204
VENICE, FLORIDA 34293
FL LICENSE # 90481

CONTRACTOR
TOM SANGER POOL & SPA, FL LIC. CPC-1458020
6010 CORTEZ ROAD WEST
BRADENTON, FL 34210

MUNICIPALITY
CITY OF LONG BOAT KEY

THESE PLANS MAY NOT BE REPRODUCED OR COPIED WITHOUT WRITTEN PERMISSION FROM TNS DESIGN & CONSULTING

SCALE: NTS
DRAWN BY: TNS
CHECKED BY: TNS
DATE: 1.21.2022

DRAWING NAME:
RESIDENTIAL SPA MASTER

DRAWING NAME:
MASTERRspa2021-01

DATE: 1.21.2022

SHEET 1 OF 1



BLDG PERMIT PLANS
FILE COPY OF RECORD

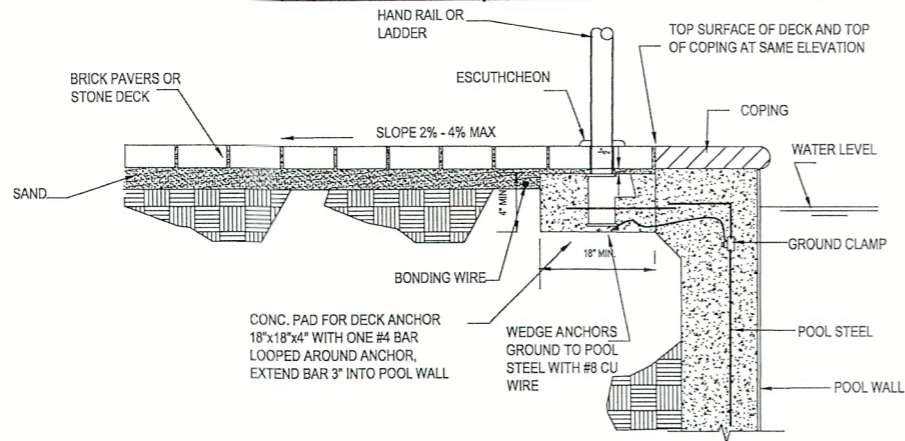

DECK AND DECK ANCHOR DETAIL
NTS

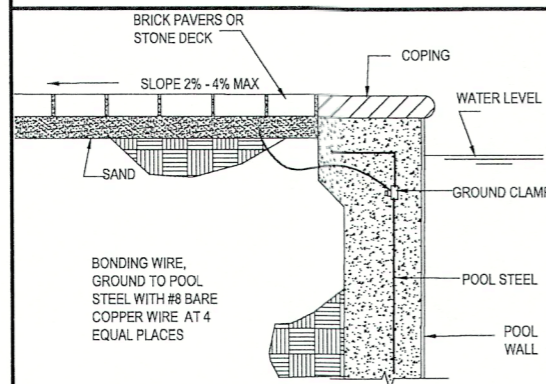

COPPER BONDING GRID

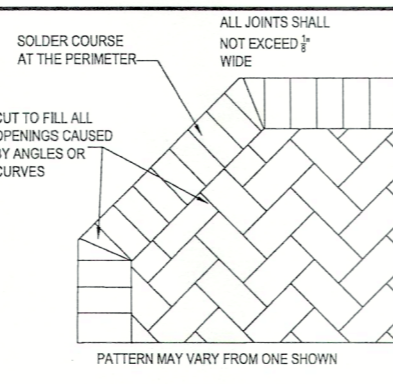

PATTERN DETAIL

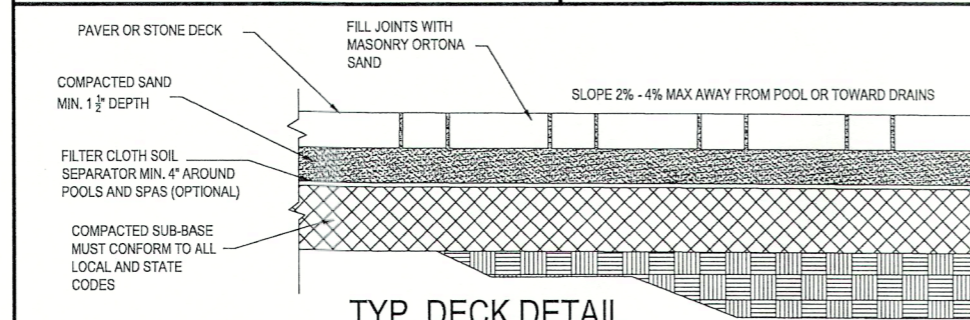

TYP. DECK DETAIL

THIS SPACE INTENTIONALLY LEFT BLANK

1 TO 2 COURSES HIGH (UP TO 16" HIGH)
1 #5 VERTICAL REBAR AT 72" O.C. AND AT ALL CORNERS AND ENDS. TOP COURSE TO BE AN 8"x8" KNOCKOUT BLOCK BLOCKS WITH 1 #5 HORIZONTAL REBAR OR AN 8"x8" FORMED AND POURED CAP WITH 1 #5 HORIZONTAL REBAR.

3 TO 4 COURSES HIGH (UP TO 32" HIGH)
1 #5 VERTICAL REBAR AT 48" O.C. AND AT ALL CORNERS AND ENDS. TOP COURSE TO BE AN 8"x8" KNOCKOUT BLOCK BLOCKS WITH 1 #5 HORIZONTAL REBAR OR AN 8"x8" FORMED AND POURED CAP WITH 1 #5 HORIZONTAL REBAR.

5 TO 7 COURSES HIGH (UP TO 56" HIGH)
1 #5 VERTICAL REBAR AT 24" O.C. AND AT ALL CORNERS AND ENDS. TOP 2 COURSES TO BE AN 8"x8" KNOCKOUT BLOCK BLOCKS WITH 1 #5 HORIZONTAL REBAR IN EACH KNOCKOUT BLOCK OR AN 8"x16" FORMED AND POURED CAP WITH 1 #5 HORIZONTAL REBAR. ONE TOP ONE BOTTOM.

ALL REINFORCING STEEL SHALL COMPLY WITH A.S.T.M. 615 GRADE 40.

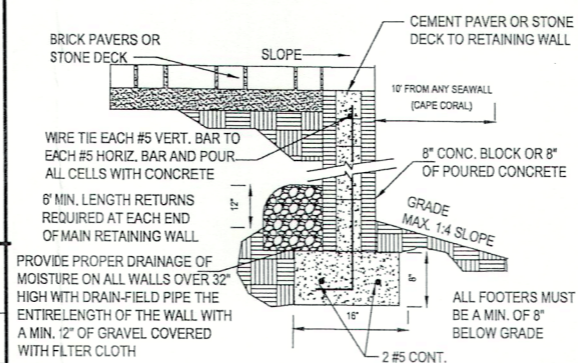

RETAINING WALL DETAIL
NTS

- NOTES:
- EXCAVATE UNSUITABLE, UNSTABLE, ORGANIC, OR UNCONSOLIDATED SUB-GRADE MATERIAL AND COMPACT THE AREA WHICH HAS BEEN CLEARED. THEN BACKFILL AND LEVEL WITH DENSE GRADE AGGREGATE SUITABLE FOR SUBBASE MATERIAL.
 - THE CONTRACTOR SHALL FIELD VERIFY ALL OMISSIONS AND NOTIFY THE ENGINEER OF ANY DEVIATIONS FROM THE PLANS OR CONFLICT WITH ONSITE CONDITIONS.
 - THE FINISHED DECK SHALL NOT HAVE VOIDS THAT EXCEED 1/8" AND HAVE NO SHARP EDGES.
 - ALL JOINTS SHALL BE FILLED WITH MASONRY ORTONA SAND.
 - THE DECK SHALL SLOPE AT A MIN. 2% TO A MAX. 4% AWAY FROM THE POOL OR TOWARD THE DECK DRAINS.
 - ALL CONSTRUCTION SHALL BE IN ACCORDANCE WITH STATE AND LOCAL CODES.
 - THE DECK MAY BE SEALED WITH A RECOMMENDED DEEP-PENETRATION PAVER SEALANT. (CHECK WITH MANUFACTURER AND HEALTH DEPARTMENT.)
 - THE ENGINEER SHALL NOT BE HELD LIABLE FOR FAULTY MATERIALS AND INSTALLATION, IMPROPER SUBBASE, AND IMPROPER MAINTENANCE OF THE DECK.
 - THE DECK SHALL CONFORM WITH THE FLORIDA BUILDING CODES, 2020 (7TH EDITION) AND WITH ALL APPLICABLE CITY AND/OR COUNTY ORDINANCES AND CODES.
 - A EQUIPOTENTIAL BONDING GRID MUST COVER THE CONTOUR OF THE PERMANENTLY INSTALLED POOL AND SPA UNDER THE DECK. AN UNDERGROUND BONDING CONDUCTOR MADE A SINGLE #8 AWG BARE COPPER WIRE BURIED TO A MINIMUM DEPTH OF 4 TO 6 INCHES BELOW SUBGRADE, AND 18 TO 24 INCHES FROM INSIDE OF THE WALL OF A RESIDENTIAL SWIMMING POOL OR SPA AND BONDED TO THE POOL STEEL WITH #8 AWG BARE COPPER WIRE AT FOUR EQUAL PLACES AROUND THE POOL. FOR POOL WATER BONDING SEE NEC 680.26-C
 - PER NEC680.22-B POOL PUMP MOTORS MUST BE GFI PROTECTED.

THE ENGINEER SHALL NOT BE HELD LIABLE FOR 1.) FAULTY MATERIALS AND CONSTRUCTION. 2.) INADEQUATE OR IMPROPER SUPERVISION OF CONSTRUCTION. 3.) IMPROPER POOL MAINTENANCE AFTER CONSTRUCTION. 4.) HYDROSTATIC UPLIFT OF THE POOL.

THESE PLANS ARE FOR RESIDENTIAL POOLS ONLY AND THEY MAY NOT BE USED FOR ANY COMMERCIAL POOL OR COMMERCIAL EXEMPT POOL. THESE PLANS ARE FOR THE EXPLICIT USE FOR THE BUILDER NAMED. NO OTHER BUILDER MAY USE THESE PLANS WITHOUT THE WRITTEN CONSENT FROM THE BUILDER AND TNS DESIGN & CONSULTING, LLC.



TNS DESIGN & CONSULTING, LLC
1532 US HWY 41 BYP S #204
VENICE, FL 34293
PHONE 941.586.0142
TARA@TNSDESIGNANDCONSULTING.COM
TARA N. SALL,
FLORIDA PE LICENSE NO. 90481

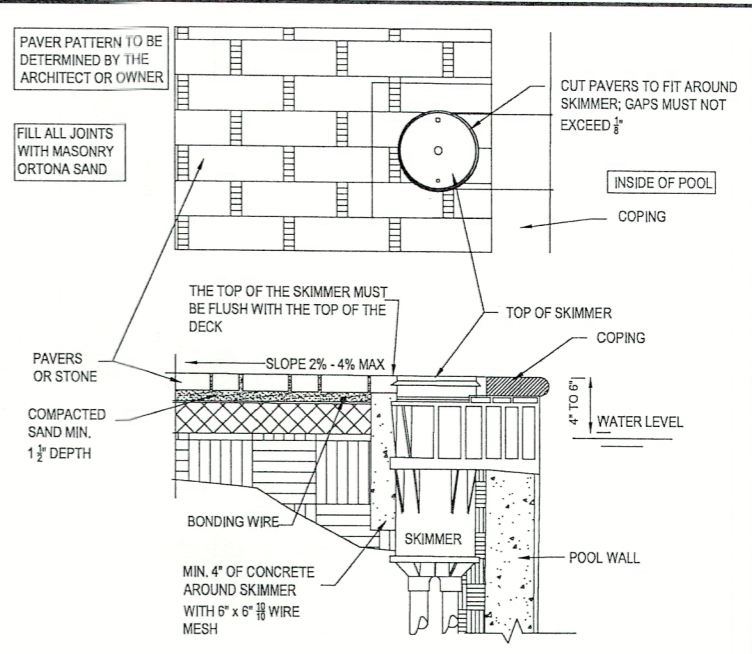

SKIMMER DETAIL
NTS

NOTE:
IF DRAINS ARE REQUIRED IN THE DECK, 4" ROUND OR DECK-O-DRAINS MAY BE USED. PLACED AT 12" O.C. MAX. BETWEEN THE POOL AND THE BUILDING WITH THE DECK SLOPING 2% MIN TO 4% MAX TOWARD THE DRAINS.

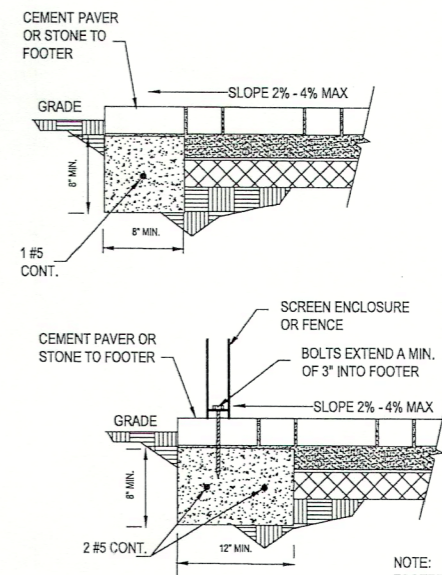

DECK EDGE DETAIL
NTS

NOTE:
FOOTER DIMENSION FOR SCREEN ENCLOSURES MAY BE DIFFERENT THAN THE ONE SHOWN. SEE SCREEN ENCLOSURE DRAWINGS.

CONTRACTOR
TOM SANGER POOL & SPA, FL LIC. CPC-1458020
6010 CORTEZ ROAD WEST
BRADENTON, FL 34210

MUNICIPALITY
CITY OF LONG BOAT KEY

THESE PLANS MAY NOT BE REPRODUCED OR COPIED WITHOUT WRITTEN PERMISSION FROM TNS DESIGN & CONSULTING

SEAL
Digitally signed by Tara N Sall
Date: 2022.11.16 10:23:22 -05'00'

DRAWING NAME: MASTER PAVER OR STONE DECK		SCALE: NTS	DRAWING NAME: MASTERRpsd2022-01
DATE: 1.21.2022	CHECKED BY: TNS	DRAWN BY: TNS	

DATE: 1.21.2022	CHECKED BY: TNS	DRAWN BY: TNS	
-----------------	-----------------	---------------	--

BLDG PERMIT PLANS
FILE COPY OF RECORD

