

ELEVATION CERTIFICATE

Important: Read the instructions on pages 1-9.

OMB No. 1660-0008
 Expiration Date: July 31, 2015

SECTION A - PROPERTY INFORMATION

FOR INSURANCE COMPANY USE

A1. Building Owner's Name Thomas G. & Bonnie J. Geyman
 A2. Building Street Address (including Apt., Unit, Suite, and/or Bldg. No.) or P.O. Route and Box No.
3309 Sabal Cove Circle
 City Longboat Key State FL ZIP Code 34228

Policy Number:
 Company NAIC Number:

A3. Property Description (Lot and Block Numbers, Tax Parcel Number, Legal Description, etc.)
Lot 4, Blk B- Sabal Cove Sub. Tax ID # 0004-13-0001

A4. Building Use (e.g., Residential, Non-Residential, Addition, Accessory, etc.) Residential
 A5. Latitude/Longitude: Lat. 27°22'39.7" Long. 82°37'29.83" Horizontal Datum: NAD 1927 NAD 1983

A6. Attach at least 2 photographs of the building if the Certificate is being used to obtain flood insurance.

A7. Building Diagram Number 7

A8. For a building with a crawlspace or enclosure(s):
 a) Square footage of crawlspace or enclosure(s) 1393 sq ft
 b) Number of permanent flood openings in the crawlspace or enclosure(s) within 1.0 foot above adjacent grade 8
 c) Total net area of flood openings in A8.b 1600 sq in
 d) Engineered flood openings? Yes No

A9. For a building with an attached garage:
 a) Square footage of attached garage N/A sq ft
 b) Number of permanent flood openings in the attached garage within 1.0 foot above adjacent grade N/A
 c) Total net area of flood openings in A9.b N/A sq in
 d) Engineered flood openings? Yes No

SECTION B - FLOOD INSURANCE RATE MAP (FIRM) INFORMATION

B1. NFIP Community Name & Community Number <u>Town of Longboat Key 125126</u>		B2. County Name <u>Sarasota</u>		B3. State <u>FL</u>	
B4. Map/Panel Number <u>125126-0010</u>	B5. Suffix <u>B</u>	B6. FIRM Index Date <u>5.18.92</u>	B7. FIRM Panel Effective/Revised Date <u>4.20.1970/8.15.1983</u>	B8. Flood Zone(s) <u>A13</u>	B9. Base Flood Elevation(s) (Zone AO, use base flood depth) <u>11</u>

B10. Indicate the source of the Base Flood Elevation (BFE) data or base flood depth entered in Item B9.

FIS Profile FIRM Community Determined Other/Source: _____

B11. Indicate elevation datum used for BFE in Item B9: NGVD 1929 NAVD 1988 Other/Source: _____

B12. Is the building located in a Coastal Barrier Resources System (CBRS) area or Otherwise Protected Area (OPA)? Yes No
 Designation Date: _____ CBRS OPA

SECTION C - BUILDING ELEVATION INFORMATION (SURVEY REQUIRED)

C1. Building elevations are based on: Construction Drawings* Building Under Construction* Finished Construction
 *A new Elevation Certificate will be required when construction of the building is complete.

C2. Elevations - Zones A1-A30, AE, AH, A (with BFE), VE, V1-V30, V (with BFE), AR, AR/A, AR/AE, AR/A1-A30, AR/AH, AR/AO. Complete Items C2.a-h below according to the building diagram specified in Item A7. In Puerto Rico only, enter meters.

Benchmark Utilized: NGS W-92 Vertical Datum: NGVD29

Indicate elevation datum used for the elevations in items a) through h) below. NGVD 1929 NAVD 1988 Other/Source: _____
 Datum used for building elevations must be the same as that used for the BFE.

Check the measurement used.

a) Top of bottom floor (including basement, crawlspace, or enclosure floor)	<u>6.5</u>	<input checked="" type="checkbox"/> feet <input type="checkbox"/> meters
b) Top of the next higher floor	<u>13.2</u>	<input checked="" type="checkbox"/> feet <input type="checkbox"/> meters
c) Bottom of the lowest horizontal structural member (V Zones only)	<u>N/A</u>	<input type="checkbox"/> feet <input type="checkbox"/> meters
d) Attached garage (top of slab)	<u>N/A</u>	<input type="checkbox"/> feet <input type="checkbox"/> meters
e) Lowest elevation of machinery or equipment servicing the building (Describe type of equipment and location in Comments)	<u>12.8</u>	<input checked="" type="checkbox"/> feet <input type="checkbox"/> meters
f) Lowest adjacent (finished) grade next to building (LAG)	<u>6.2</u>	<input checked="" type="checkbox"/> feet <input type="checkbox"/> meters
g) Highest adjacent (finished) grade next to building (HAG)	<u>7.0</u>	<input checked="" type="checkbox"/> feet <input type="checkbox"/> meters
h) Lowest adjacent grade at lowest elevation of deck or stairs, including structural support	<u>6.1</u>	<input checked="" type="checkbox"/> feet <input type="checkbox"/> meters

SECTION D - SURVEYOR, ENGINEER, OR ARCHITECT CERTIFICATION

This certification is to be signed and sealed by a land surveyor, engineer, or architect authorized by law to certify elevation information. I certify that the information on this Certificate represents my best efforts to interpret the data available. I understand that any false statement may be punishable by fine or imprisonment under 18 U.S. Code, Section 1001.

Check here if comments are provided on back of form. Were latitude and longitude in Section A provided by a licensed land surveyor? Yes No
 Check here if attachments.

Certifier's Name F. Peter Lutz, Jr. License Number 5506
 Title Reg. Land Surveyor Company Name George F. Young, Inc.
 Address 10540 Portal Crossing, #105 City Bradenton State FL ZIP Code 34211
 Signature [Signature] Date 02.20.14 Telephone 941-747-2981

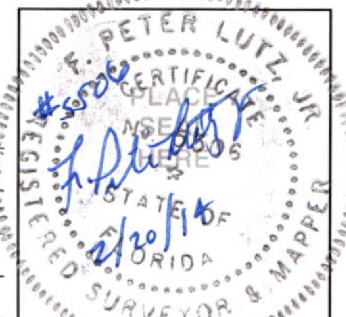

RECEIVED
 APR 29 2014
 TOWN OF LONGBOAT KEY

IMPORTANT: In these spaces, copy the corresponding information from Section A.	FOR INSURANCE COMPANY USE
Building Street Address (including Apt., Unit, Suite, and/or Bldg. No.) or P.O. Route and Box No. 3309 Sabal Cove Cir.	Policy Number:
City Longboat Key State FL ZIP Code	Company NAIC Number:

SECTION D – SURVEYOR, ENGINEER, OR ARCHITECT CERTIFICATION (CONTINUED)

Copy both sides of this Elevation Certificate for (1) community official, (2) insurance agent/company, and (3) building owner.

Comments A5) Obtained from "Google Earth", Item- A8) there are 6 "SmartVents" in the Garage doors of the lower level and 2 "Smart Vents" in the side wall of the lower level, Item C2e) was the bottom of the elevated A/C platform. The main living portion of the building was constructed upon a Stemwall foundation and backfilled. The enclosed area per Item C2a) is to be used for storage & parking.

F. Pete Lutz Jr

Signature _____ Date 02.20.14

SECTION E – BUILDING ELEVATION INFORMATION (SURVEY NOT REQUIRED) FOR ZONE AO AND ZONE A (WITHOUT BFE)

For Zones AO and A (without BFE), complete Items E1–E5. If the Certificate is intended to support a LOMA or LOMR-F request, complete Sections A, B, and C. For Items E1–E4, use natural grade, if available. Check the measurement used. In Puerto Rico only, enter meters.

- E1. Provide elevation information for the following and check the appropriate boxes to show whether the elevation is above or below the highest adjacent grade (HAG) and the lowest adjacent grade (LAG).
 - a) Top of bottom floor (including basement, crawlspace, or enclosure) is _____ feet meters above or below the HAG.
 - b) Top of bottom floor (including basement, crawlspace, or enclosure) is _____ feet meters above or below the LAG.
- E2. For Building Diagrams 6–9 with permanent flood openings provided in Section A Items 8 and/or 9 (see pages 8–9 of Instructions), the next higher floor (elevation C2.b in the diagrams) of the building is _____ feet meters above or below the HAG.
- E3. Attached garage (top of slab) is _____ feet meters above or below the HAG.
- E4. Top of platform of machinery and/or equipment servicing the building is _____ feet meters above or below the HAG.
- E5. Zone AO only: If no flood depth number is available, is the top of the bottom floor elevated in accordance with the community's floodplain management ordinance? Yes No Unknown. The local official must certify this information in Section G.

SECTION F – PROPERTY OWNER (OR OWNER'S REPRESENTATIVE) CERTIFICATION

The property owner or owner's authorized representative who completes Sections A, B, and E for Zone A (without a FEMA-issued or community-issued BFE) or Zone AO must sign here. The statements in Sections A, B, and E are correct to the best of my knowledge.

Property Owner's or Owner's Authorized Representative's Name _____

Address _____ City _____ State _____ ZIP Code _____

Signature _____ Date _____ Telephone _____

Comments _____

Check here if attachments.

SECTION G – COMMUNITY INFORMATION (OPTIONAL)

The local official who is authorized by law or ordinance to administer the community's floodplain management ordinance can complete Sections A, B, C (or E), and G of this Elevation Certificate. Complete the applicable item(s) and sign below. Check the measurement used in Items G8–G10. In Puerto Rico only, enter meters.

- G1. The information in Section C was taken from other documentation that has been signed and sealed by a licensed surveyor, engineer, or architect who is authorized by law to certify elevation information. (Indicate the source and date of the elevation data in the Comments area below.)
- G2. A community official completed Section E for a building located in Zone A (without a FEMA-issued or community-issued BFE) or Zone AO.
- G3. The following information (Items G4–G10) is provided for community floodplain management purposes.

G4. Permit Number	G5. Date Permit Issued	G6. Date Certificate Of Compliance/Occupancy Issued
-------------------	------------------------	---

- G7. This permit has been issued for: New Construction Substantial Improvement
- G8. Elevation of as-built lowest floor (including basement) of the building: _____ feet meters Datum _____
- G9. BFE or (in Zone AO) depth of flooding at the building site: _____ feet meters Datum _____
- G10. Community's design flood elevation: _____ feet meters Datum _____

Local Official's Name *Darin D. Cushing* Title *Building Official*

Community Name *Town of Longboat Key* Telephone *941-376-1966*

Signature *D. D. Cushing* Date *12-12-14*

Comments *B7 HAD EXTRA DATE - TYPO*

RECEIVED
APR 29 2014
 TOWN OF LONGBOAT KEY
 Planning, Zoning and Building

Check here if attachments.

Building Photographs

See Instructions for Item A6.

IMPORTANT: In these spaces, copy the corresponding information from Section A.

Building Street Address (including Apt., Unit, Suite, and/or Bldg. No.) or P.O. Route and Box No.
309 Sabal Cove Cir.

City Longboat Key

State FL

ZIP Code 34228

FOR INSURANCE COMPANY USE

Policy Number:

Company NAIC Number:

If using the Elevation Certificate to obtain NFIP flood insurance, affix at least 2 building photographs below according to the instructions for Item A6. Identify all photographs with date taken; "Front View" and "Rear View"; and, if required, "Right Side View" and "Left Side View." When applicable, photographs must show the foundation with representative examples of the flood openings or vents, as indicated in Section A8. If submitting more photographs than will fit on this page, use the Continuation Page.

Front View 02.20.14



Side View 02.20.14



RECEIVED
APR 29 2014
TOWN OF LONGBOAT KEY
Planning, Zoning and Building

DIAGRAM 7

All buildings elevated on full-story foundation walls with a partially or fully enclosed area below the elevated floor. This includes walkout levels, where at least one side is at or above grade. The principal use of this building is located in the elevated floors of the building.

Distinguishing Feature – For all zones, the area below the elevated floor is enclosed, either partially or fully. In A Zones, the partially or fully enclosed area below the elevated floor is with or without openings* present in the walls of the enclosure. Indicate information about enclosure size and openings in Section A – Property Information.

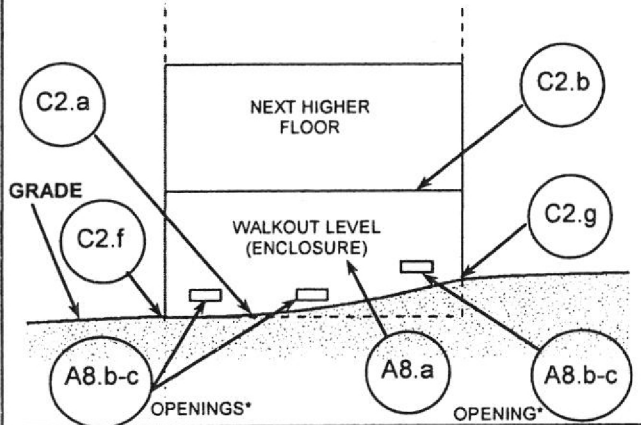

DIAGRAM 8

All buildings elevated on a crawlspace with the floor of the crawlspace at or above grade on at least one side, with or without an attached garage.

Distinguishing Feature – For all zones, the area below the first floor is enclosed by solid or partial perimeter walls. In all A zones, the crawlspace is with or without openings* present in the walls of the crawlspace. Indicate information about crawlspace size and openings in Section A – Property Information.

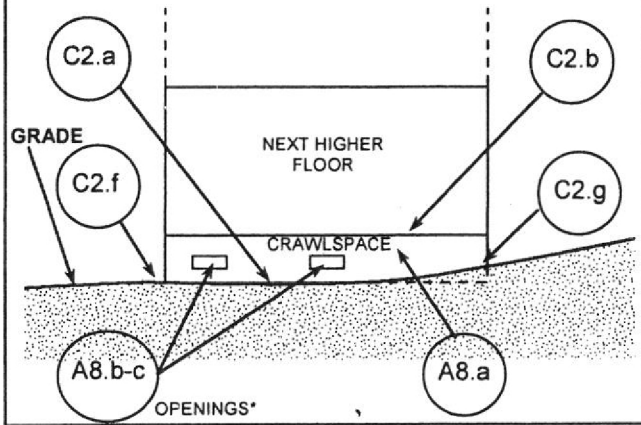
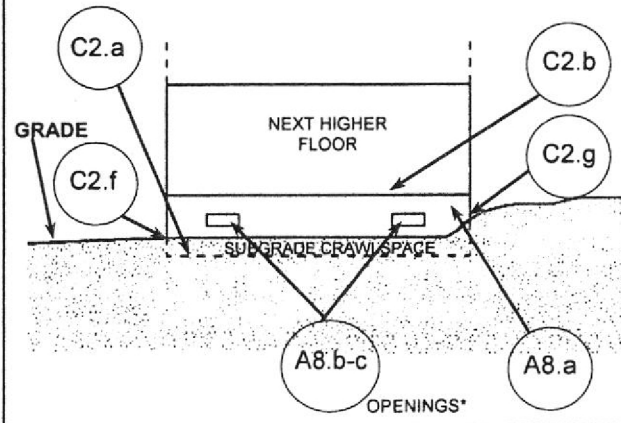

DIAGRAM 9

All buildings (other than split-level) elevated on a sub-grade crawlspace, with or without attached garage.

Distinguishing Feature – The bottom (crawlspace) floor is below ground level (grade) on all sides.** (If the distance from the crawlspace floor to the top of the next higher floor is more than 5 feet, or the crawlspace floor is more than 2 feet below the grade (LAG) on all sides, use Diagram 2.)



* An "opening" is a permanent opening that allows for the free passage of water automatically in both directions without human intervention. Under the NFIP, a minimum of two openings is required for enclosures or crawlspaces. The openings shall provide a total net area of not less than one square inch for every square foot of area enclosed, excluding any bars, louvers, or other covers of the opening. Alternatively, an Individual Engineered Flood Openings Certification or an Evaluation Report issued by the International Code Council Evaluation Service (ICC ES) must be submitted to document that the design of the openings will allow for the automatic equalization of hydrostatic flood forces on exterior walls. A window, a door, or a garage door is not considered an opening; openings may be installed in doors. Openings shall be on at least two sides of the enclosed area. If a building has more than one enclosed area, each area must have openings to allow floodwater to directly enter. The bottom of the openings must be no higher than one foot above the higher of the exterior or interior grade or floor immediately below the opening. For more guidance on openings, see NFIP Technical Bulletin 1.

** A floor that is below ground level (grade) on all sides is considered a basement even if the floor is used for living purposes, or as an office, garage, workshop, etc.

TRANSMITTAL FORM

For making submittals, other than formal applications, to:
TOWN OF LONGBOAT KEY
PLANNING ZONING & BUILDING DEPARTMENT

501 Bay Isles Road
Longboat Key, FL 34228

PHONE: 941-316-1966
FAX: 941-316-1970

DATE: 04-16-14 FROM: STEVE MAIGRET
TO ATTN OF: ~~STEVE~~ BELTON Company: PEREGRINE HOMES
STEVE Phone: (941) 232 3283
FAX: _____

SITE LOCATION/ADDRESS: 3309 SABAL COVE CIRCLE

THE FOLLOWING IS SUBMITTED FOR CONSIDERATION BY PZB STAFF:

- Response To Application Plan Review Dated: _____
 Permit #: 29446 Change Order Request Other Information (explain below)
 OTHER: ELEVATION CERTIFICATE, FINAL SURVEY

ATTACHMENTS: # _____ sets of plans containing pages # _____
Other: _____

APPLICABLE CODES / TRADES (Check All That Apply):

- | | | | |
|--|--------------------------------------|-------------------------------------|---------------------------------------|
| <input type="checkbox"/> BUILDING / FEMA | <input type="checkbox"/> ELECTRICAL | <input type="checkbox"/> HVAC | <input type="checkbox"/> PLUMBING |
| <input type="checkbox"/> ZONING | <input type="checkbox"/> GAS VENTING | <input type="checkbox"/> GAS PIPING | <input type="checkbox"/> FIRE MARSHAL |

ADDITIONAL DIRECTION / COMMENTS TO STAFF REGARDING THIS TRANSMITTAL:

looking for C.O.
Return to Marie
Thanks

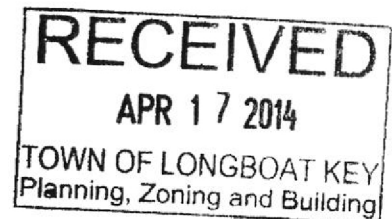

PZB USE ONLY: COMMENTS/APPROVALS

OK B.F.E. 11' NGVD
D.F.E. 12' NGVD
F.F.E. 13.2' NGVD

Staff signature: Belton S. well

Date: 4.18.14